

COMMUNICATORS

Interlogix NX-8v2 with GT/GT+/GET quick setup



GT product image

GT



GT+ product image

GT+



GET product image

GET

Short wiring and programming steps to connect the GT/GT+/GET communicator to Interlogix NX-8v2 panel using KeyBus, then enroll the system in Protegus2. Use this alongside the full manuals for all other settings. (Terminal labels differ slightly between GT/GT+/GET, but the connections are the same.)



CAUTION

Install and service only by qualified personnel. Disconnect power before wiring. Unauthorized changes void warranty.

1. Prerequisites

1. GT/GT+/GET firmware 1.21, SIM inserted, PIN disabled, data plan active.
2. Interlogix NX-8v2 panel with keypad access (installer code available).
3. CMS account number if reporting to CMS.
4. Protegus2 company/installer account and communicator IMEI.

2. Wiring

Cookie consent

We use cookies to measure the effectiveness of our documentation and whether users find what they're searching for. With your consent, you're helping us to make our documentation better.



Google Analytics

Accept

Reject

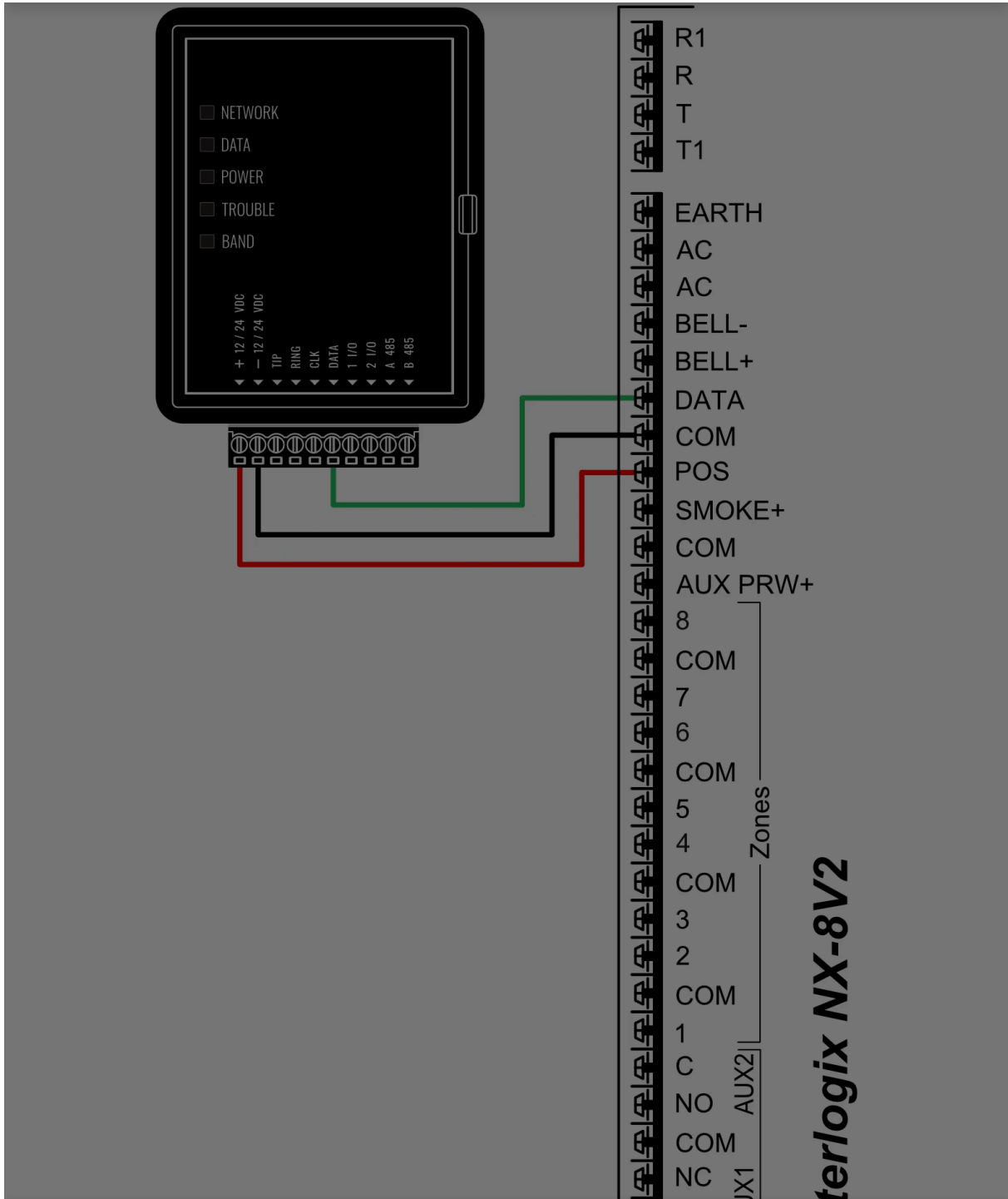

Cookie consent

We use cookies to measure the effectiveness of our documentation and whether users find what they're searching for. With your consent, you're helping us to make our documentation better.

- Google Analytics



| LCD keypad | Keypad Entry | Action Description |
|----------------------|--------------|--|
| System ready | *89713 | Enter programming mode |
| Enter device address | 0# | To go to main panel programming menu |
| Enter location | 4# | To go to "Phone1 events reported" toggle menu |
| Loc#4 Seg#1 | 12345678* | All toggle options should be enabled. * to save and go to next menu |
| Loc#4 Seg#2 | 12345678* | All toggle options should be enabled. * to save and go back. |
| Enter location | 23# | To go to "Partition features" menu. |
| Loc#23 Seg#1 | ** | Press * twice to go to section 3 toggle options menu. |
| Loc#23 Seg#3 | 12345678*# | Segment 3. All toggle options should be enabled, press * to save and then # to save and # to go back to the main menu. |
| Enter location | 37# | To go to "Siren and system supervision" menu. |
| Loc#37 Seg#1 | ** | Press * twice to go to segment 3 toggle options menu. |
| Loc#37 Seg#3 | 12345678* | Segment 3. All toggle options should be enabled press * to save. |
| Loc#37 Seg#4 | 12345678*# | Segment 4. All toggle options should be enabled press * to press and then # to save and # to go back to the main menu. |
| Enter location | 90# | To go to "Partition 2 features" menu. |
| Loc#90 Seg#1 | ** | Press * twice to go to section 3 toggle options menu. |
| Loc#90 Seg#3 | 12345678*# | Segment 3. All toggle options should be enabled, press * to save and then # to save and # to go back to the main menu. |
| Enter location | 93# | To go to "Partition 3 features" menu. |
| Loc#93 Seg#1 | ** | Press * twice to go to section 3 |

Cookie consent

We use cookies to measure the effectiveness of our documentation and whether users find what they're searching for. With your consent, you're helping us to make our documentation better.

Google Analytics



| LCD keypad | Keypad Entry | Action Description |
|----------------|--------------|--|
| Loc#96 Seg#3 | 12345678*# | Segment 3. All toggle options should be enabled, press * to save and then # to save and # to go back to the main menu. |
| Enter location | 99# | To go to "Partition 5 features" menu. |
| Loc#99 Seg#1 | ** | Press * twice to go to section 3 toggle options menu. |
| Loc#99 Seg#3 | 12345678*# | Segment 3. All toggle options should be enabled, press * to save and then # to save and # to go back to the main menu. |
| Enter location | 102# | To go to "Partition 6 features" menu. |
| Loc#102 Seg#1 | ** | Press * twice to go to section 3 toggle options menu. |
| Loc#102 Seg#3 | 12345678*# | Segment 3. All toggle options should be enabled, press * to save and then # to save and # to go back to the main menu. |
| Enter location | 105# | To go to "Partition 7 features" menu. |
| Loc#105 Seg#1 | ** | Press * twice to go to section 3 toggle options menu. |
| Loc#105 Seg#3 | 12345678*# | Segment 3. All toggle options should be enabled, press * to save and then # to save and # to go back to the main menu. |
| Enter location | 108# | To go to "Partition 8 features" menu. |
| Loc#108 Seg#1 | ** | Press * twice to go to section 3 toggle options menu. |
| Loc#108 Seg#3 | 12345678*# | Segment 3. All toggle options should be enabled, press * to save and then # to save and # to go back to the main menu. |
| Enter location | EXIT EXIT | Press "EXIT" twice to exit programming mode. |

4. Programming the Interlogix NX-8v2 Alarm Panel via the

Cookie consent

We use cookies to measure the effectiveness of our documentation and whether users find what they're searching for. With your consent, you're helping us to make our documentation better.

Google Analytics



| LCD keypad | Keypad Entry | Action Description |
|---|--------------|--|
| LEDs of Ready, Power steady ON | *89713 | Enter programming mode |
| Service LED blinks | 0# | To go to main panel programming menu |
| Service LED blinks, Armed LED steady ON | 4# | To go to "Phone1 events reported" toggle menu |
| All zone LEDs are ON | 12345678* | All toggle options should be enabled. * to save and go to next menu |
| All zone LEDs are ON | 12345678* | All toggle options should be enabled. * to save and go back. |
| Service LED blinks, Armed LED steady ON | 23# | To go to "Partition features and reporting selection" menu. |
| Service LED blinks, Ready LED steady ON | ** | Press * twice to go to section 3 toggle options menu. |
| Service LED blinks, Ready LED steady ON | 12345678*# | Segment 3. All toggle options should be enabled, press * to save and then # to save and # to go back to the main menu. |
| Service LED blinks, Armed LED steady ON | 37# | To go to "Siren and system supervision" menu. |
| Service LED blinks, Ready LED steady ON | ** | Press * twice to go to segment 3 toggle options menu. |
| Service LED blinks, Ready LED steady ON | 12345678* | Segment 3. All toggle options should be enabled press * to save. |
| Service LED blinks, Ready LED steady ON | 12345678*# | Segment 4. All toggle options should be enabled press * to press and then # to save and # to go back to the main menu. |
| Service LED blinks, Armed LED steady ON | 90# | To go to "Partition 2 features" menu. |
| Service LED blinks, Ready LED steady ON | ** | Press * twice to go to section 3 toggle options menu. |
| Service LED blinks, Ready LED steady ON | 12345678*# | Segment 3. All toggle options should be enabled, press * to save and then # to save and # to go back to the main menu. |
| Service LED blinks, Armed LED steady ON | 93# | To go to "Partition 3 features" menu. |

Cookie consent

We use cookies to measure the effectiveness of our documentation and whether users find what they're searching for. With your consent, you're helping us to make our documentation better.

Google Analytics



| LCD keypad | Keypad Entry | Action Description |
|---|--------------|--|
| | | save and then # to save and # to go back to the main menu. |
| Service LED blinks, Armed LED steady ON | 99# | To go to "Partition 5 features" menu. |
| Service LED blinks, Ready LED steady ON | ** | Press * twice to go to section 3 toggle options menu. |
| Service LED blinks, Ready LED steady ON | 12345678*# | Segment 3. All toggle options should be enabled, press * to save and then # to save and # to go back to the main menu. |
| Service LED blinks, Armed LED steady ON | 102# | To go to "Partition 6 features" menu. |
| Service LED blinks, Ready LED steady ON | ** | Press * twice to go to section 3 toggle options menu. |
| Service LED blinks, Ready LED steady ON | 12345678*# | Segment 3. All toggle options should be enabled, press * to save and then # to save and # to go back to the main menu. |
| Service LED blinks, Armed LED steady ON | 105# | To go to "Partition 7 features" menu. |
| Service LED blinks, Ready LED steady ON | ** | Press * twice to go to section 3 toggle options menu. |
| Service LED blinks, Ready LED steady ON | 12345678*# | Segment 3. All toggle options should be enabled, press * to save and then # to save and # to go back to the main menu. |
| Service LED blinks, Armed LED steady ON | 108# | To go to "Partition 8 features" menu. |
| Service LED blinks, Ready LED steady ON | ** | Press * twice to go to section 3 toggle options menu. |
| Service LED blinks, Ready LED steady ON | 12345678*# | Segment 3. All toggle options should be enabled, press * to save and then # to save and # to go back to the main menu. |
| Service LED blinks, Armed LED steady ON | EXIT EXIT | Press "EXIT" twice to exit programming mode. |

5. Add system to Protegus2

Cookie consent

We use cookies to measure the effectiveness of our documentation and whether users find what they're searching for. With your consent, you're helping us to make our documentation better.

Google Analytics

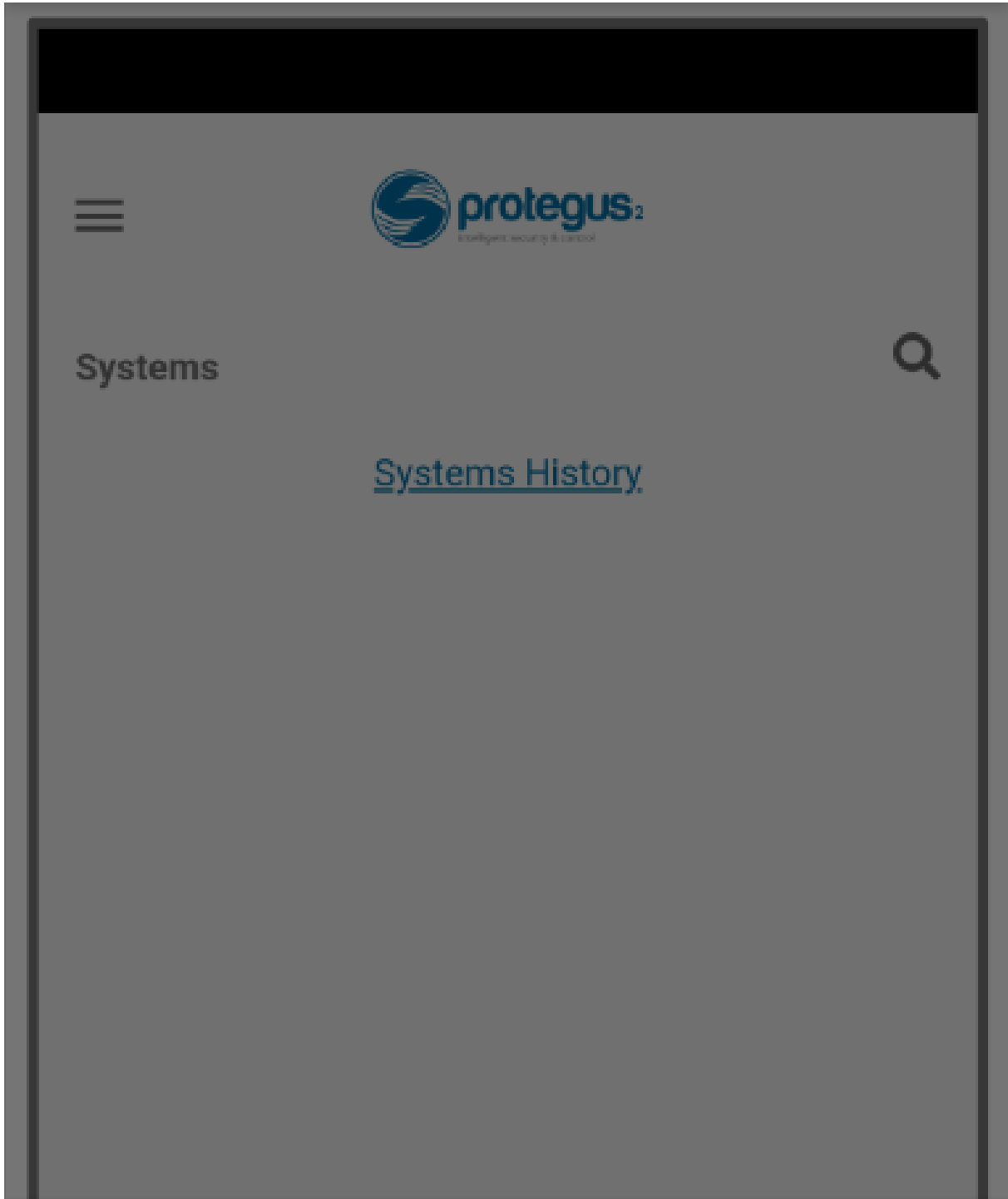

Cookie consent

We use cookies to measure the effectiveness of our documentation and whether users find what they're searching for. With your consent, you're helping us to make our documentation better.

- Google Analytics





Step 2. Enter the communicator **IMEI**, tap **Next**.

Cookie consent

We use cookies to measure the effectiveness of our documentation and whether users find what they're searching for. With your consent, you're helping us to make our documentation better.

Google Analytics

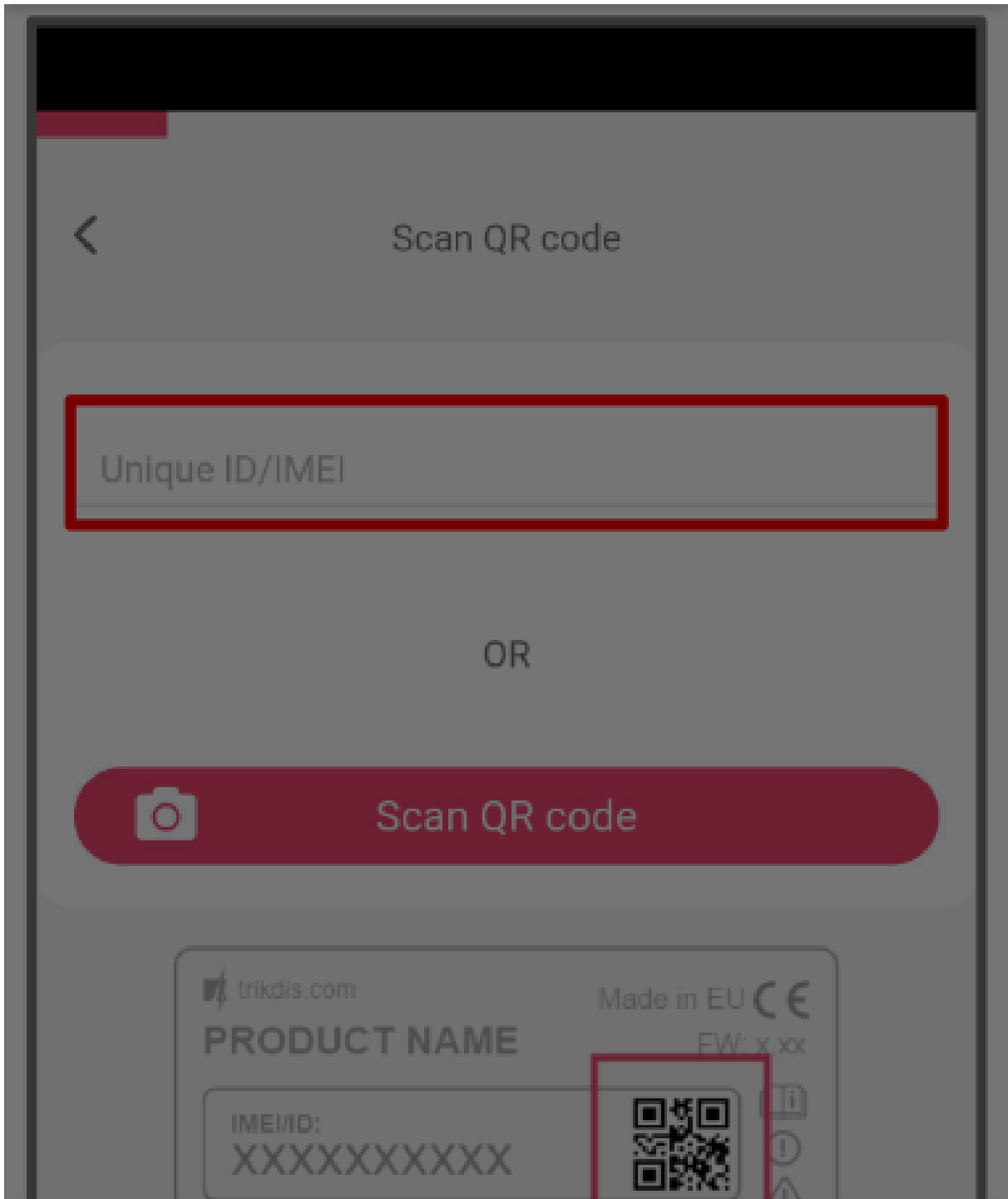

Cookie consent

We use cookies to measure the effectiveness of our documentation and whether users find what they're searching for. With your consent, you're helping us to make our documentation better.

- Google Analytics





Cancel

Next

Step 3. Select security company.

Cookie consent

We use cookies to measure the effectiveness of our documentation and whether users find what they're searching for. With your consent, you're helping us to make our documentation better.

Google Analytics

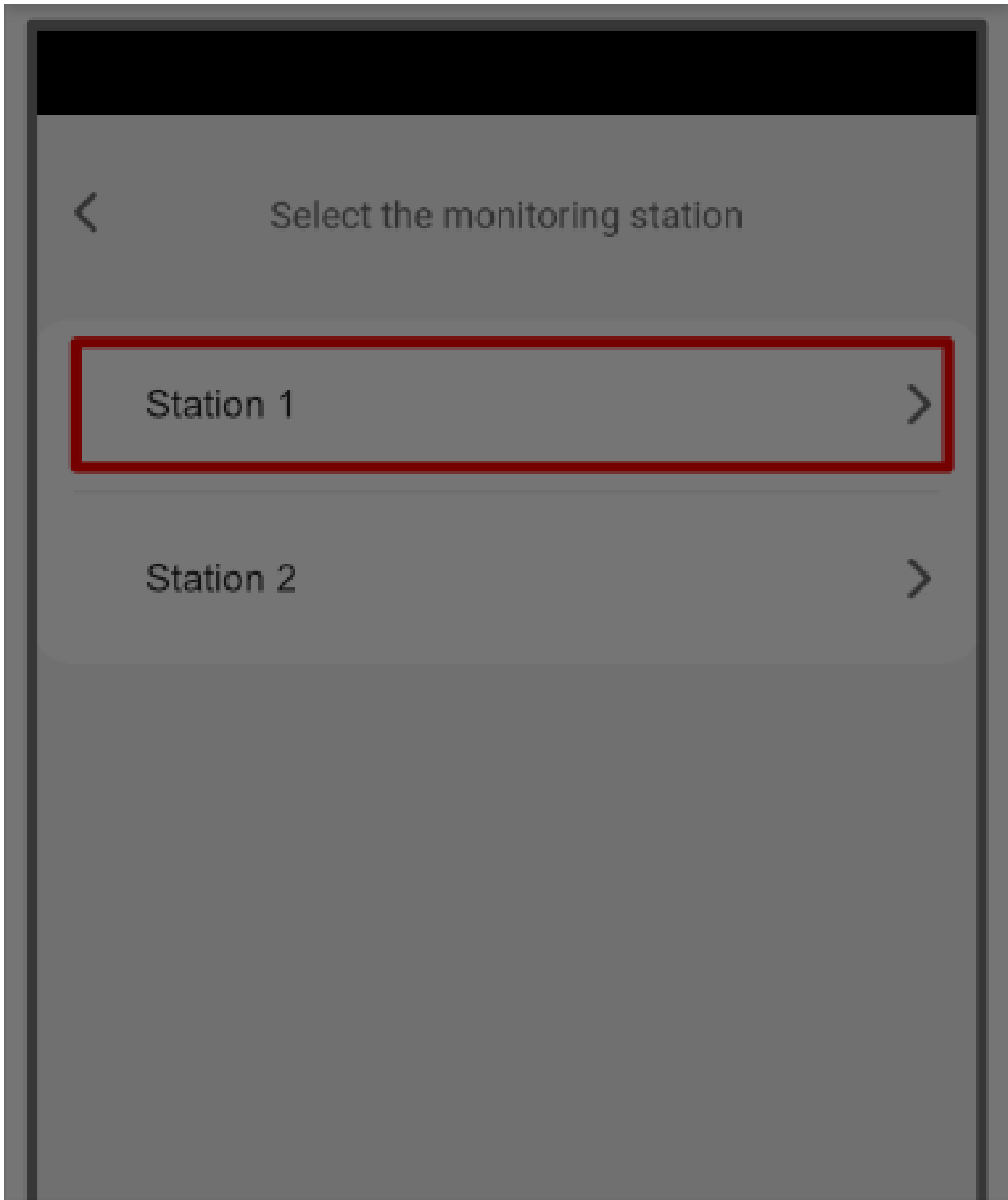

Cookie consent

We use cookies to measure the effectiveness of our documentation and whether users find what they're searching for. With your consent, you're helping us to make our documentation better.

Google Analytics



Cancel

Add only to Protegus2

Step 4. Choose **Interlogix**.

Cookie consent

We use cookies to measure the effectiveness of our documentation and whether users find what they're searching for. With your consent, you're helping us to make our documentation better.

Google Analytics



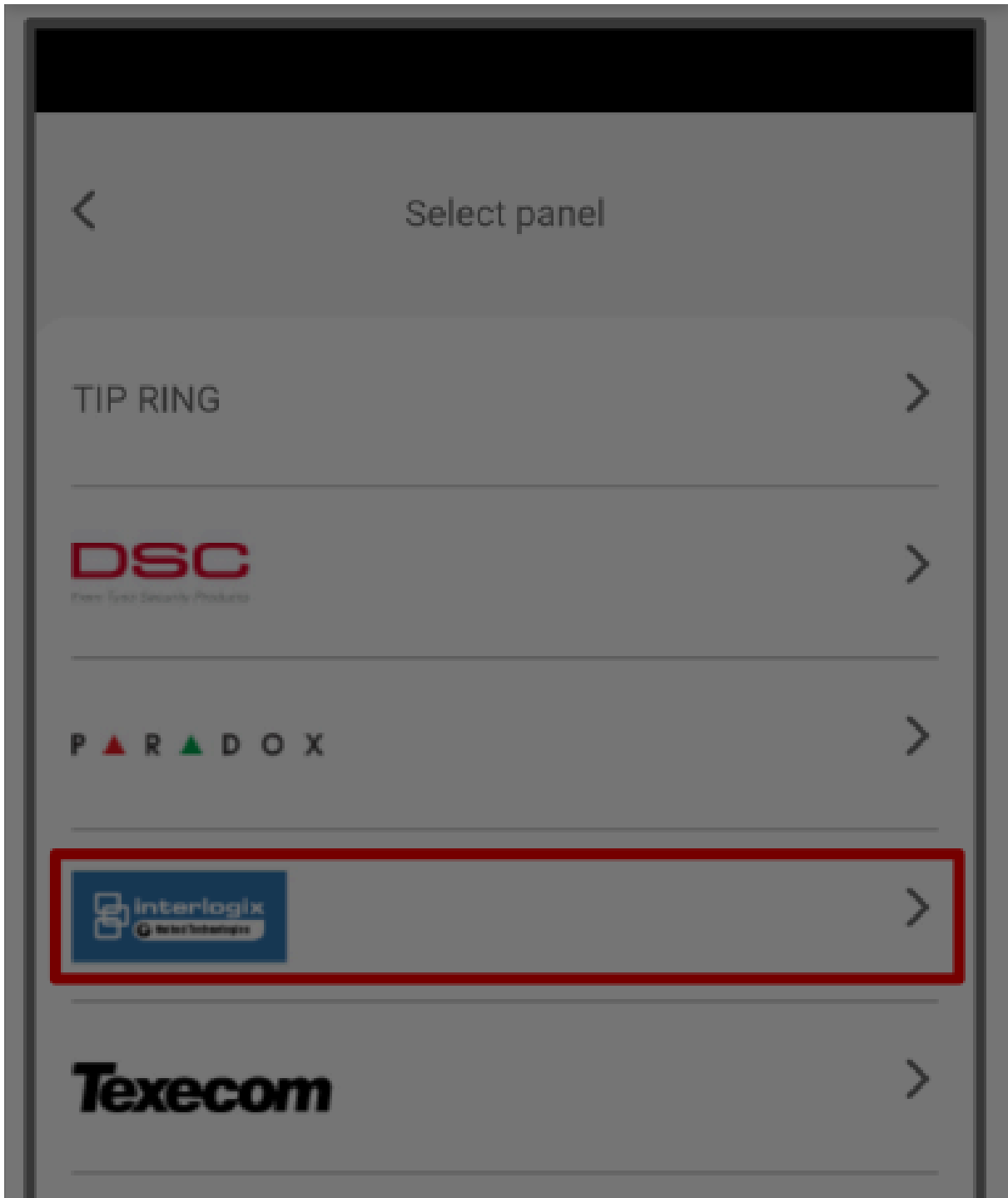

Cookie consent

We use cookies to measure the effectiveness of our documentation and whether users find what they're searching for. With your consent, you're helping us to make our documentation better.

Google Analytics





Cancel

Step 5. Choose NX-8.

Cookie consent

We use cookies to measure the effectiveness of our documentation and whether users find what they're searching for. With your consent, you're helping us to make our documentation better.

Google Analytics



Cookie consent

We use cookies to measure the effectiveness of our documentation and whether users find what they're searching for. With your consent, you're helping us to make our documentation better.

Google Analytics





Cancel

Step 6. Enter **Object ID** and **Module ID**, tap **Next**.

Cookie consent

We use cookies to measure the effectiveness of our documentation and whether users find what they're searching for. With your consent, you're helping us to make our documentation better.

Google Analytics



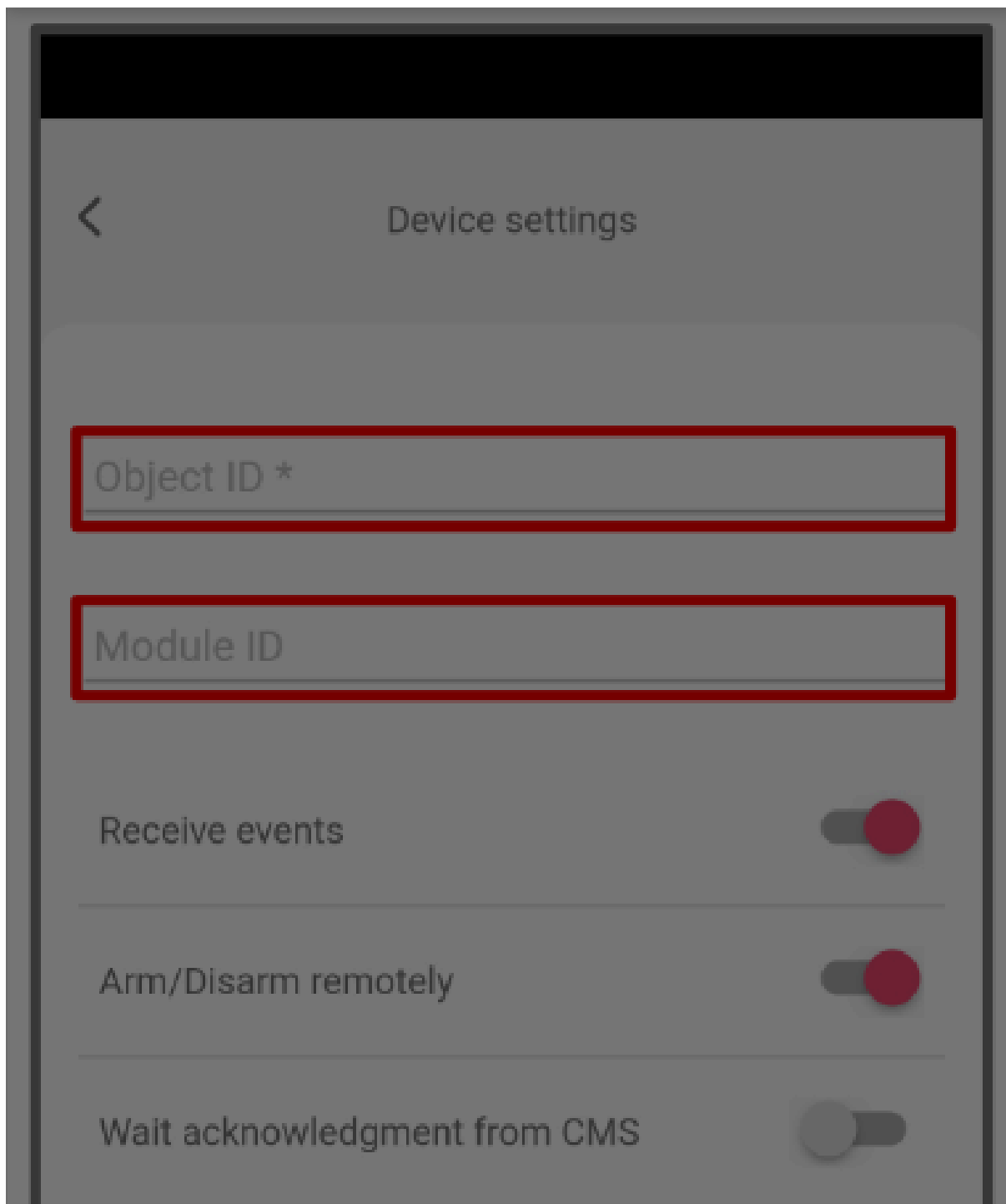

Cookie consent

We use cookies to measure the effectiveness of our documentation and whether users find what they're searching for. With your consent, you're helping us to make our documentation better.

Google Analytics

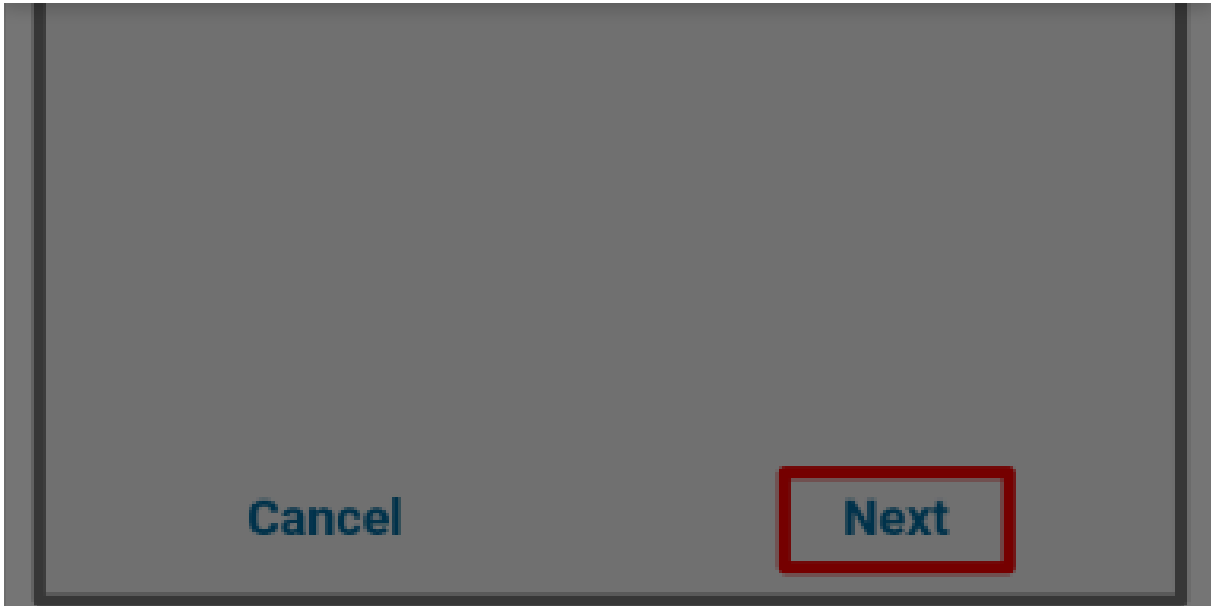

Step 7. Wait while data is written.

Cookie consent

We use cookies to measure the effectiveness of our documentation and whether users find what they're searching for. With your consent, you're helping us to make our documentation better.

Google Analytics

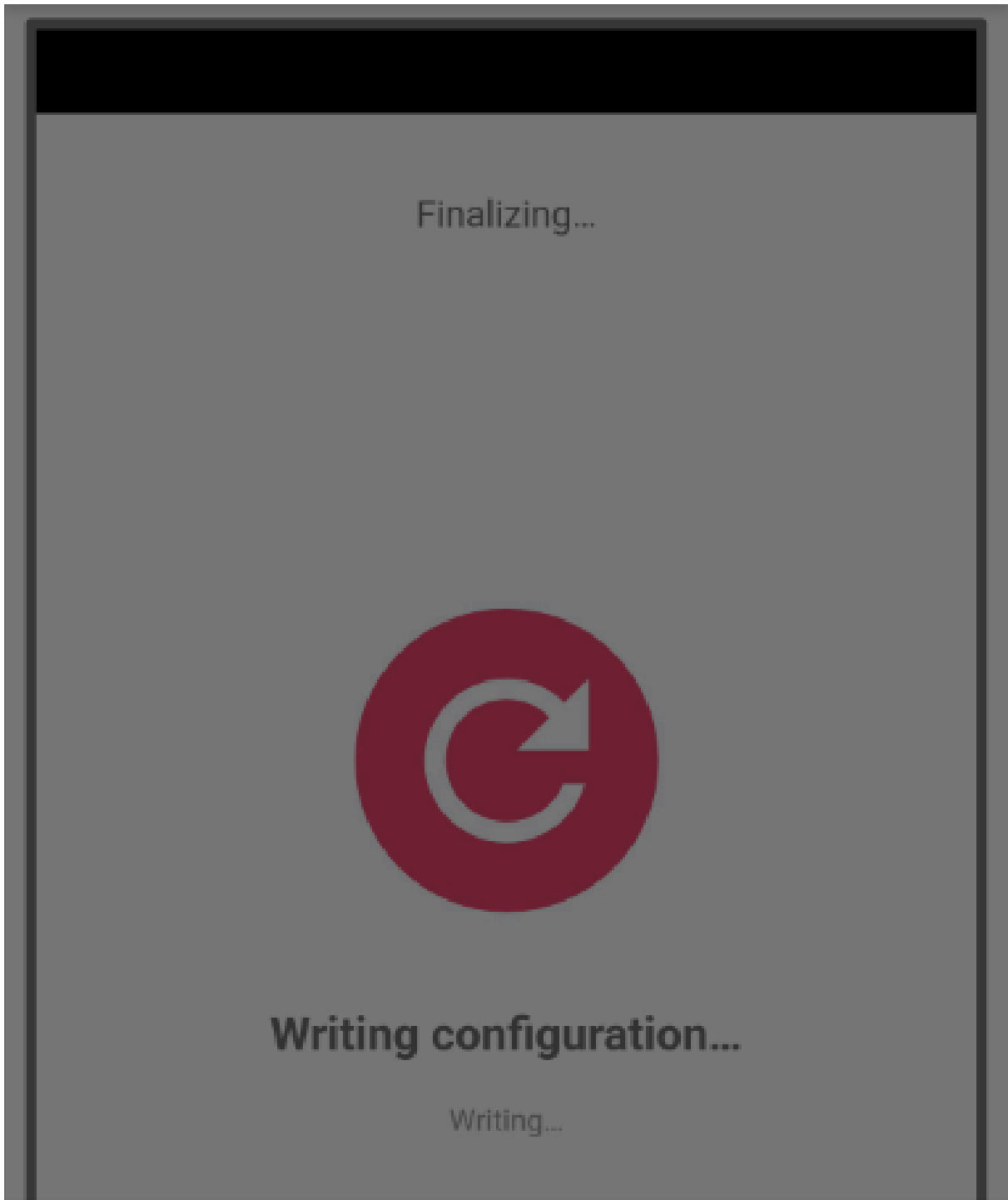

Cookie consent

We use cookies to measure the effectiveness of our documentation and whether users find what they're searching for. With your consent, you're helping us to make our documentation better.

Google Analytics



Cancel

Step 8. Tap Add to Protegus2.

Cookie consent

We use cookies to measure the effectiveness of our documentation and whether users find what they're searching for. With your consent, you're helping us to make our documentation better.

Google Analytics



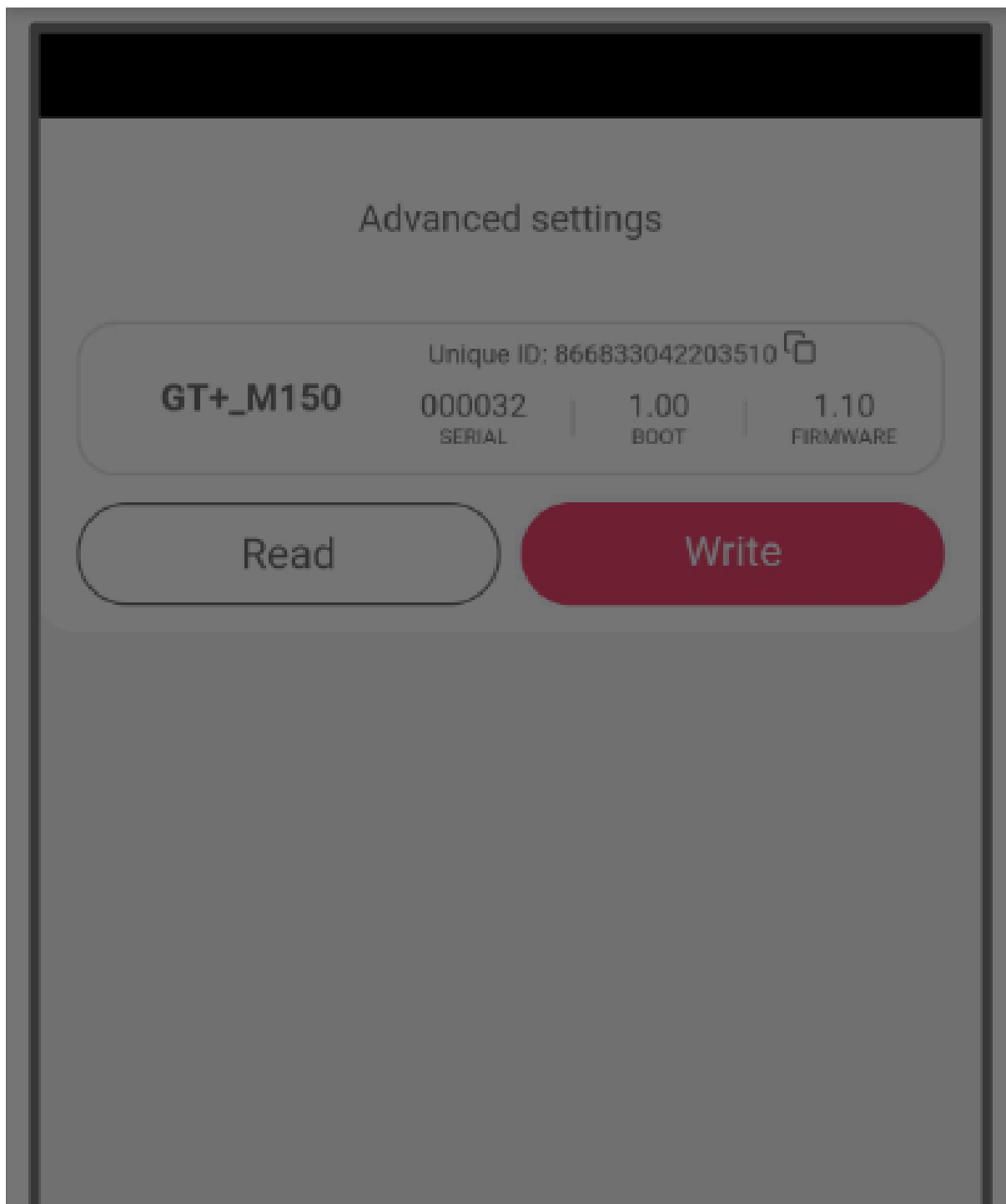

Cookie consent

We use cookies to measure the effectiveness of our documentation and whether users find what they're searching for. With your consent, you're helping us to make our documentation better.

Google Analytics



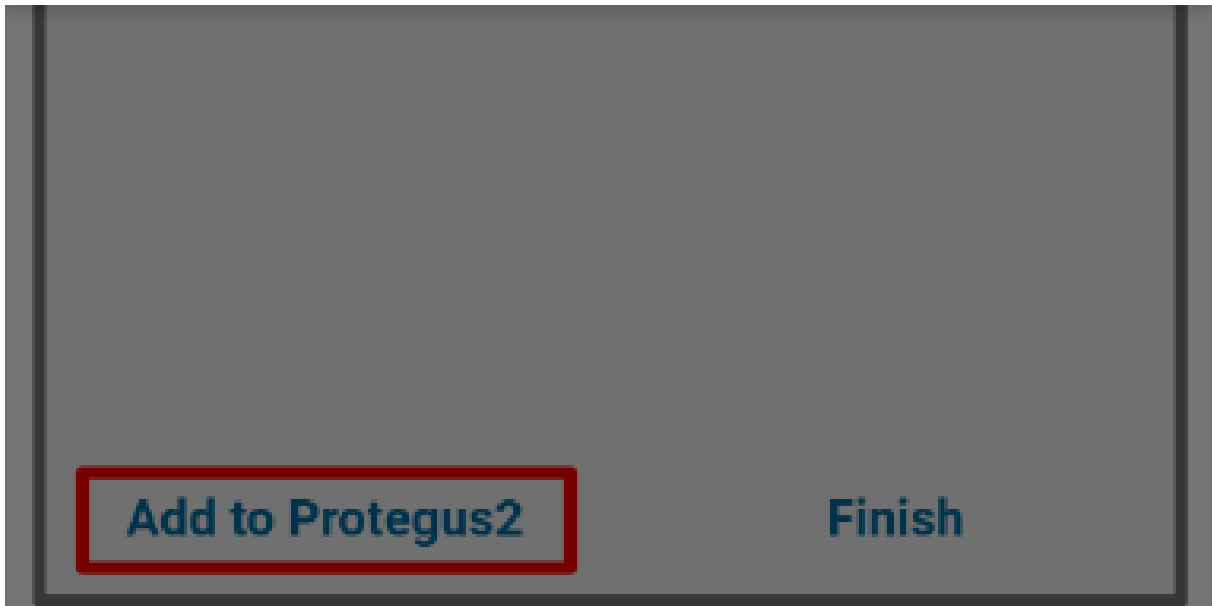

Step 9. Enter system **Name**, tap **Next**.

Cookie consent

We use cookies to measure the effectiveness of our documentation and whether users find what they're searching for. With your consent, you're helping us to make our documentation better.

Google Analytics

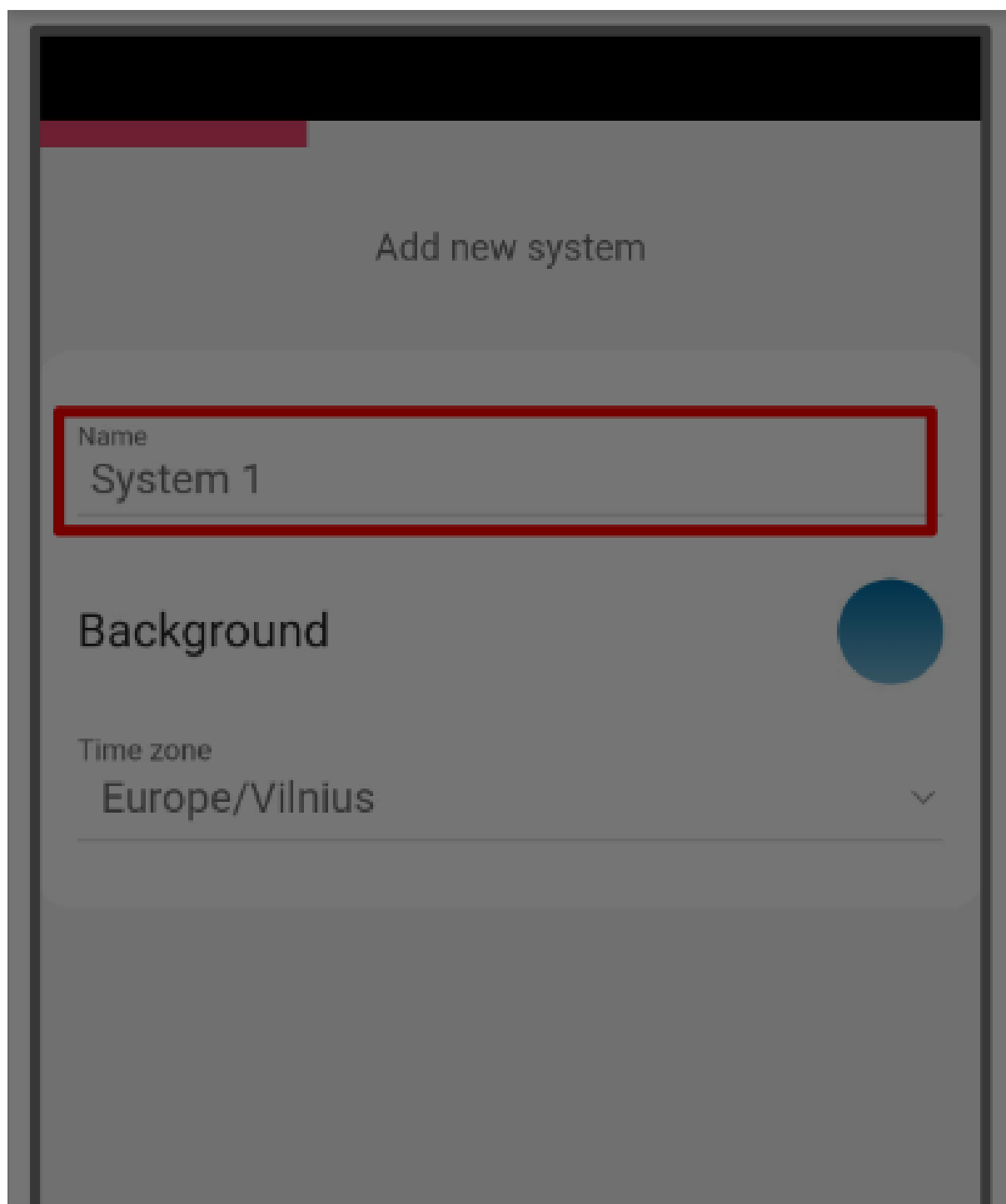

Cookie consent

We use cookies to measure the effectiveness of our documentation and whether users find what they're searching for. With your consent, you're helping us to make our documentation better.

Google Analytics



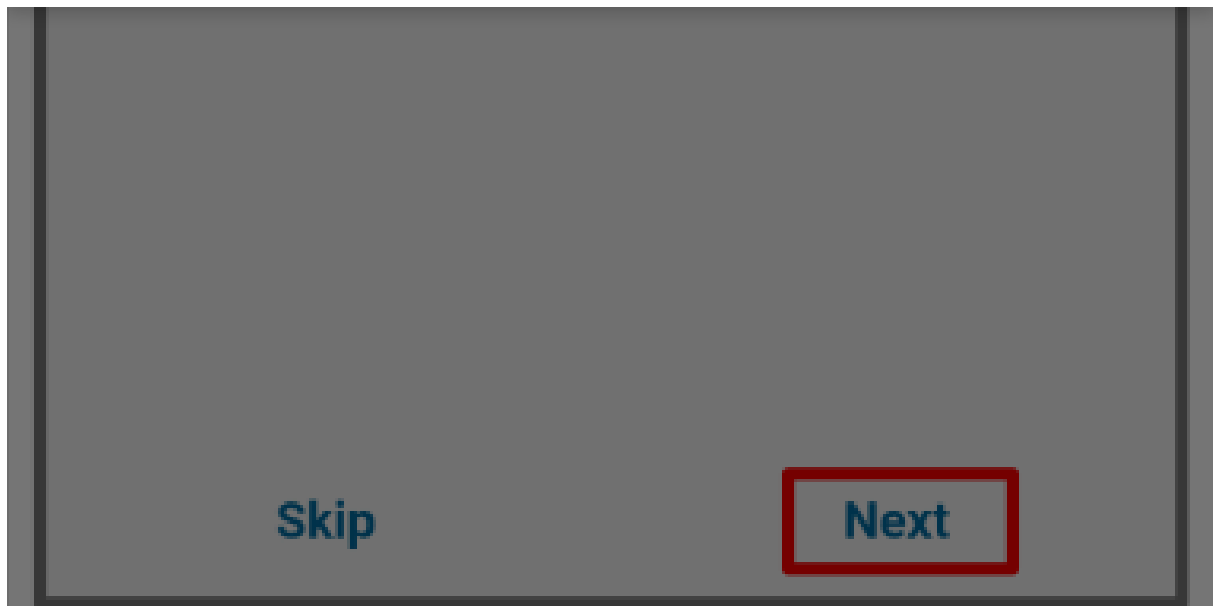

Step 10. Tap **Skip**.

Cookie consent

We use cookies to measure the effectiveness of our documentation and whether users find what they're searching for. With your consent, you're helping us to make our documentation better.

Google Analytics



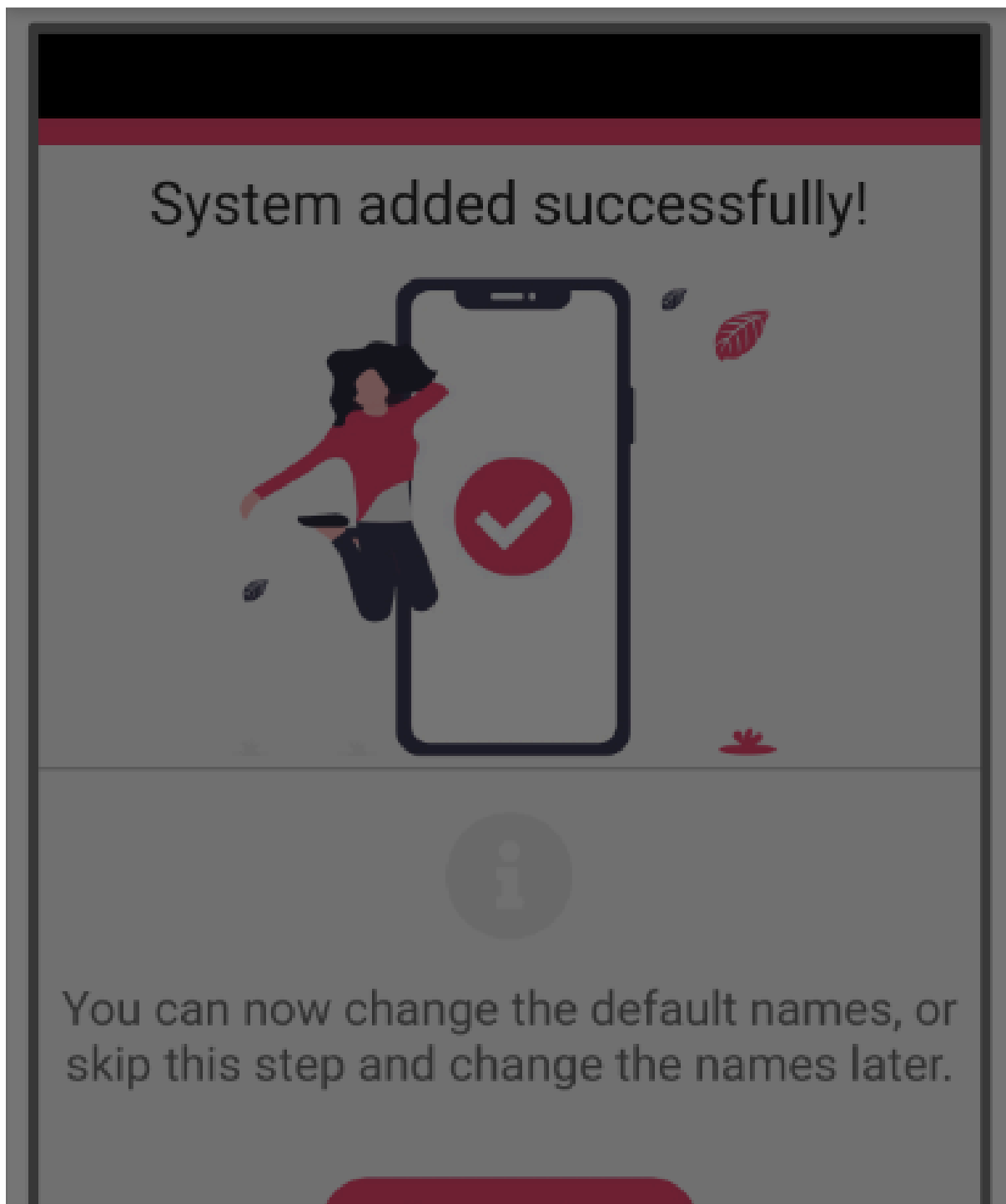

Cookie consent

We use cookies to measure the effectiveness of our documentation and whether users find what they're searching for. With your consent, you're helping us to make our documentation better.

Google Analytics

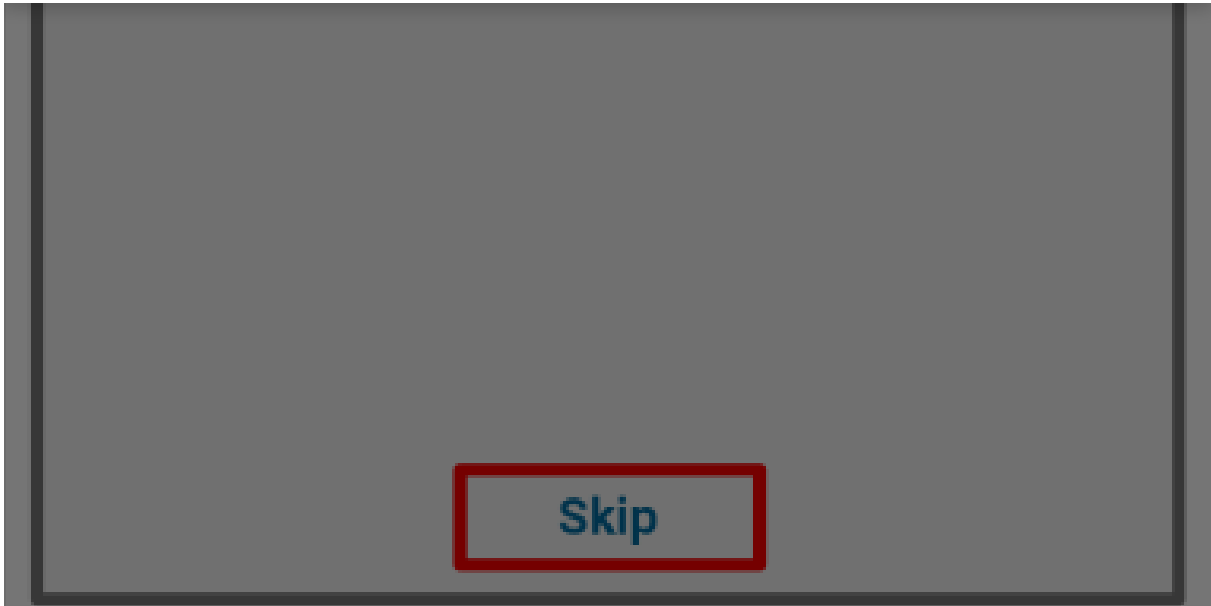

Step 11. Tap on system.

Cookie consent

We use cookies to measure the effectiveness of our documentation and whether users find what they're searching for. With your consent, you're helping us to make our documentation better.

Google Analytics



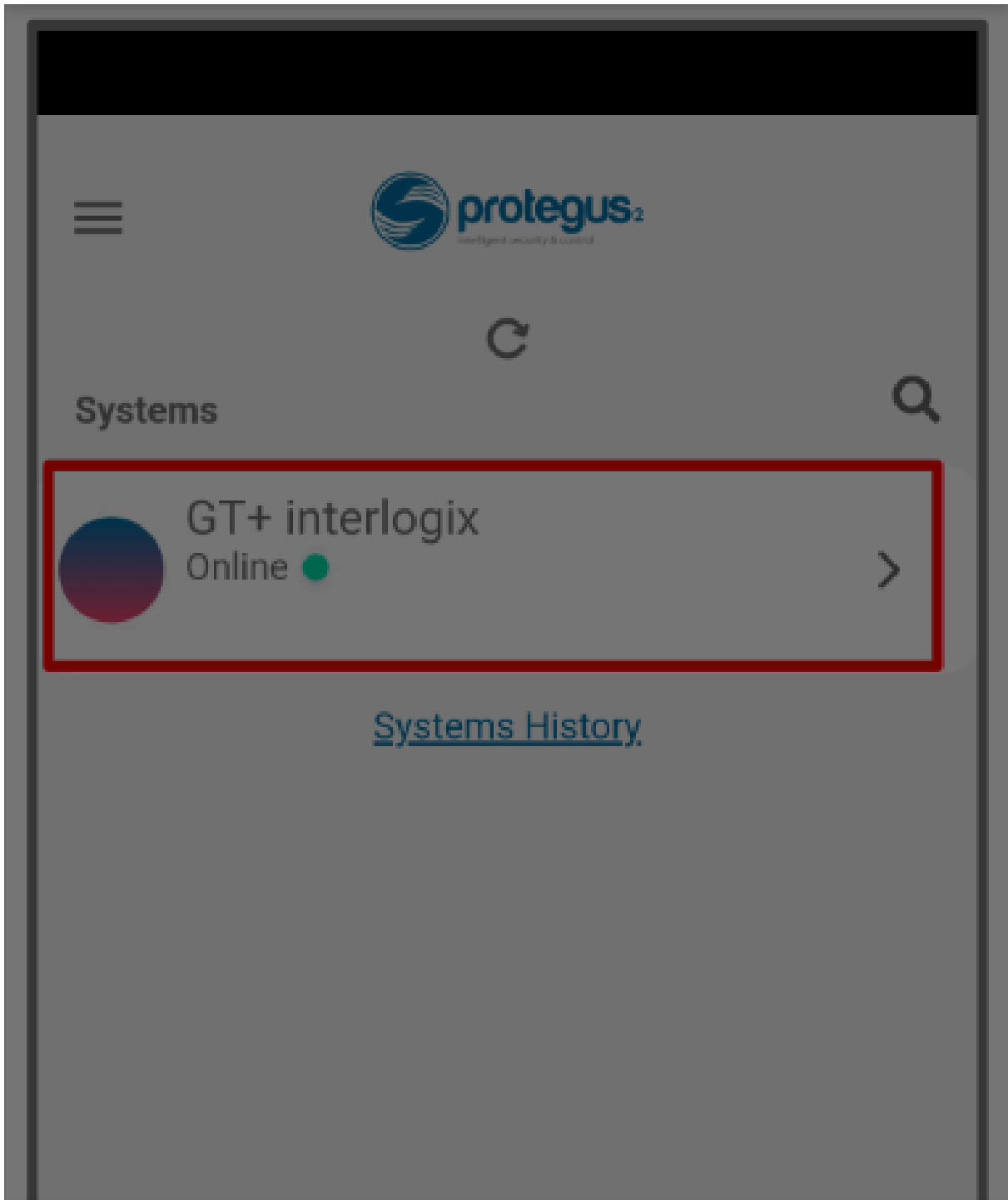

Cookie consent

We use cookies to measure the effectiveness of our documentation and whether users find what they're searching for. With your consent, you're helping us to make our documentation better.

Google Analytics





Step 12. Wait 1 minute for completion and tap **Transfer**.

Cookie consent

We use cookies to measure the effectiveness of our documentation and whether users find what they're searching for. With your consent, you're helping us to make our documentation better.

Google Analytics



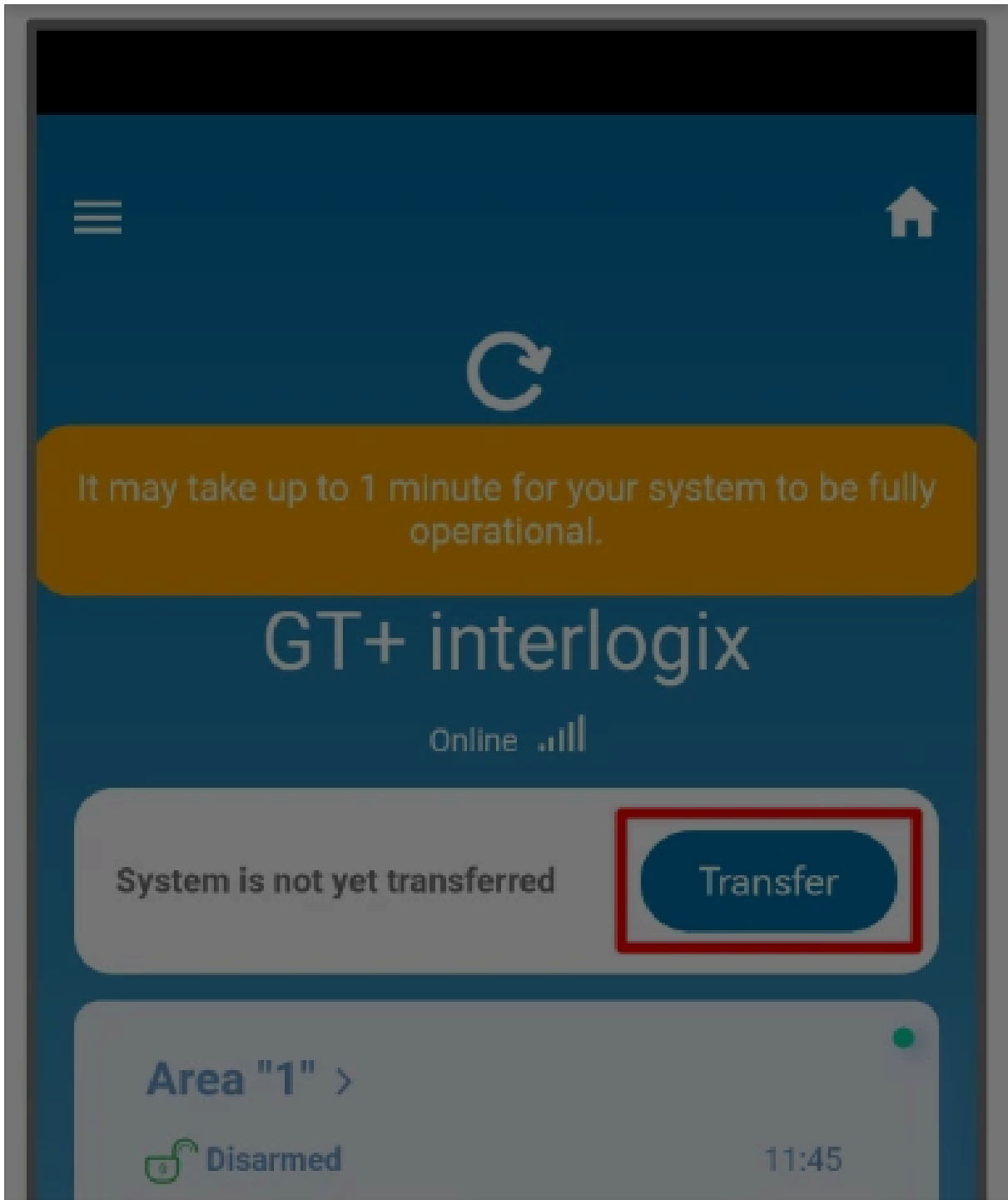

Cookie consent

We use cookies to measure the effectiveness of our documentation and whether users find what they're searching for. With your consent, you're helping us to make our documentation better.

Google Analytics



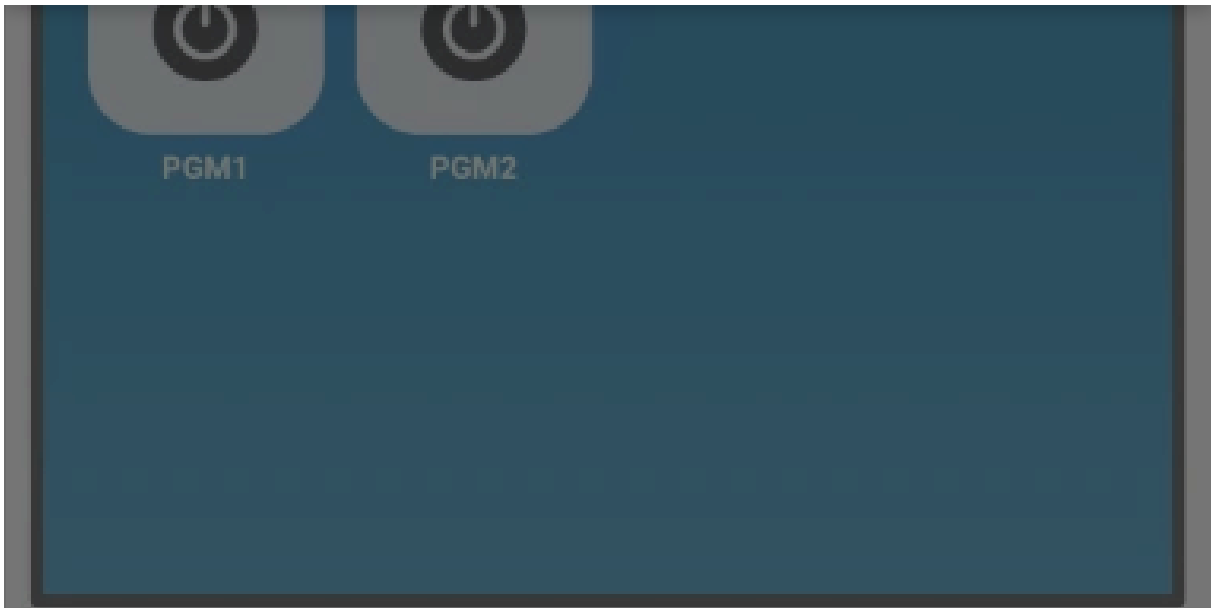

Step 13. Enter the e-mail of the user to whom the installer will transfer the system. Tap **Transfer**.

Cookie consent

We use cookies to measure the effectiveness of our documentation and whether users find what they're searching for. With your consent, you're helping us to make our documentation better.

Google Analytics



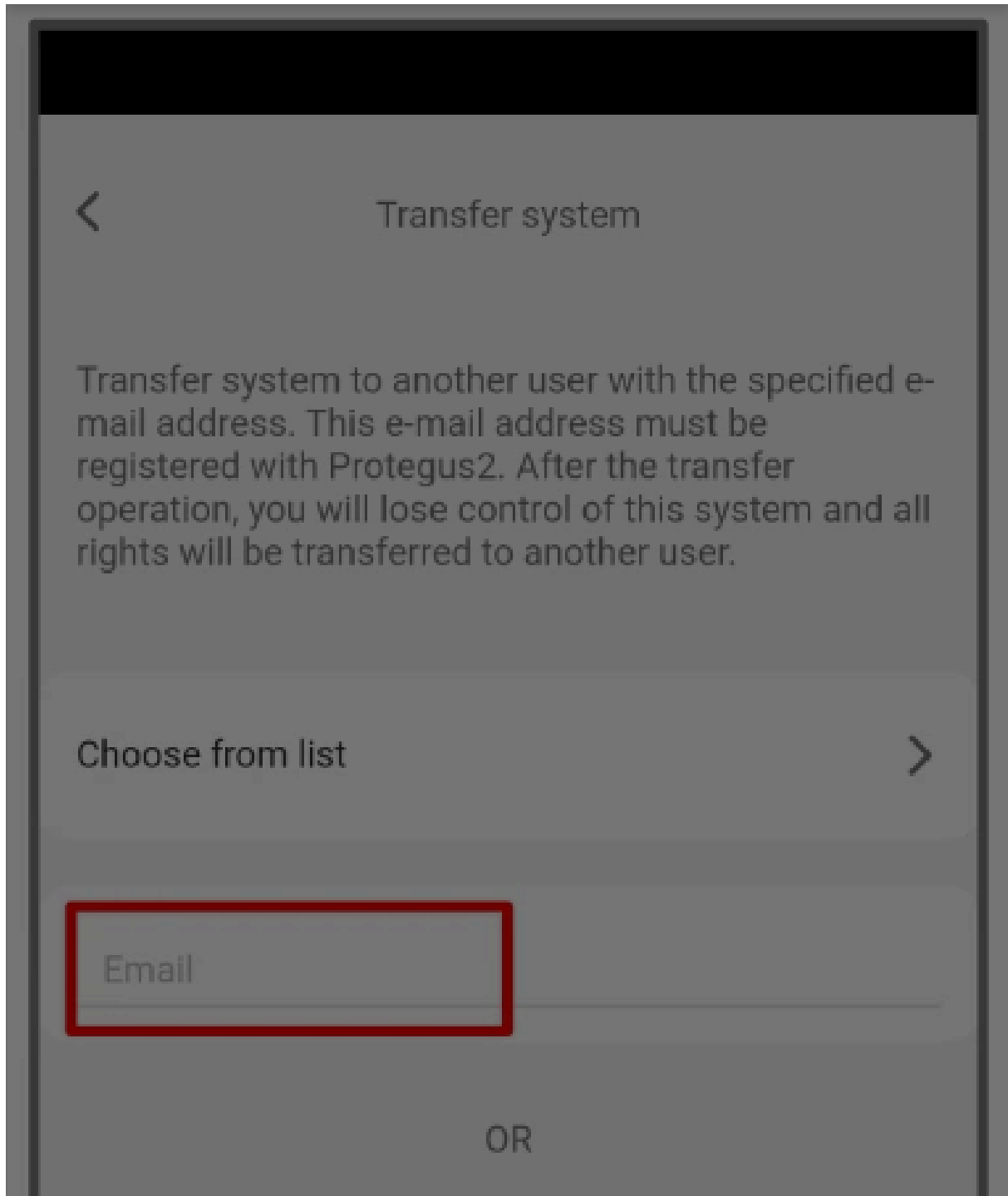

Cookie consent

We use cookies to measure the effectiveness of our documentation and whether users find what they're searching for. With your consent, you're helping us to make our documentation better.

Google Analytics

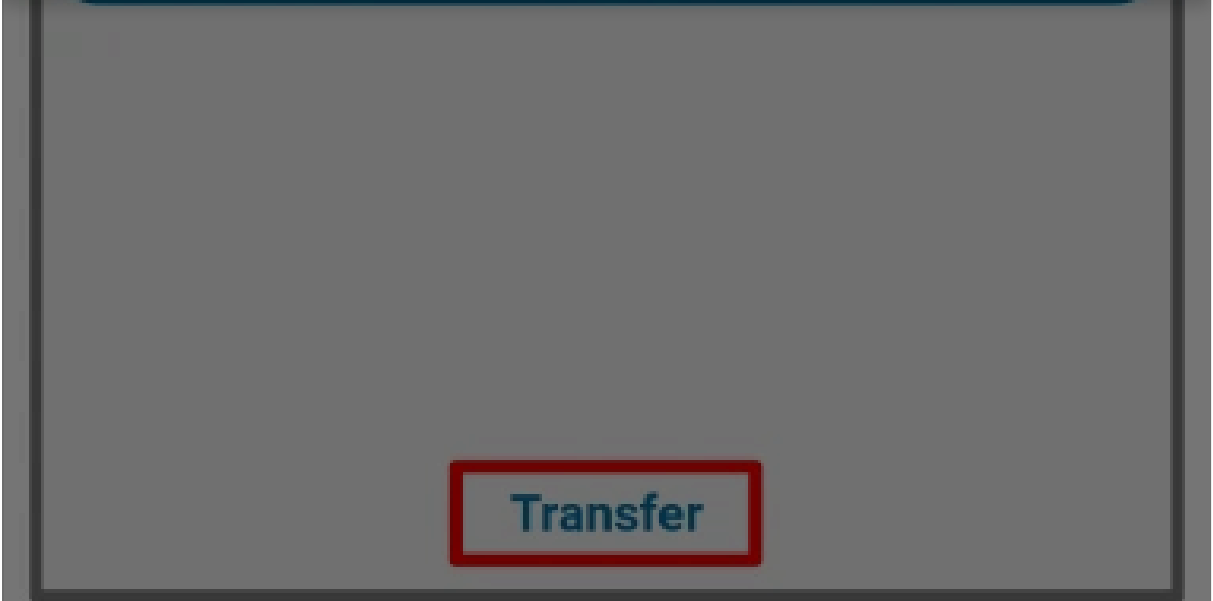

Transfer

Step 14. The system will appear in Protegus on the user's phone.

Cookie consent

We use cookies to measure the effectiveness of our documentation and whether users find what they're searching for. With your consent, you're helping us to make our documentation better.

Google Analytics

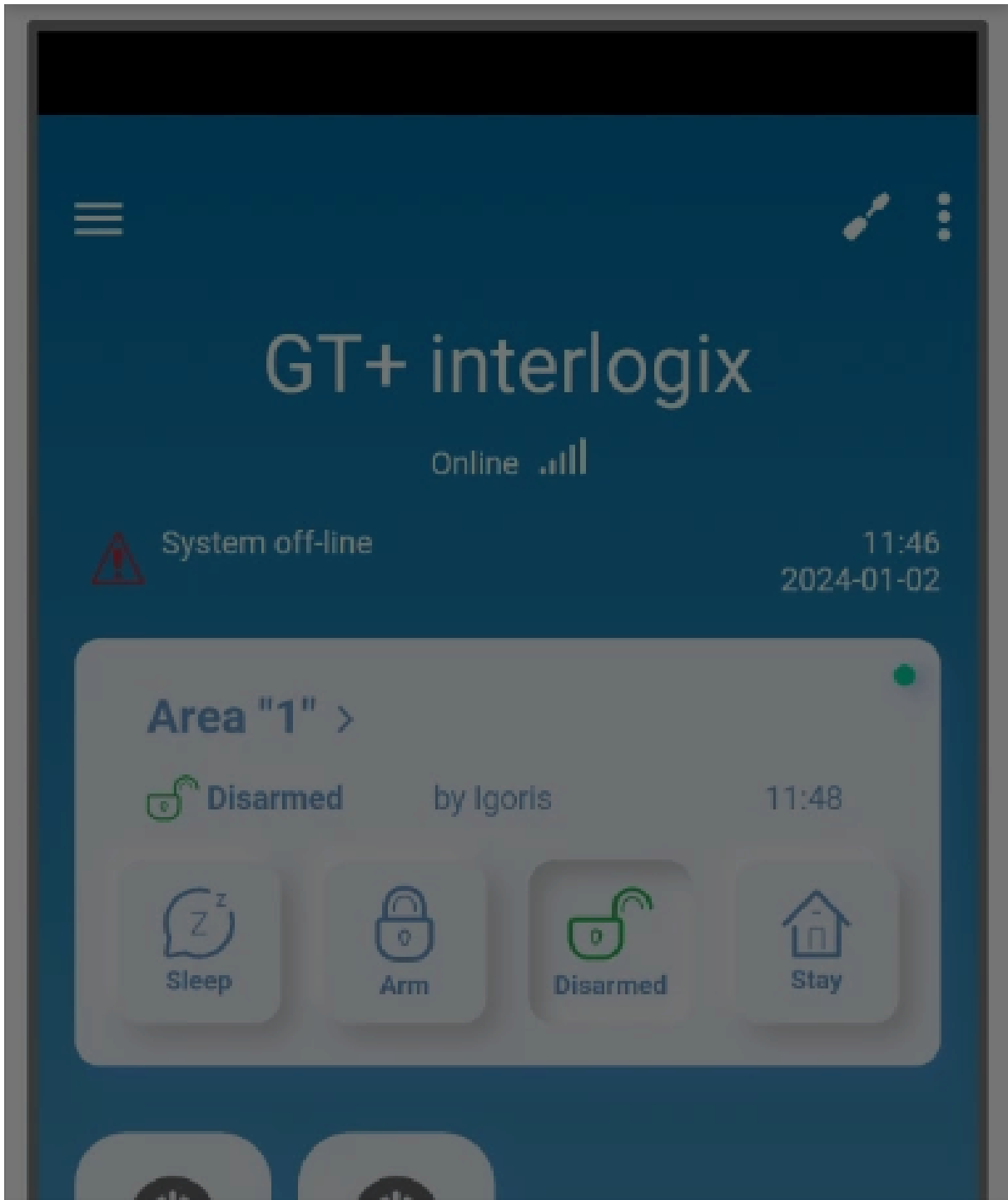

Cookie consent

We use cookies to measure the effectiveness of our documentation and whether users find what they're searching for. With your consent, you're helping us to make our documentation better.

Google Analytics



TIP

After completing the setup and installation perform a system check:

1. Create an event:

- by arming/disarming the system with the control panel's keypad.
- by triggering a zone alarm when the security system is armed.

2. Make sure that the event arrives to the CMS (Central Monitoring Station) and the Protegus2 app.

Cookie consent

We use cookies to measure the effectiveness of our documentation and whether users find what they're searching for. With your consent, you're helping us to make our documentation better.

Google Analytics

