

CONTROL PANELS

Adding S8/S9 wireless sensors to FLEXi SP3



Pair S8 wireless sensors (PIR detectors, door/window magnets, smoke detectors, sirens, remote controls) with the FLEXi SP3 control panel. Choose your configuration method.

IMPORTANT

Firmware requirement: The FLEXi SP3 must run firmware revision 4 (SP3_xxx4_0122 . fw , version 1.22 or later) to support S8 wireless sensors.

Cookie consent

We use cookies to measure the effectiveness of our documentation and whether users find what they're searching for. With your consent, you're helping us to make our documentation better.

Google Analytics

Accept

Reject



- If a sensor was previously paired with any panel, unenroll it first: hold the sensor's **learn button for 5 seconds**, release when the indicator flashes **green three times**.
- Insert batteries into all sensors you intend to pair.
- Keep the RF-S8 transceiver **at least 1 m away** from sensors during pairing.

Protegeus mobile

Protegeus web

TrikdisConfig

The Protegeus app must be installed on your phone and the SP3 system already added to your account.

1. Open the Protegeus app and select the **SP3 kit** system. Tap  in the top-right corner.

Cookie consent

We use cookies to measure the effectiveness of our documentation and whether users find what they're searching for. With your consent, you're helping us to make our documentation better.

- Google Analytics

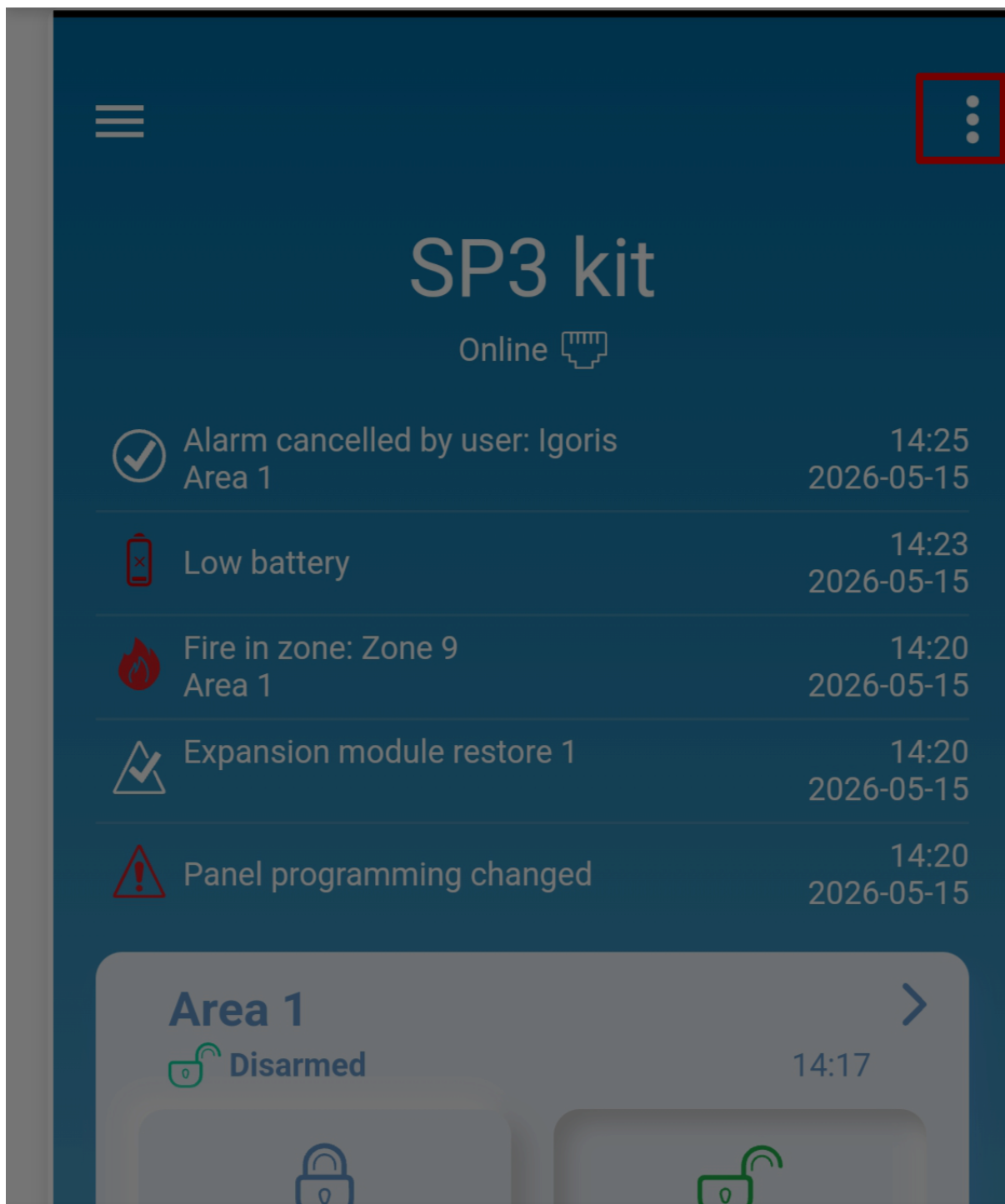

Cookie consent

We use cookies to measure the effectiveness of our documentation and whether users find what they're searching for. With your consent, you're helping us to make our documentation better.

Google Analytics



2. Tap **System configuration**.



Cookie consent

We use cookies to measure the effectiveness of our documentation and whether users find what they're searching for. With your consent, you're helping us to make our documentation better.

Google Analytics



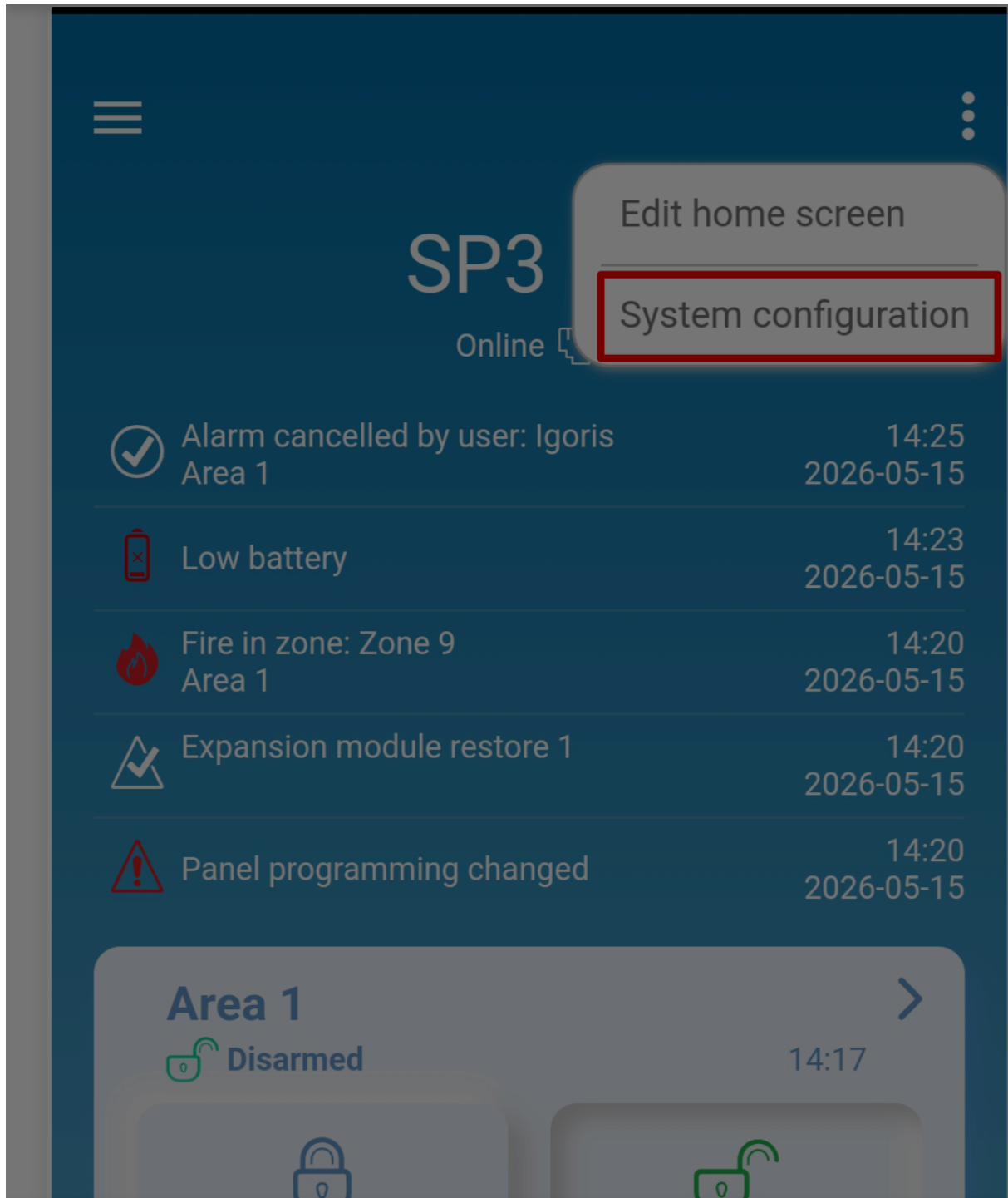

Cookie consent

We use cookies to measure the effectiveness of our documentation and whether users find what they're searching for. With your consent, you're helping us to make our documentation better.

Google Analytics



3. Tap **Devices**.

Cookie consent

We use cookies to measure the effectiveness of our documentation and whether users find what they're searching for. With your consent, you're helping us to make our documentation better.

Google Analytics

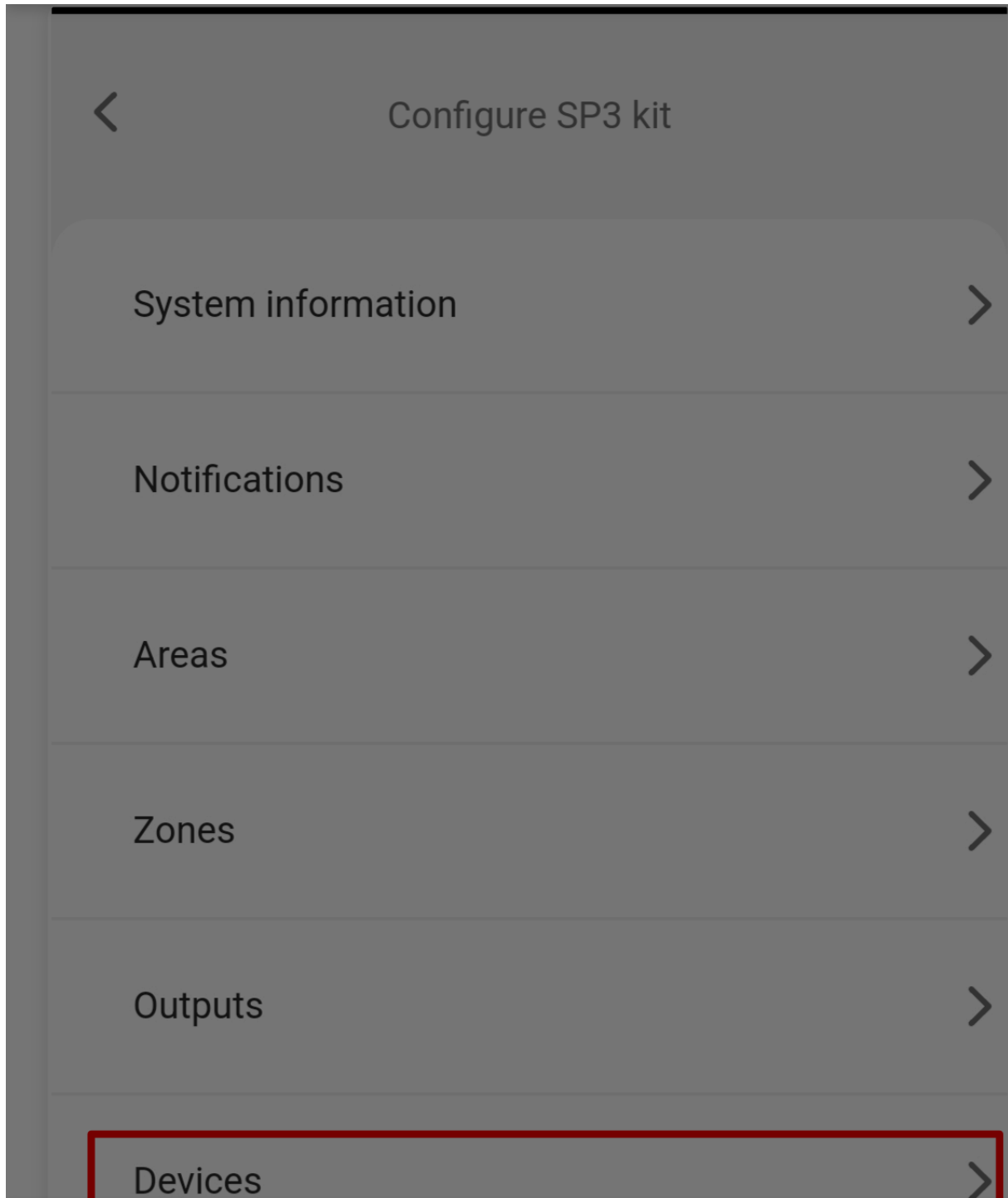

Cookie consent

We use cookies to measure the effectiveness of our documentation and whether users find what they're searching for. With your consent, you're helping us to make our documentation better.

Google Analytics



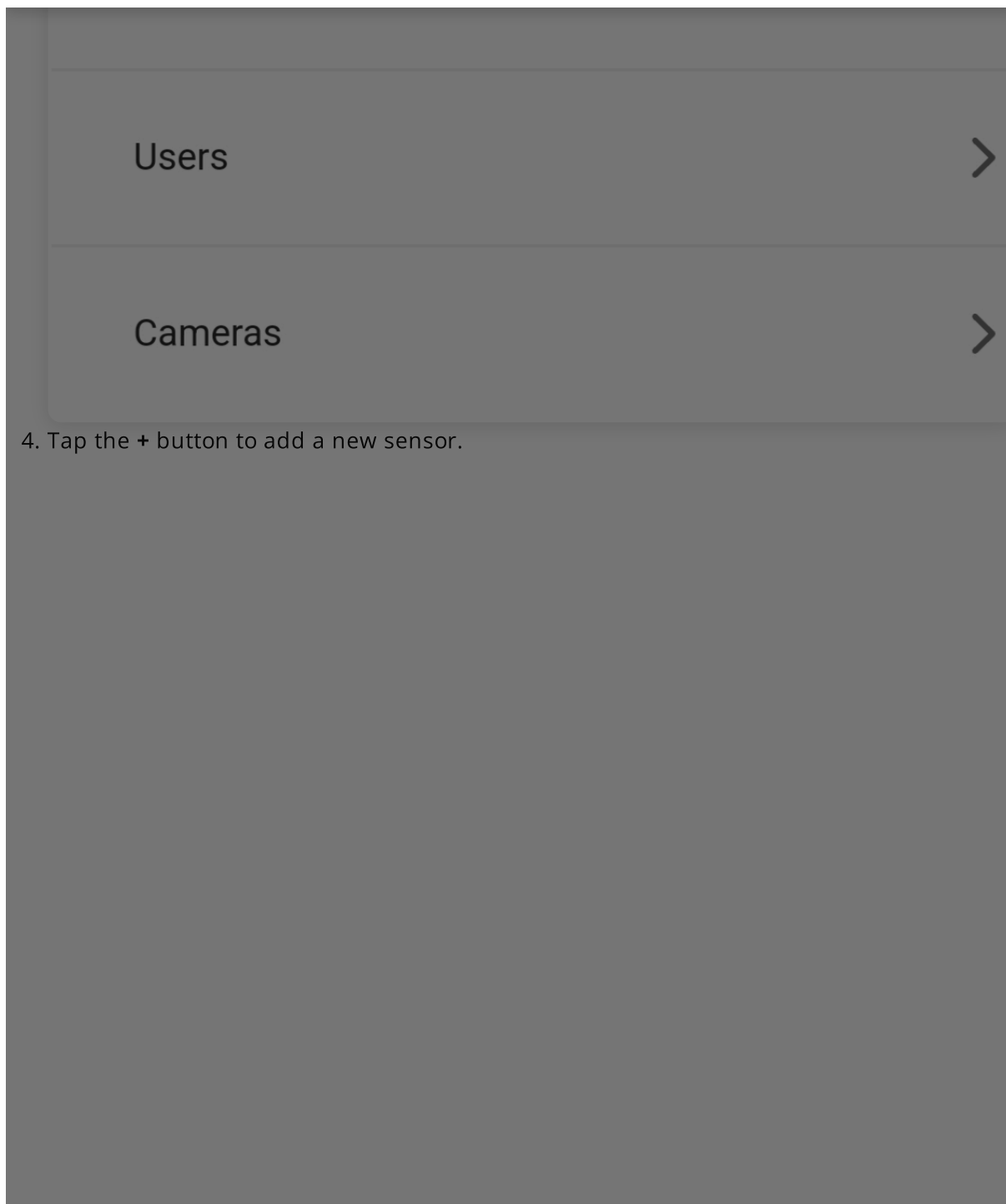

Cookie consent

We use cookies to measure the effectiveness of our documentation and whether users find what they're searching for. With your consent, you're helping us to make our documentation better.

Google Analytics

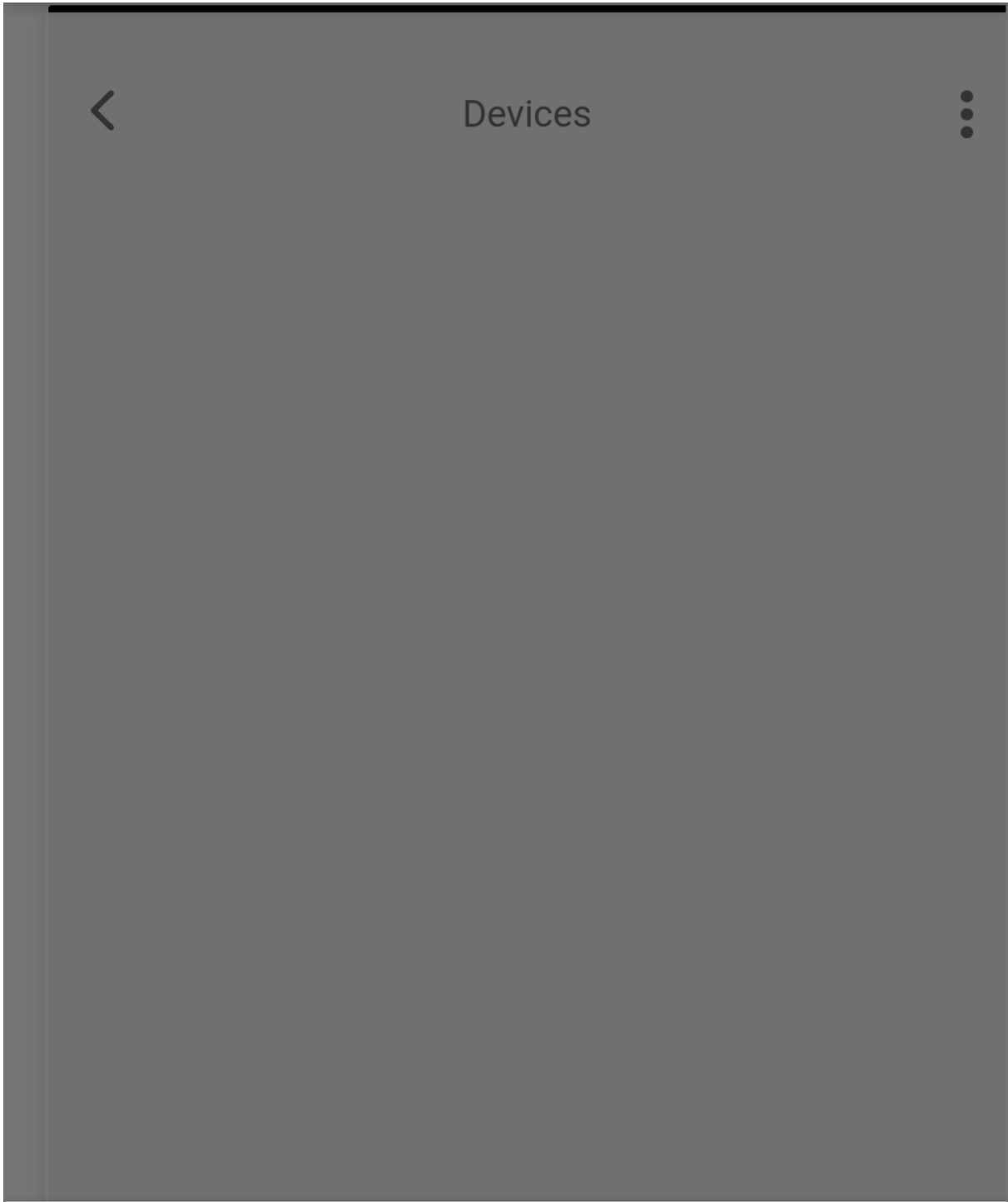

Cookie consent

We use cookies to measure the effectiveness of our documentation and whether users find what they're searching for. With your consent, you're helping us to make our documentation better.

Google Analytics





5. Select the sensor type you want to pair (e.g. **Smart PET PIR detector**).

Cookie consent

We use cookies to measure the effectiveness of our documentation and whether users find what they're searching for. With your consent, you're helping us to make our documentation better.

Google Analytics

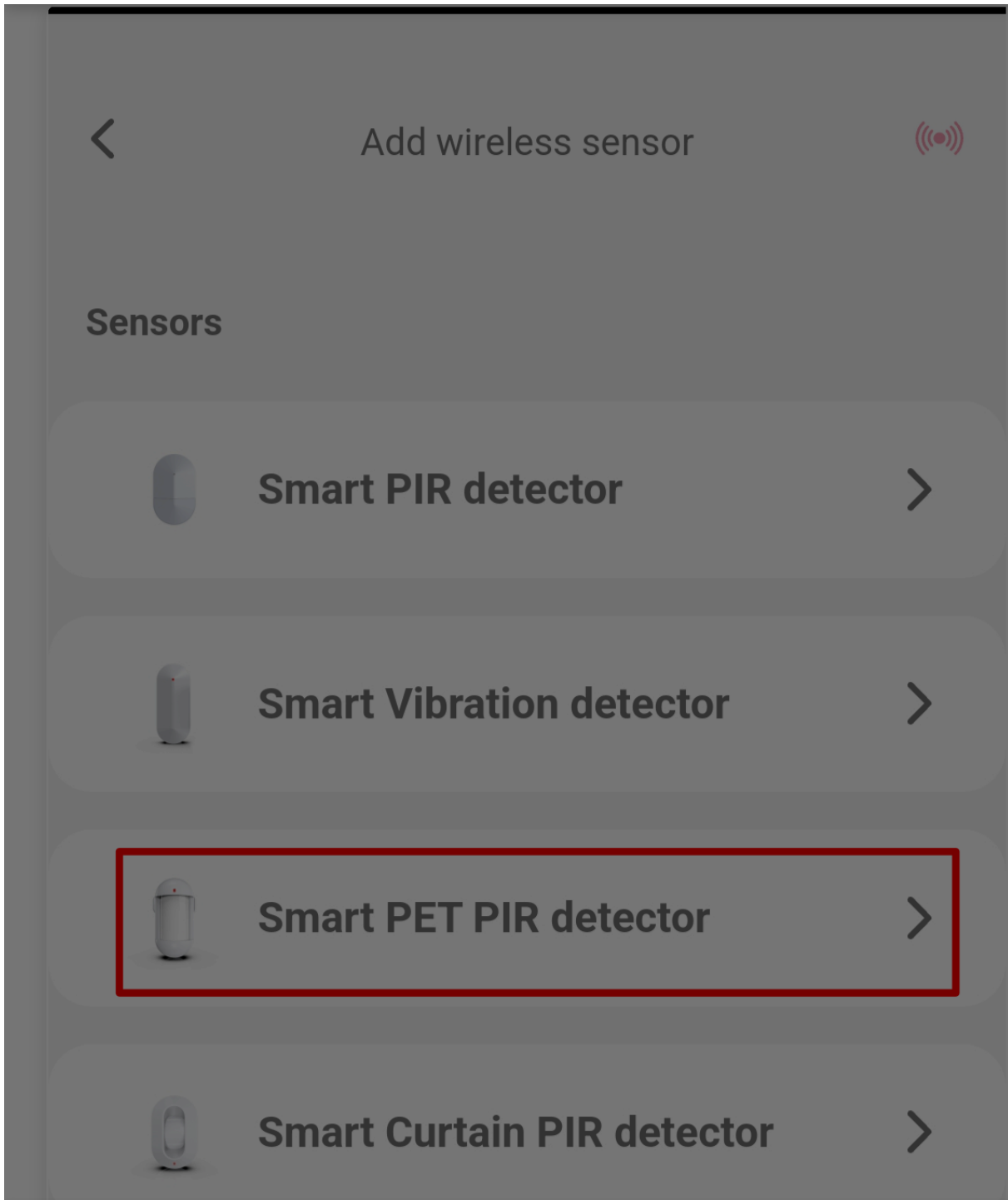

Cookie consent

We use cookies to measure the effectiveness of our documentation and whether users find what they're searching for. With your consent, you're helping us to make our documentation better.

Google Analytics





Safety devices



Smart Smoke detector



- The app shows the sensor in **Learning** mode with a diagram of the learn button. **Press and hold the learn button** until the green indicator stays lit for 2 seconds.

Cookie consent

We use cookies to measure the effectiveness of our documentation and whether users find what they're searching for. With your consent, you're helping us to make our documentation better.

Google Analytics

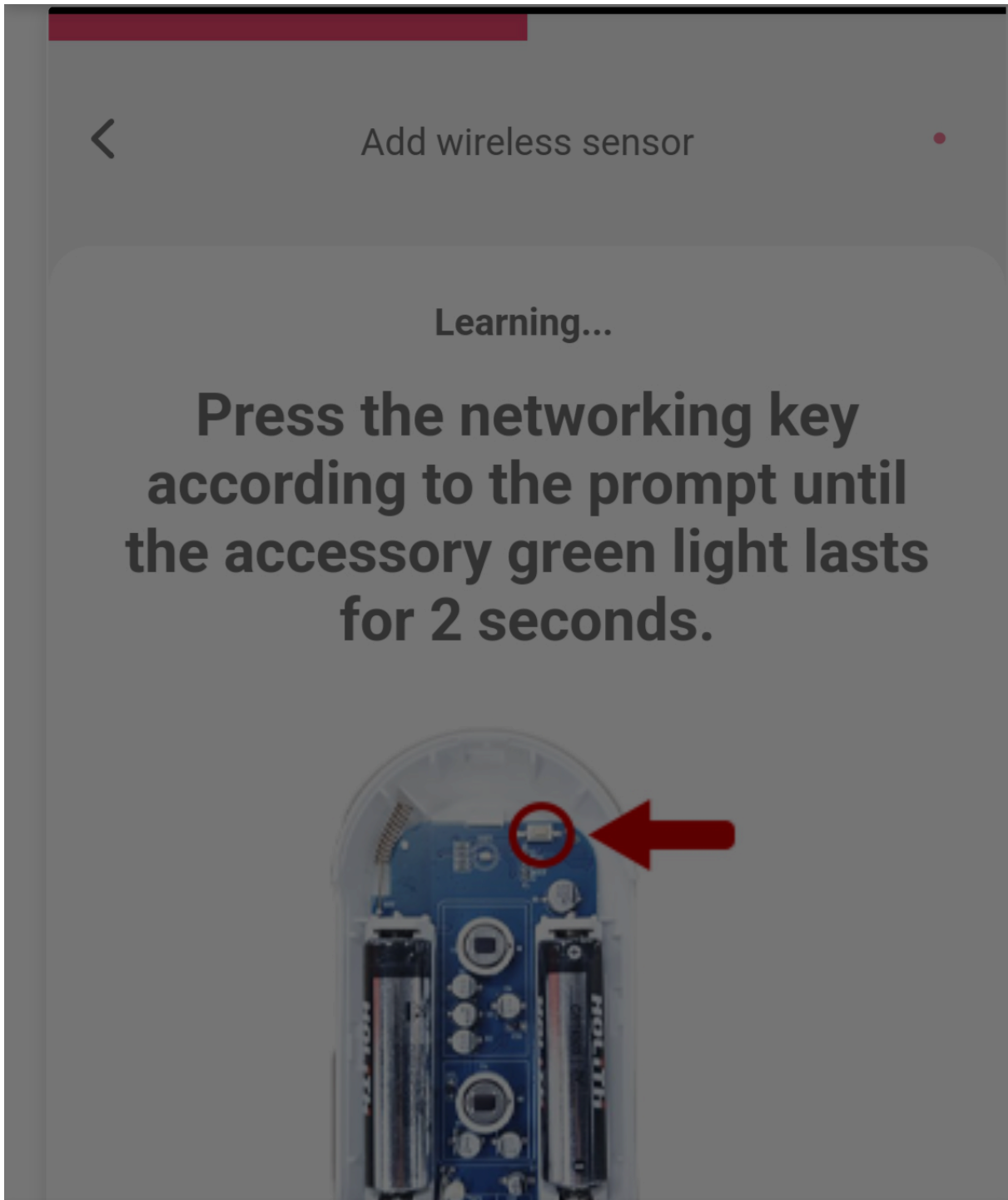

Cookie consent

We use cookies to measure the effectiveness of our documentation and whether users find what they're searching for. With your consent, you're helping us to make our documentation better.

Google Analytics



Cancel

7. When the sensor is detected, a confirmation appears with its serial number. Tap **OK**.

Cookie consent

We use cookies to measure the effectiveness of our documentation and whether users find what they're searching for. With your consent, you're helping us to make our documentation better.

Google Analytics



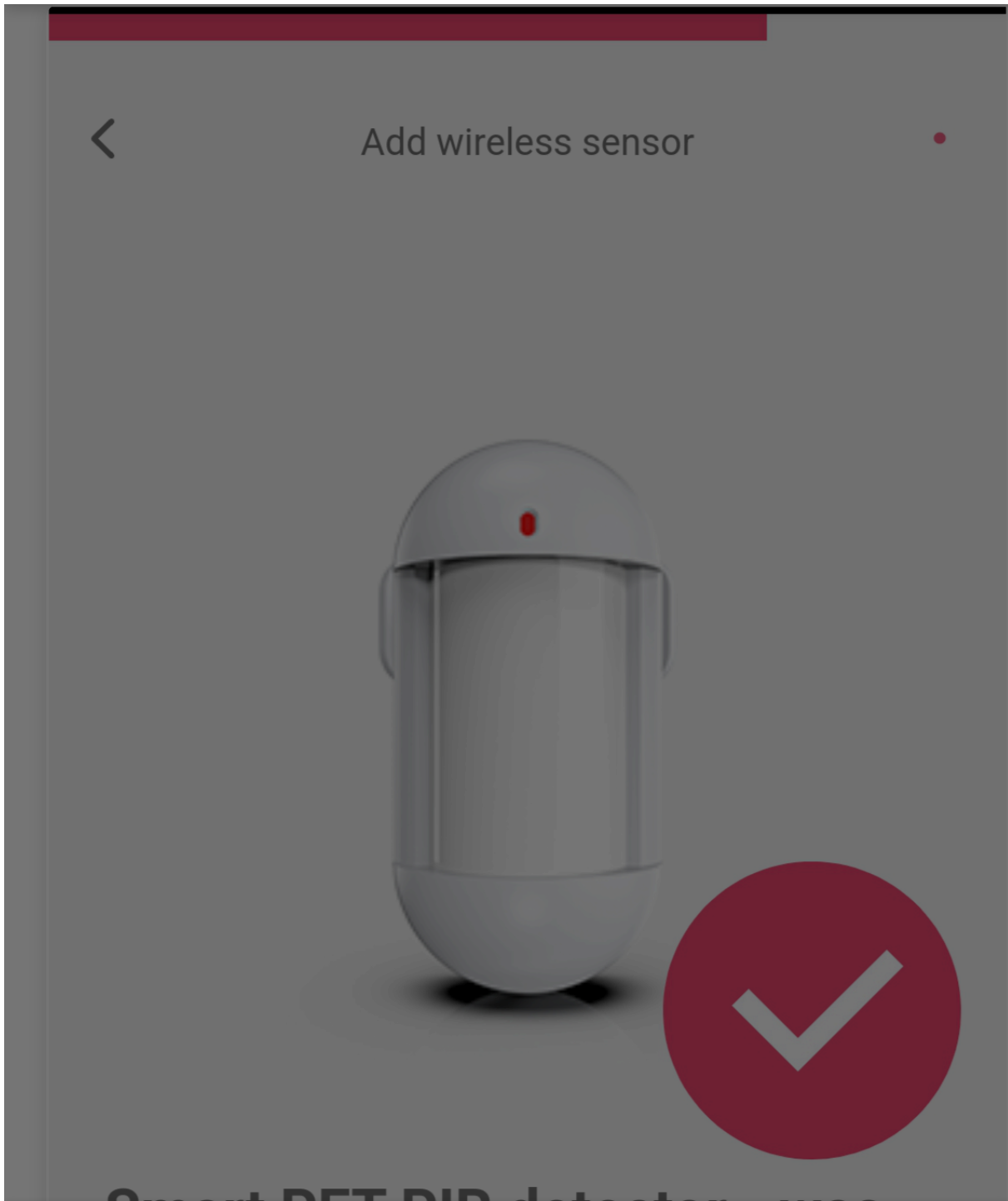

Cookie consent

We use cookies to measure the effectiveness of our documentation and whether users find what they're searching for. With your consent, you're helping us to make our documentation better.

Google Analytics





OK

8. The sensor appears in the list with a **NEW** badge.

Cookie consent

We use cookies to measure the effectiveness of our documentation and whether users find what they're searching for. With your consent, you're helping us to make our documentation better.

Google Analytics

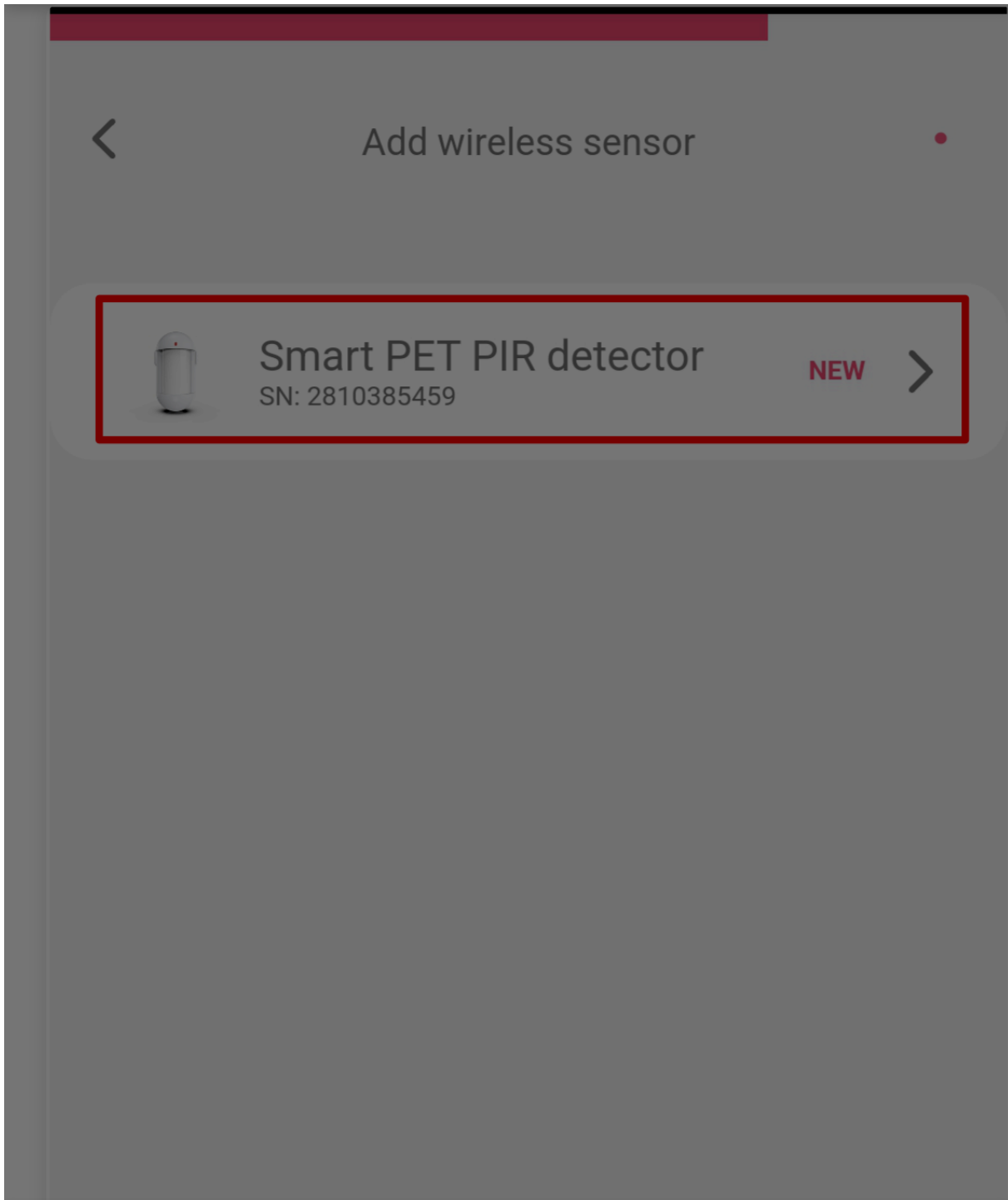

Cookie consent

We use cookies to measure the effectiveness of our documentation and whether users find what they're searching for. With your consent, you're helping us to make our documentation better.

Google Analytics



Next

Configure zone settings:

9. Tap the sensor to open its settings. Tap **Zone settings** to expand the section.

Cookie consent

We use cookies to measure the effectiveness of our documentation and whether users find what they're searching for. With your consent, you're helping us to make our documentation better.

Google Analytics

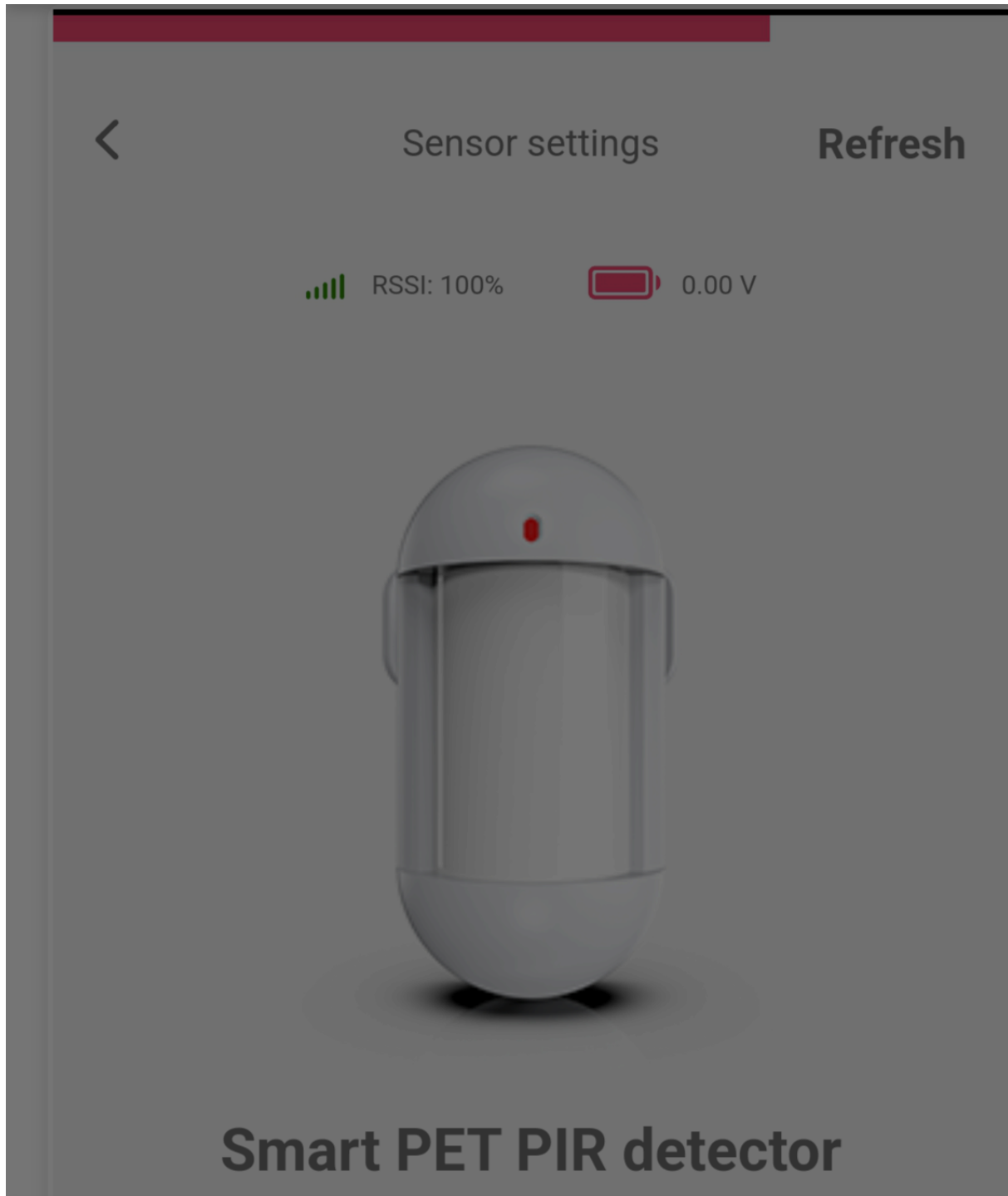

Cookie consent

We use cookies to measure the effectiveness of our documentation and whether users find what they're searching for. With your consent, you're helping us to make our documentation better.

Google Analytics



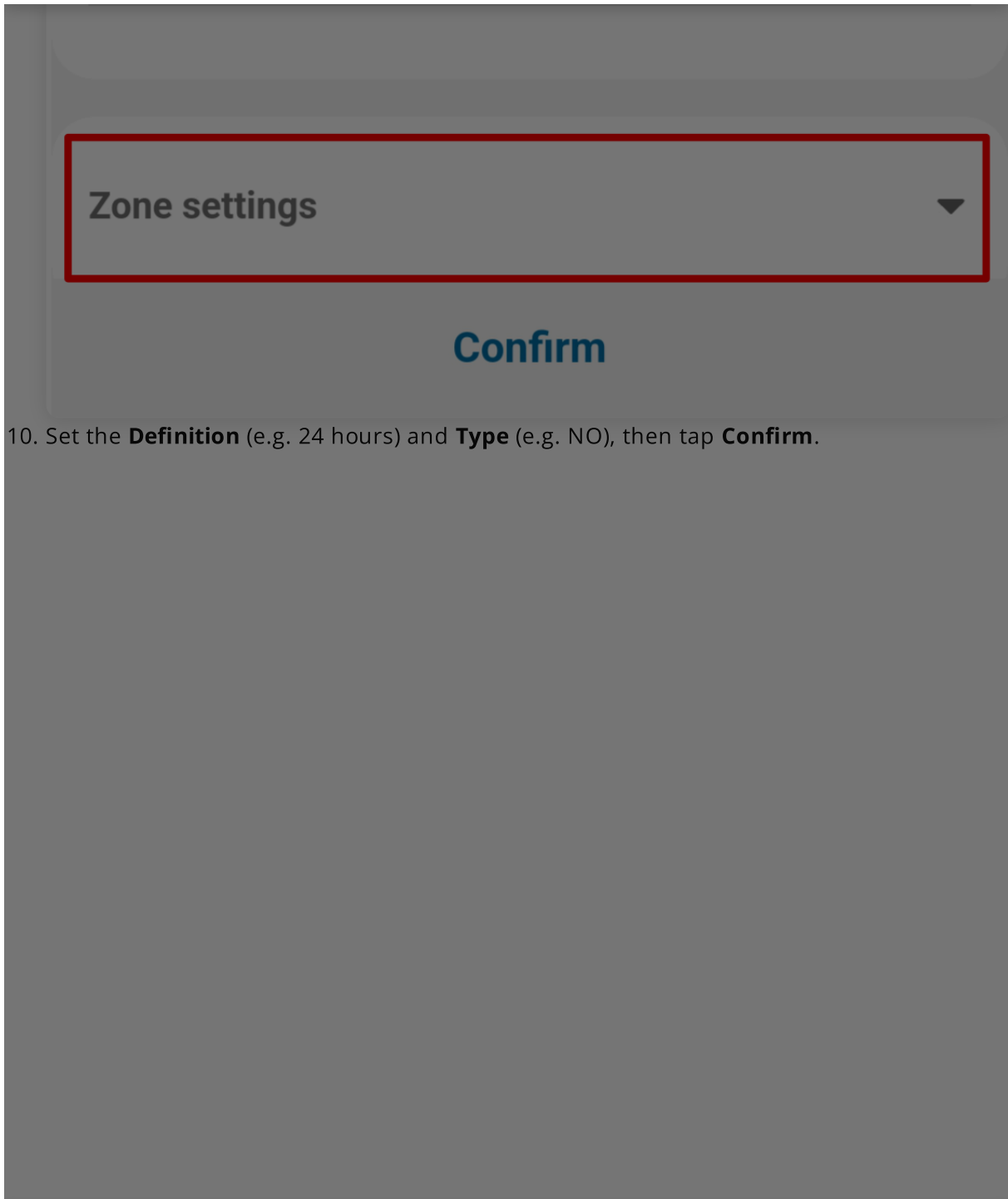

10. Set the **Definition** (e.g. 24 hours) and **Type** (e.g. NO), then tap **Confirm**.

Cookie consent

We use cookies to measure the effectiveness of our documentation and whether users find what they're searching for. With your consent, you're helping us to make our documentation better.

Google Analytics



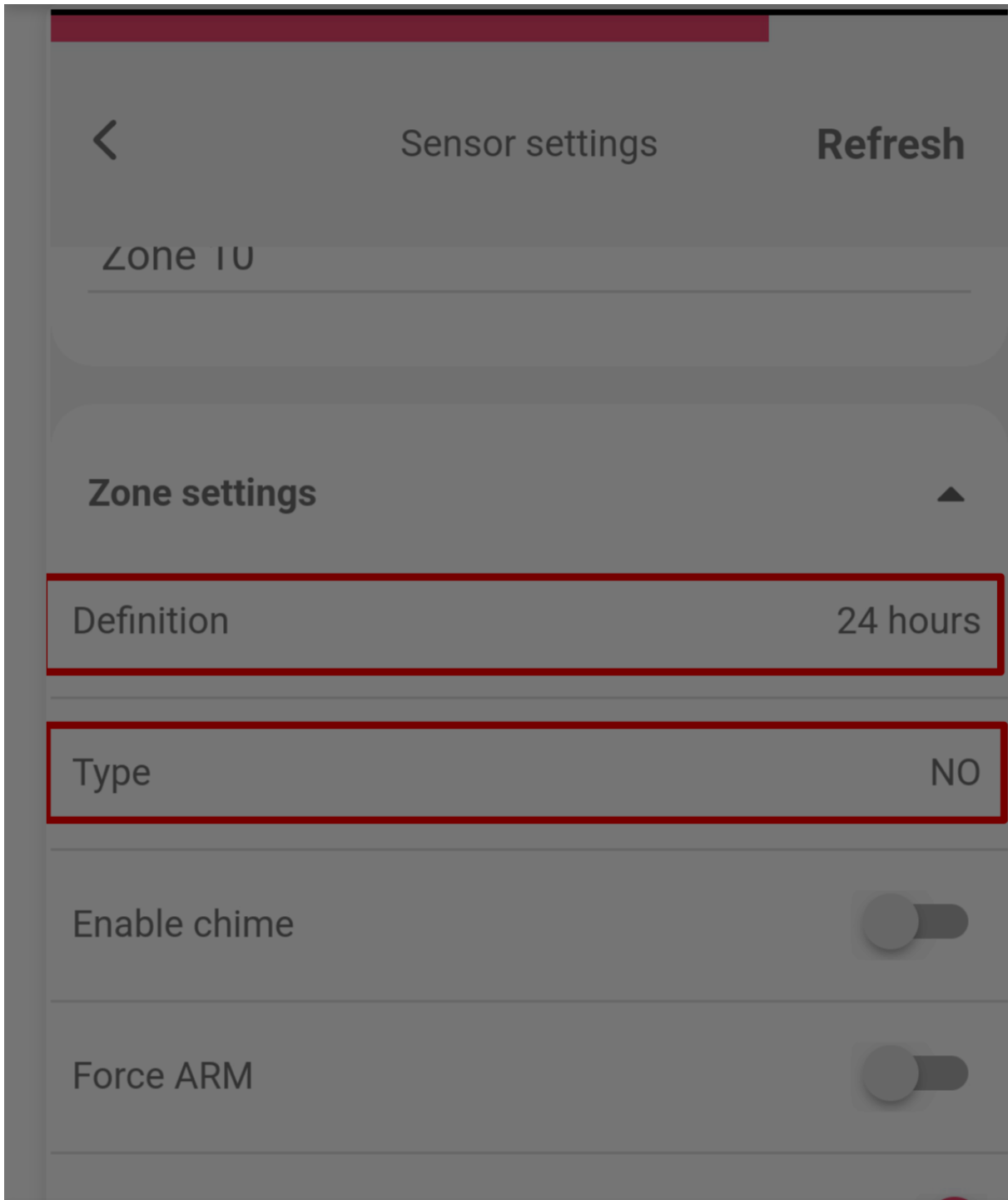

Cookie consent

We use cookies to measure the effectiveness of our documentation and whether users find what they're searching for. With your consent, you're helping us to make our documentation better.

Google Analytics



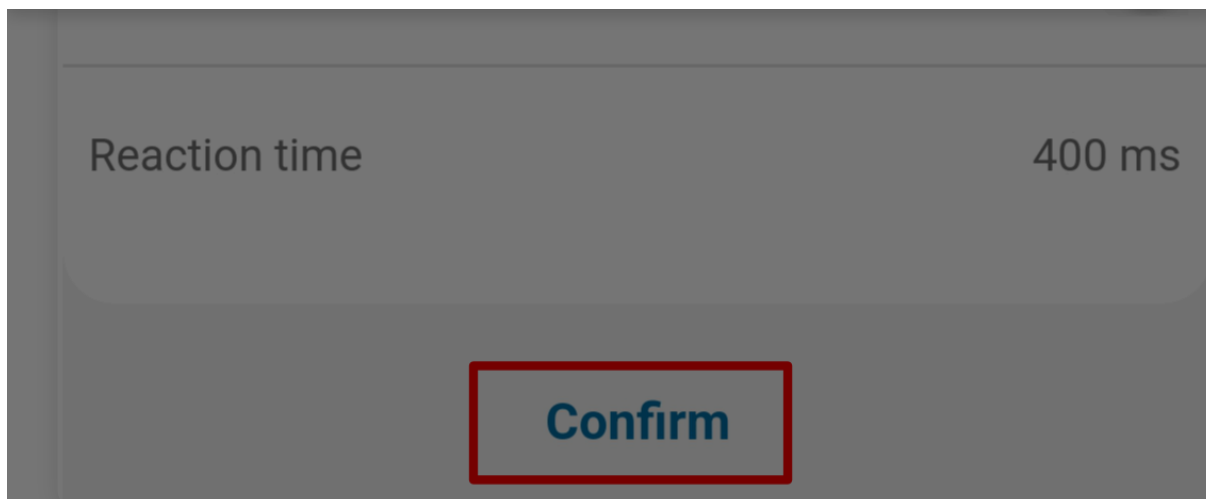

11. To add another sensor, tap + and repeat steps 5–10. When all sensors are paired, tap **Next**.

Open web.protequs.app in a desktop browser. The SP3 system must already be added to your account.

1. Select the SP3 system from the left panel, then click **Devices** in the system menu.

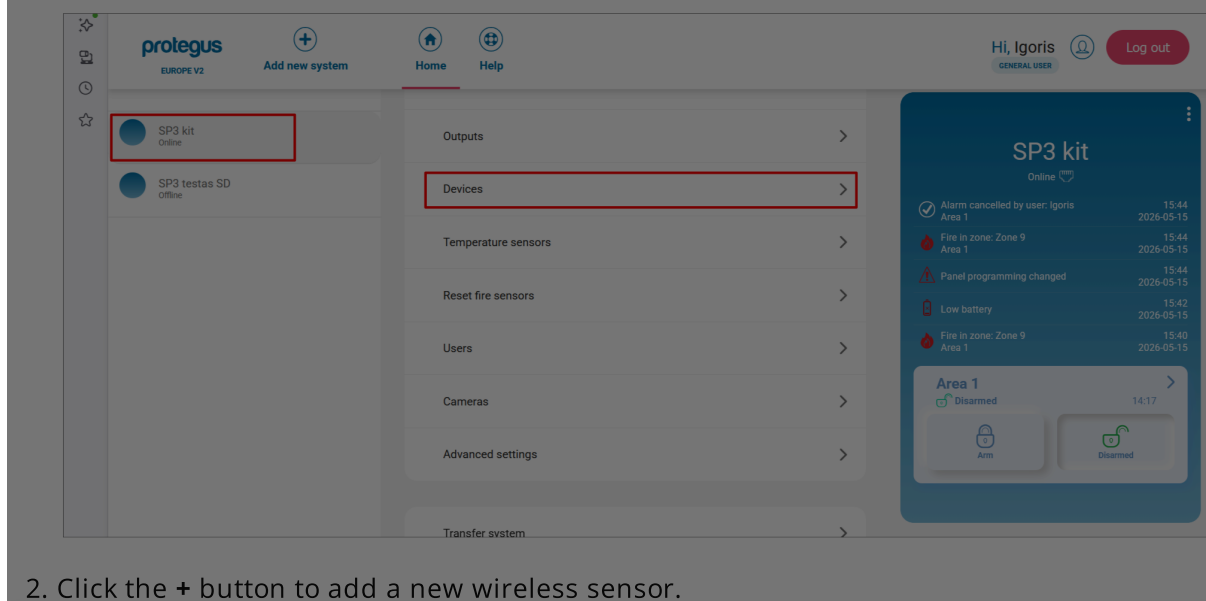

2. Click the + button to add a new wireless sensor.

Cookie consent

We use cookies to measure the effectiveness of our documentation and whether users find what they're searching for. With your consent, you're helping us to make our documentation better.

Google Analytics

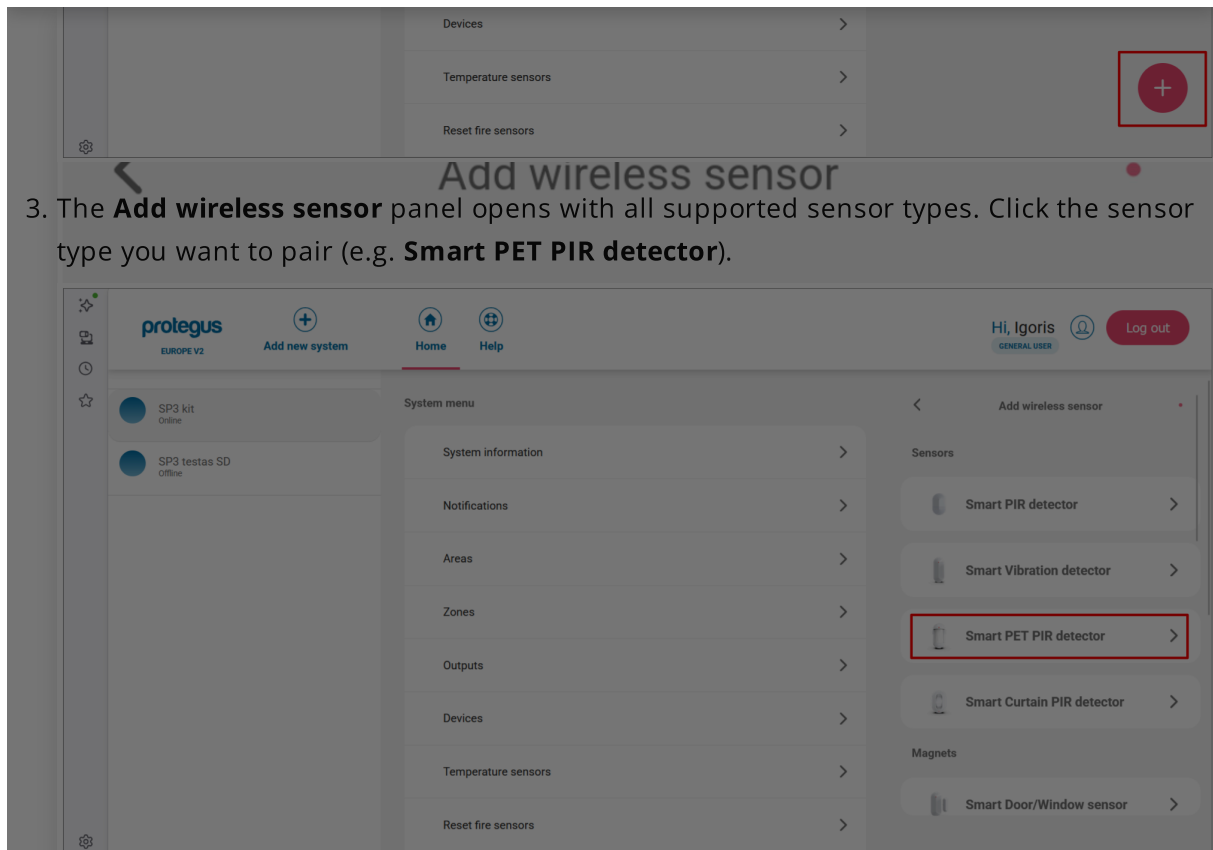

4. The app switches to **Learning** mode and shows the sensor with a diagram indicating the learn button location.

Press and hold the learn button until the green indicator stays lit for 2 seconds (approximately 4–5 seconds).

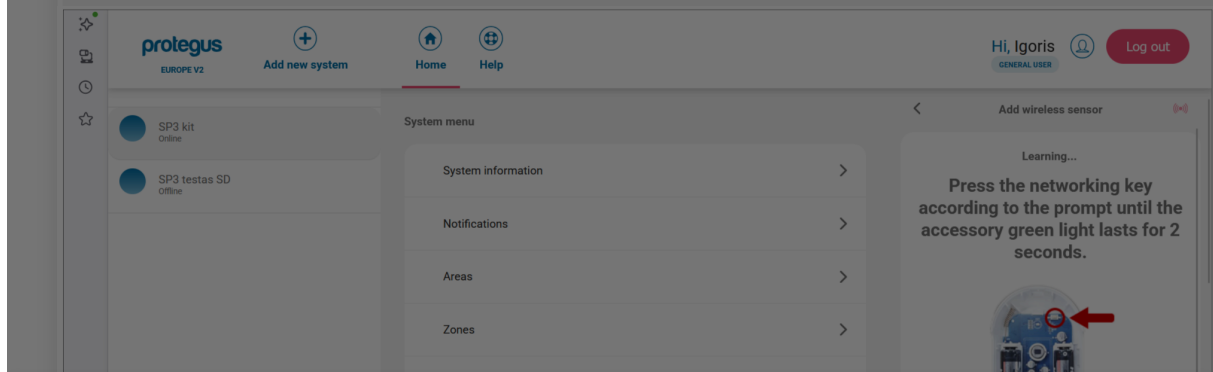

Cookie consent

We use cookies to measure the effectiveness of our documentation and whether users find what they're searching for. With your consent, you're helping us to make our documentation better.

Google Analytics

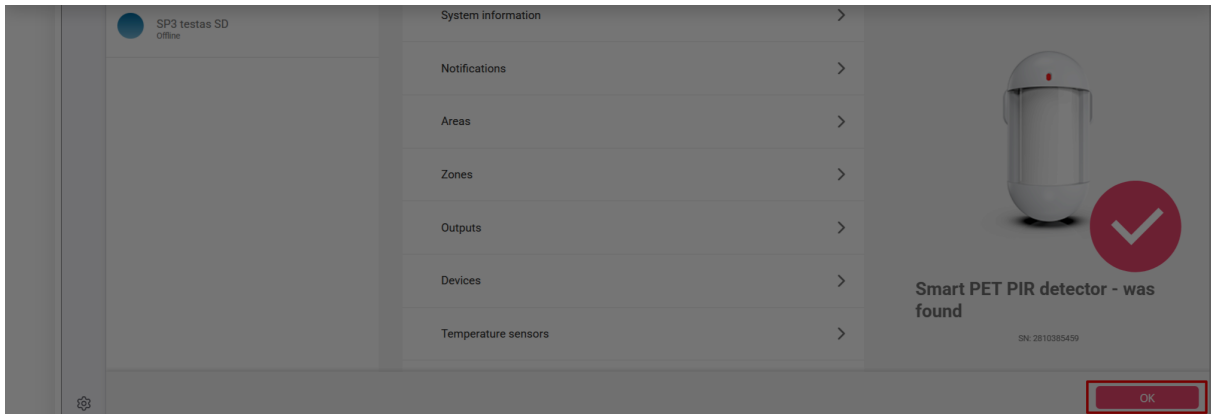

6. The sensor appears in the list with a **NEW** badge. To add another sensor, click **+** and repeat steps 3–5. When all sensors are paired, click **Next**.
 12. A success dialog confirms the pairing. Tap **Close**.

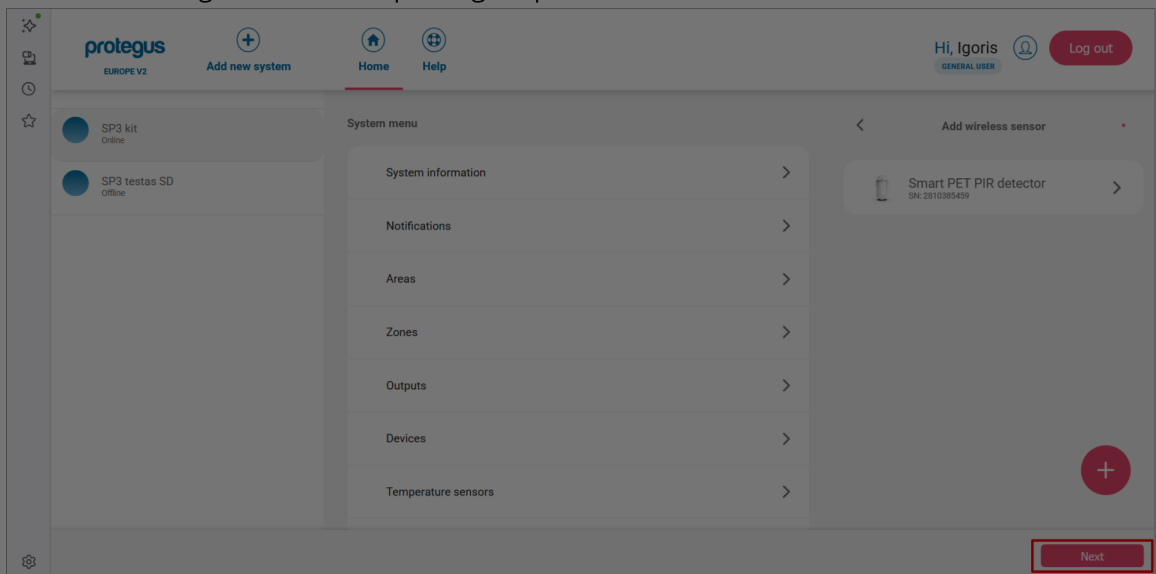

7. A success dialog confirms the pairing. Click **Close**.

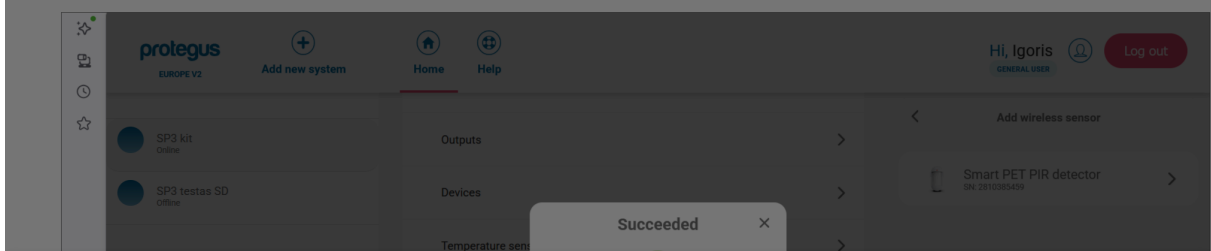

Cookie consent

We use cookies to measure the effectiveness of our documentation and whether users find what they're searching for. With your consent, you're helping us to make our documentation better.

- Google Analytics





8. In the **Devices** list, click a paired sensor to open its settings. Click **Zone settings** to expand the section.

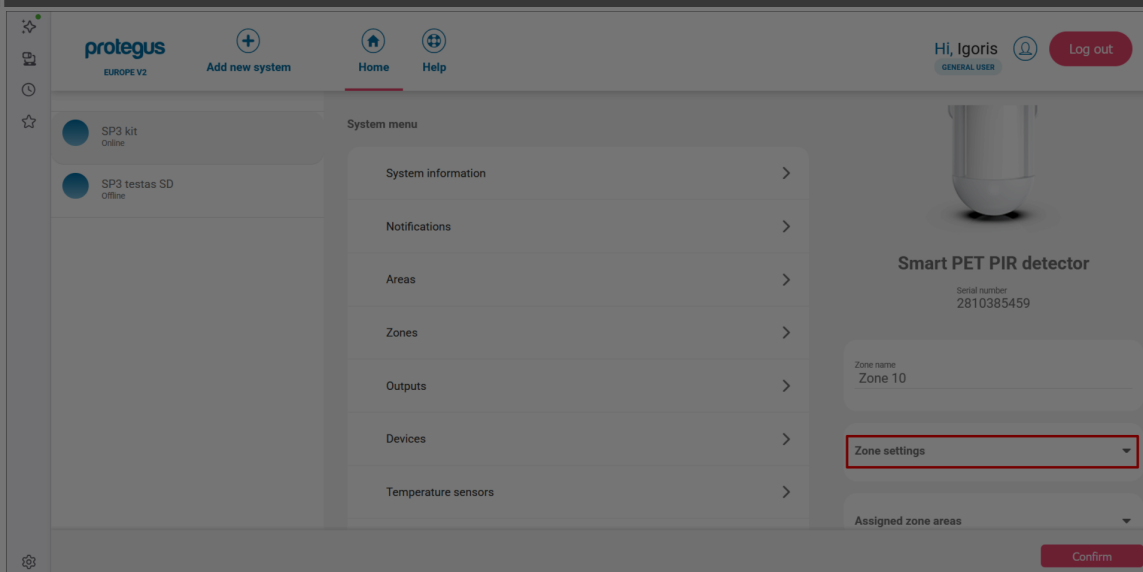

9. Set the **Definition** (e.g. Instant) and **Type** (e.g. NO) for the zone.

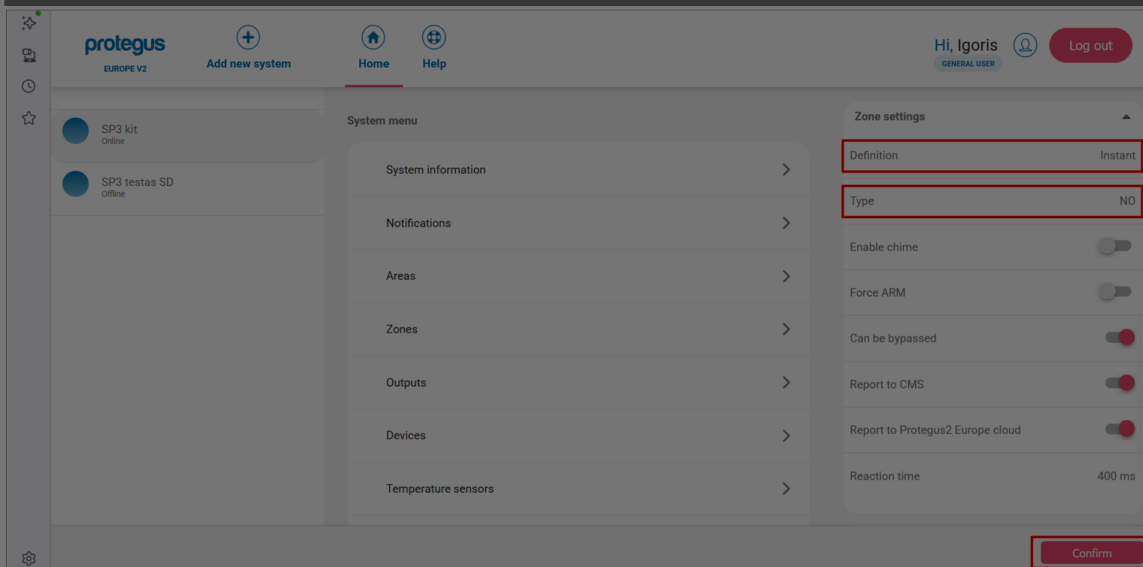

Verify zone status:

Close

Cookie consent

We use cookies to measure the effectiveness of our documentation and whether users find what they're searching for. With your consent, you're helping us to make our documentation better.

Google Analytics

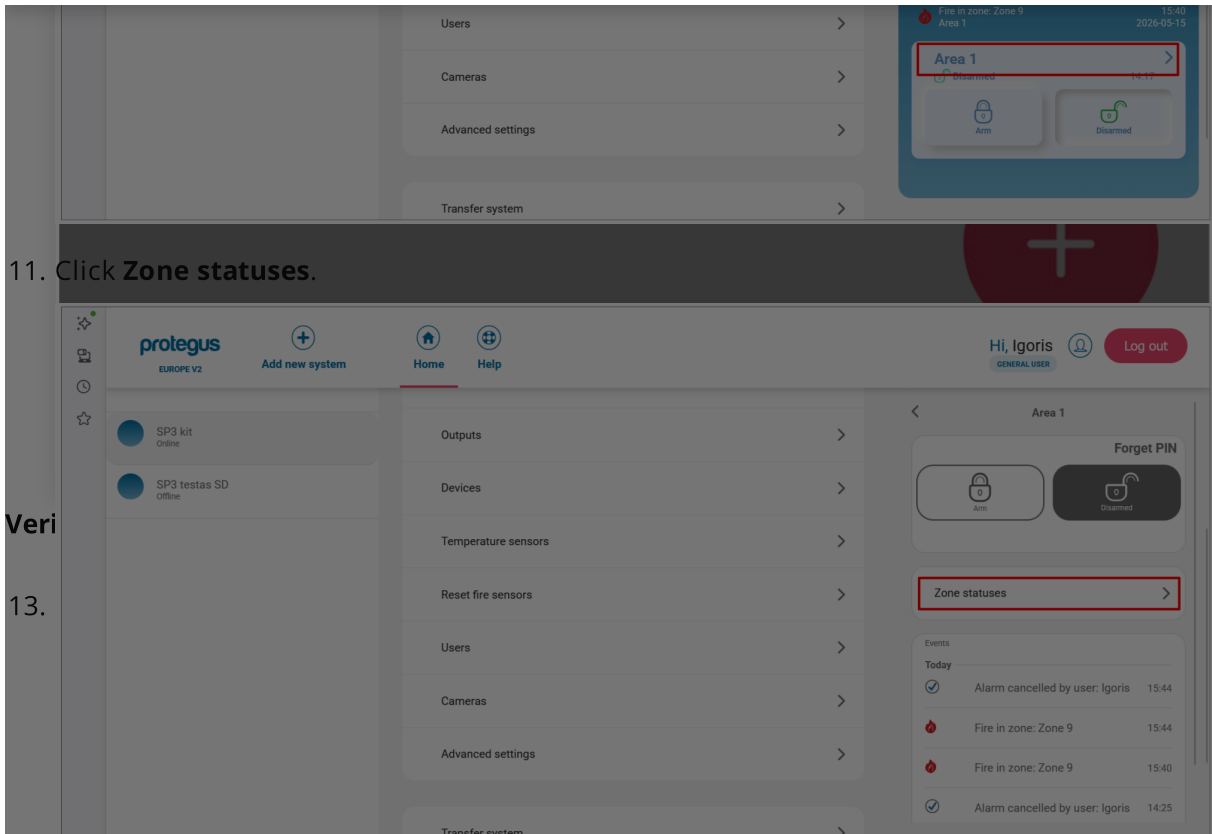

11. Click **Zone statuses**.

12. The **Zone status / bypass** panel lists all zones. A red alert icon on a zone means the sensor is currently open or triggered. Bypass toggles let you temporarily disable individual zones.

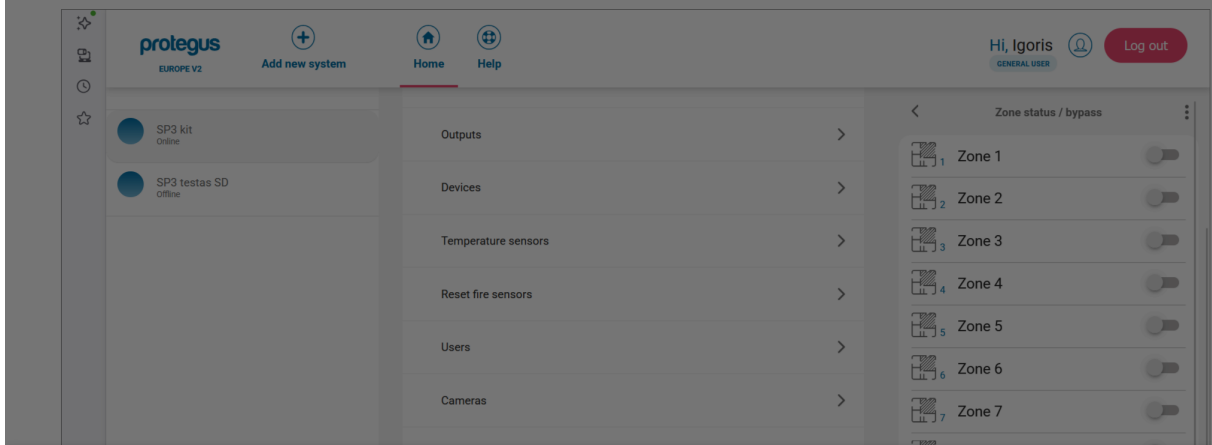

Cookie consent

We use cookies to measure the effectiveness of our documentation and whether users find what they're searching for. With your consent, you're helping us to make our documentation better.

- Google Analytics





yellow blinking).

WARNING

Never enroll or unenroll sensors while the panel is in learning mode for a different operation. Before pairing, unenroll each sensor first: hold learn button 5 s → three green flashes. **If a sensor is accidentally unpaired it stops working until re-paired.**

SP3 kit

Online

1. Open TrikdisConfig. In the **Remote access** section, enter the panel's **Unique ID** (printed on the device label), then click **Configure**.

2. Click **Read [F4]**. Enter admin or installer code if prompted.
3. Go to **Wireless sensors** and click **Learn sensors**.

4. The **Learning mode** dialog opens. For each sensor, press and hold the learn button for 5 seconds until it flashes **green four times**.

Cookie consent

We use cookies to measure the effectiveness of our documentation and whether users find what they're searching for. With your consent, you're helping us to make our documentation better.

Google Analytics

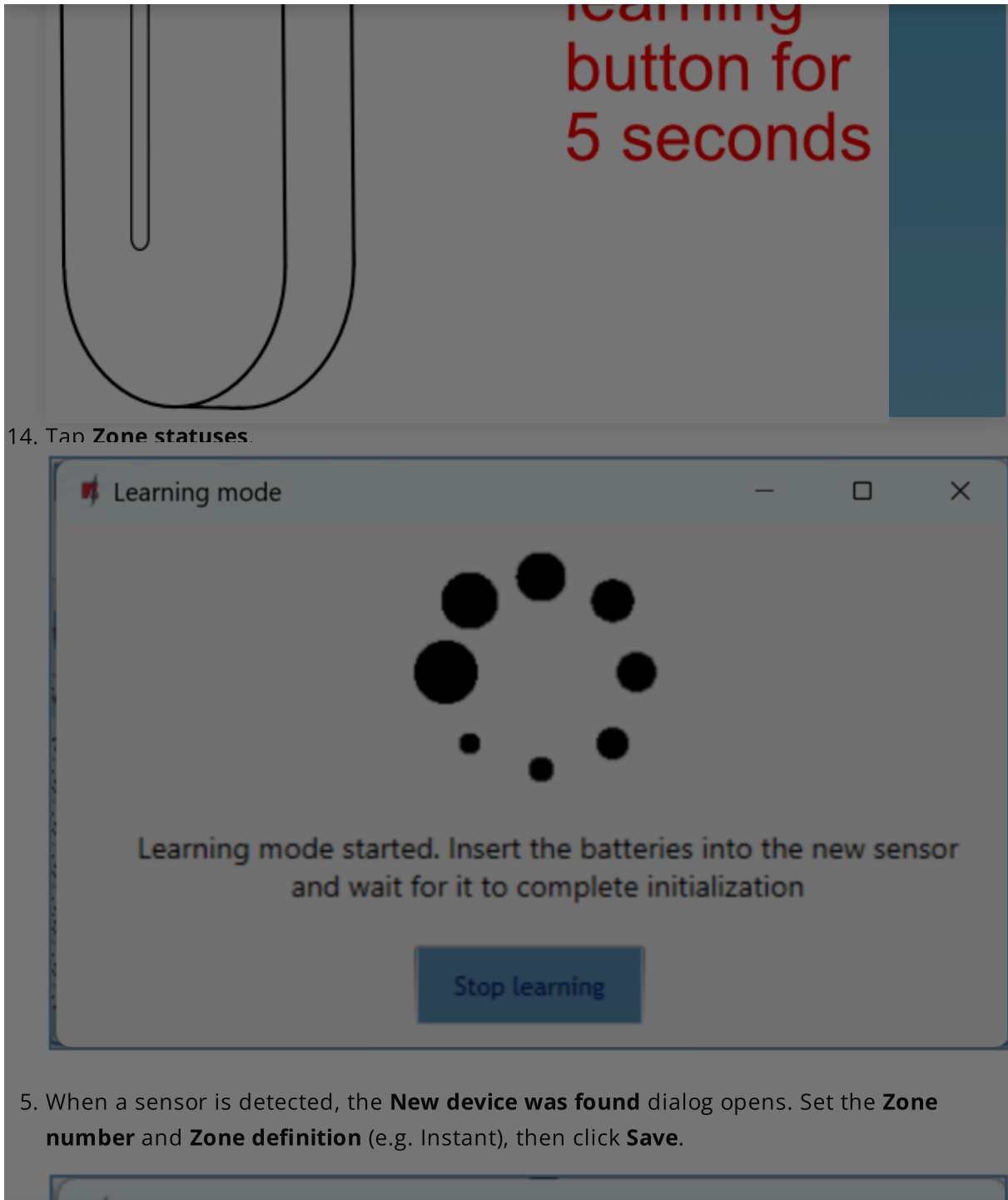

Cookie consent

We use cookies to measure the effectiveness of our documentation and whether users find what they're searching for. With your consent, you're helping us to make our documentation better.

Google Analytics

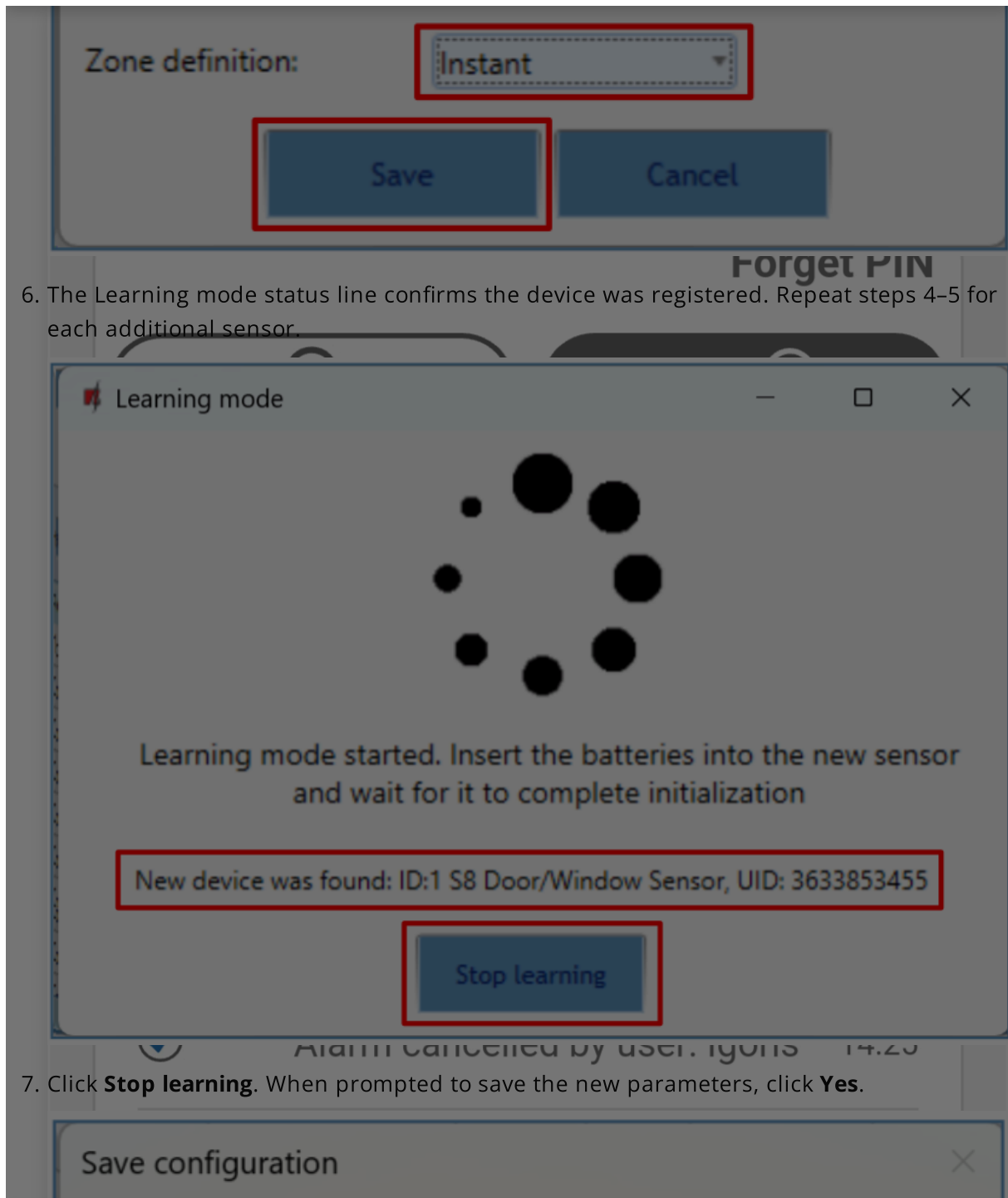

Cookie consent

We use cookies to measure the effectiveness of our documentation and whether users find what they're searching for. With your consent, you're helping us to make our documentation better.

Google Analytics



8. Click **Read [F4]**. The **WIRELESS SENSORS** tab now lists all registered sensors with their serial numbers.

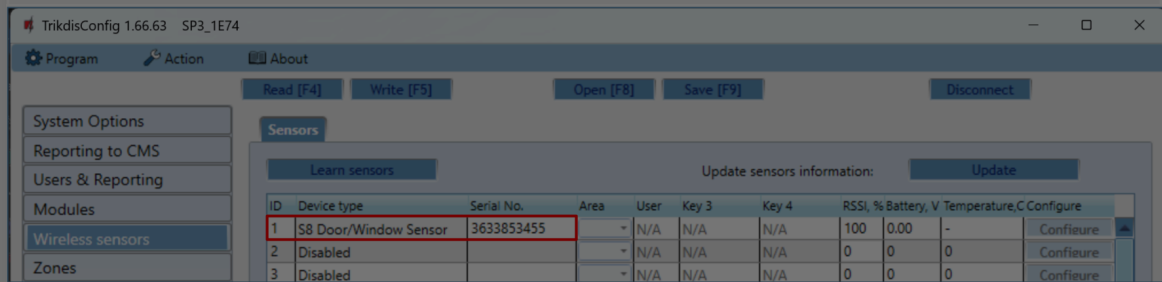

9. Open the **Zones** tab. Confirm zone and area assignments. Set **Type** to **EOL-T** to enable tamper monitoring. Click **Write [F5]**.

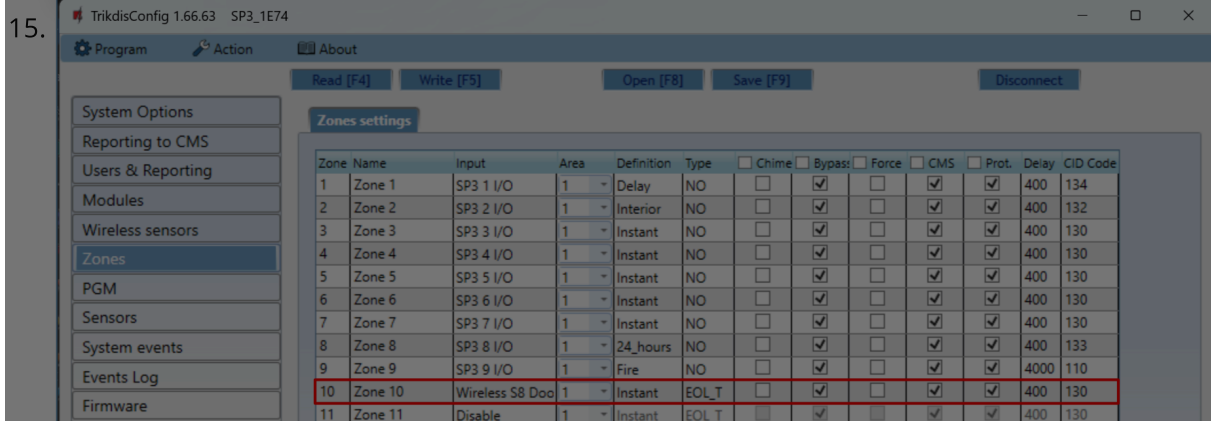

Local pairing (no network)

The RF-S8 transceiver has a **LEARN** button on its circuit board — use it to enter and exit learning mode without a PC connection.

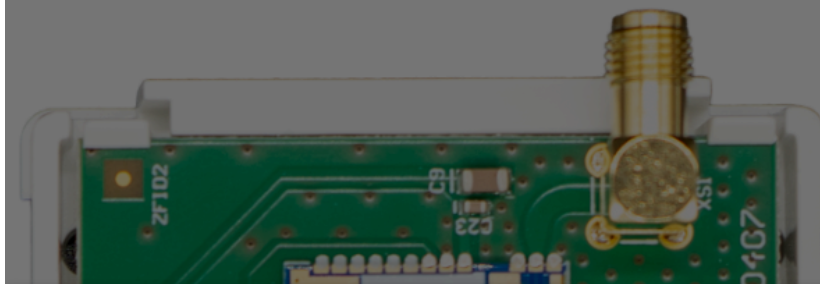

Cookie consent

We use cookies to measure the effectiveness of our documentation and whether users find what they're searching for. With your consent, you're helping us to make our documentation better.

- Google Analytics

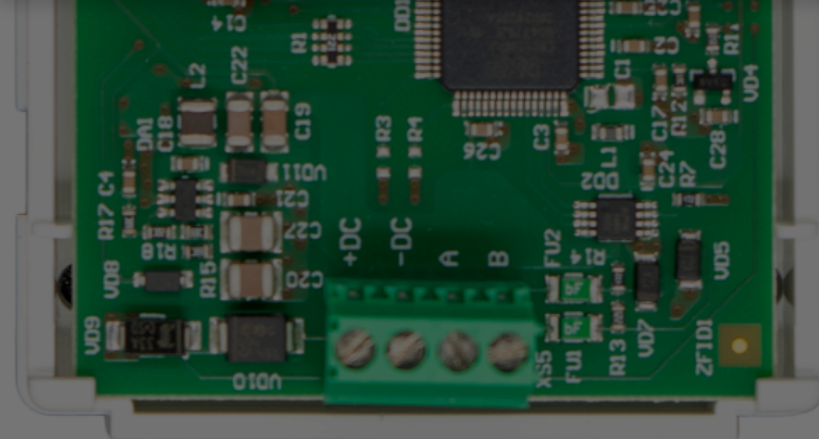

1. Confirm the RF-S84s registered with the SP3 (visible in Modules list after firmware setup).
2. Power on the SP3.
3. Remove the RF-S8 cover.
4. Hold the RF-S8 **LEARN** button until the NETWORK LED flashes green/red. Release.
5. Pair each sensor: hold learn button 5 s → four green flashes. NETWORK LED turns solid green briefly after each success.
6. When done, hold the RF-S8 **LEARN** button until NETWORK LED stops flashing. Release — transceiver exits learning mode.
7. Connect USB Mini-B to SP3. Open TrikdisConfig → **Read [F4]**.
8. Confirm serial numbers in **Wireless sensors** tab.
9. Assign zones and areas in the **Zones** tab → **Write [F5]**.

Remove a wireless sensor

1. Connect to SP3 (USB or remote) → **Read [F4]**.
2. In **Wireless sensors**, set the sensor's **Device type** to Disabled.
3. Click **Write [F5]**.

Cookie consent

We use cookies to measure the effectiveness of our documentation and whether users find what they're searching for. With your consent, you're helping us to make our documentation better.

Google Analytics



1. LED reference – RF-S8 transceiver

LED	State	Meaning
NETWORK	Flashing green/red	Learning mode active
NETWORK	Solid green (5 s)	Sensor successfully enrolled
POWER	Off	No supply voltage
POWER	Green blinking	Normal operation
POWER	Yellow blinking	Supply voltage low (≤ 11.5 V)
POWER	Yellow solid	No RS485 communication with SP3

Cookie consent

We use cookies to measure the effectiveness of our documentation and whether users find what they're searching for. With your consent, you're helping us to make our documentation better.

Google Analytics