

CONTROLADORES

Configuración rápida de GATOR LTE y GATOR WiFi con iO4R

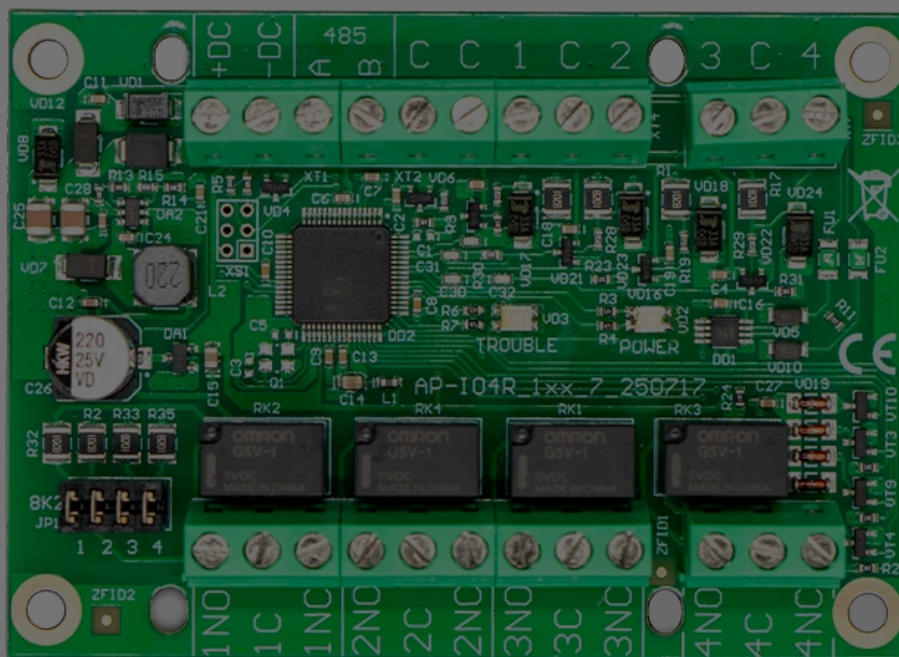

Pasos breves de cableado y programación en Protegus2 para conectar un expansor iO4R a un controlador de puerta GATOR LTE o GATOR WiFi. Use esta guía junto con los manuales completos de GATOR y GATOR WiFi para los demás ajustes de instalación y configuración.

El iO4R se utiliza para la monitorización avanzada de puertas. Añade entradas Guard monitorizadas para sensores de seguridad de la puerta y permite una anulación temporal autorizada cuando se debe aislar un fallo del sensor hasta que se pueda realizar el servicio. Protegus2 también cuenta los ciclos completos de apertura y cierre de

Cookie consent

We use cookies to measure the effectiveness of our documentation and whether users find what they're searching for. With your consent, you're helping us to make our documentation better.

Google Analytics

Accept

Reject



PRECAUCIÓN

La instalación y el servicio deben ser realizados solo por personal cualificado. Desconecte la alimentación de red y la alimentación de baja tensión antes de cablear. Siga las instrucciones de seguridad del fabricante del operador de puerta y la normativa eléctrica local.

1. Requisitos previos

- Controlador de puerta GATOR LTE o GATOR WiFi disponible para la configuración. Mantenga la alimentación desconectada durante el cableado.
- Número de serie del expansor iO4R.
- Cuenta de empresa o instalador en Protegus2 y el IMEI / Unique ID del controlador.
- Sensor de estado de puerta conectado a la entrada de posición de puerta del controlador.
- Sensores de seguridad de puerta conectados mediante el expansor iO4R, si se van a monitorizar o anular temporalmente en Protegus2.

2. Cableado

Conecte el expansor iO4R al bus RS485 y a los terminales de alimentación del controlador como se muestra abajo.

NOTA

El esquema muestra las etiquetas de terminales de GATOR LTE. Para GATOR WiFi, use los terminales equivalentes +DC , -DC , A RS485 y B RS485 del manual de GATOR WiFi.

Cookie consent

We use cookies to measure the effectiveness of our documentation and whether users find what they're searching for. With your consent, you're helping us to make our documentation better.

Google Analytics

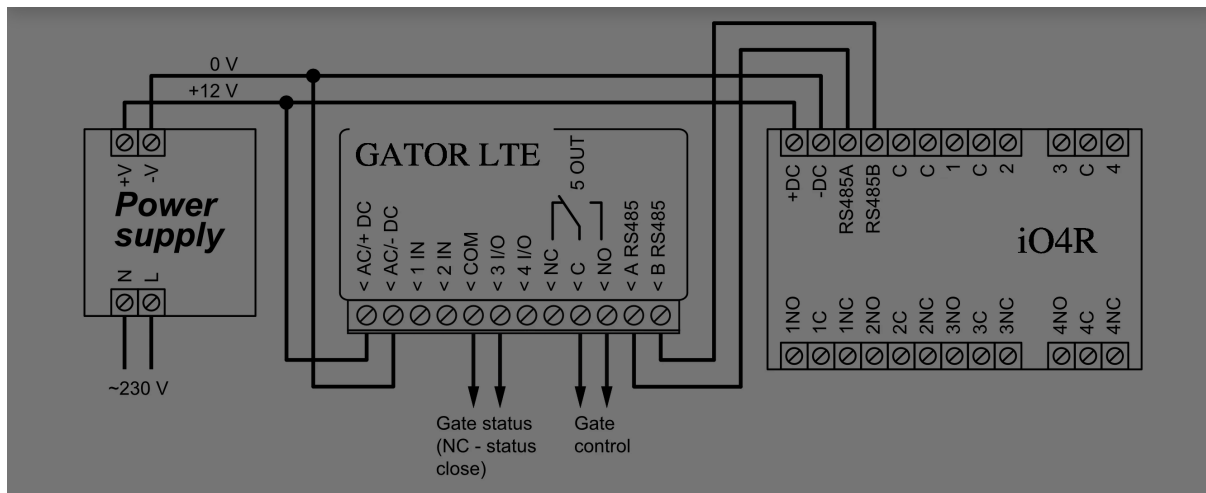

Use 3 I/O como entrada de posición de puerta para el conteo de ciclos. Un ciclo se cuenta solo después de que la puerta se abre completamente y se cierra completamente.

IMPORTANTE

En la configuración de monitorización de Protegus2, I/O 3 está reservado para la posición de puerta y el conteo de ciclos. No lo reasigne. Las entradas IN1 e IN2 están reservadas para Wiegand.

3. Añadir el controlador y el iO4R en Protegus2

Inicie sesión en Protegus2 con la cuenta de empresa o instalador y añada el controlador.

Paso 1. Toque **Add new system**.

Cookie consent

We use cookies to measure the effectiveness of our documentation and whether users find what they're searching for. With your consent, you're helping us to make our documentation better.

Google Analytics



Cookie consent

We use cookies to measure the effectiveness of our documentation and whether users find what they're searching for. With your consent, you're helping us to make our documentation better.

Google Analytics





Paso 2. Introduzca el **IMEI** del controlador y toque **Next**.

Cookie consent

We use cookies to measure the effectiveness of our documentation and whether users find what they're searching for. With your consent, you're helping us to make our documentation better.

Google Analytics



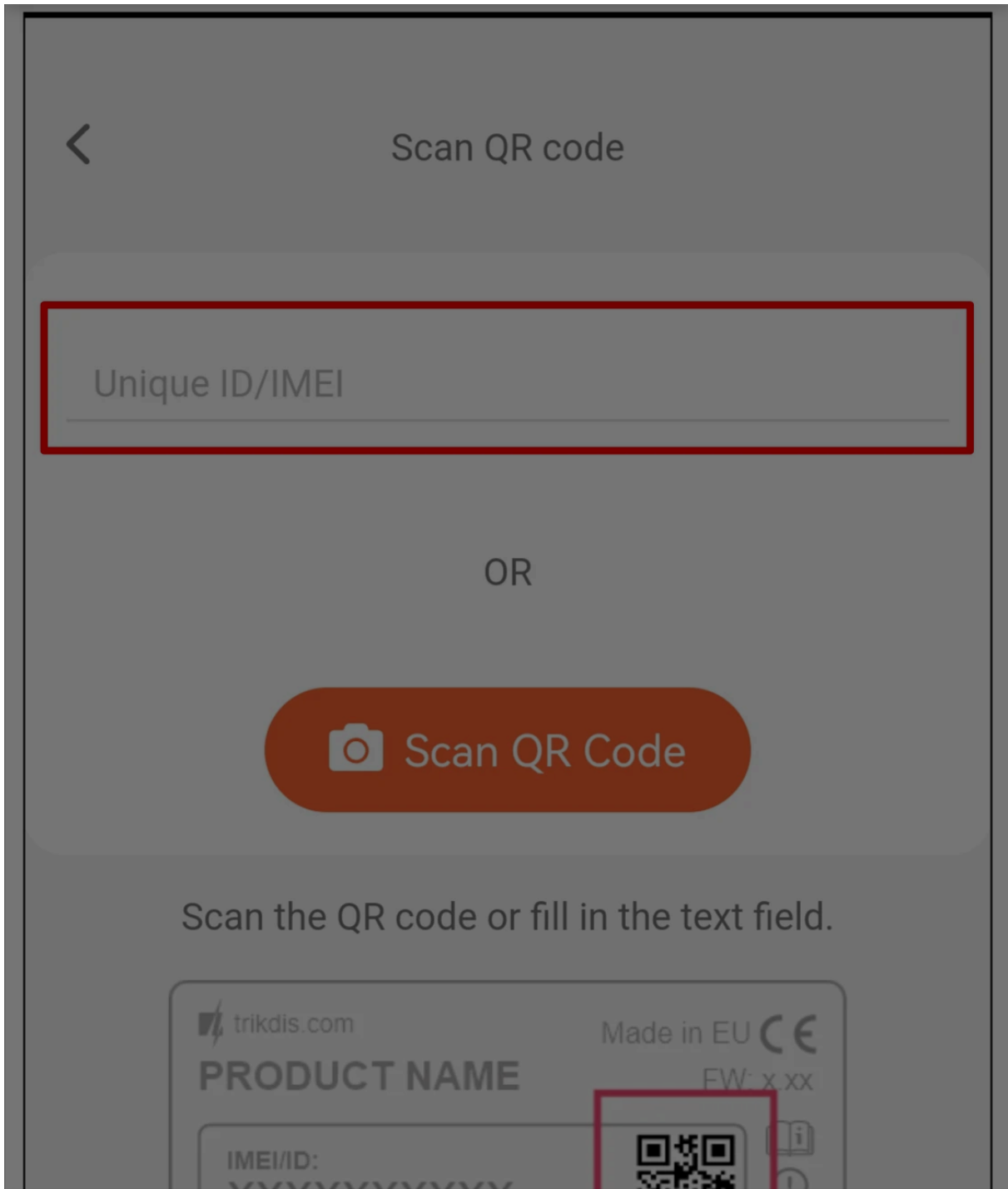

Cookie consent

We use cookies to measure the effectiveness of our documentation and whether users find what they're searching for. With your consent, you're helping us to make our documentation better.

Google Analytics



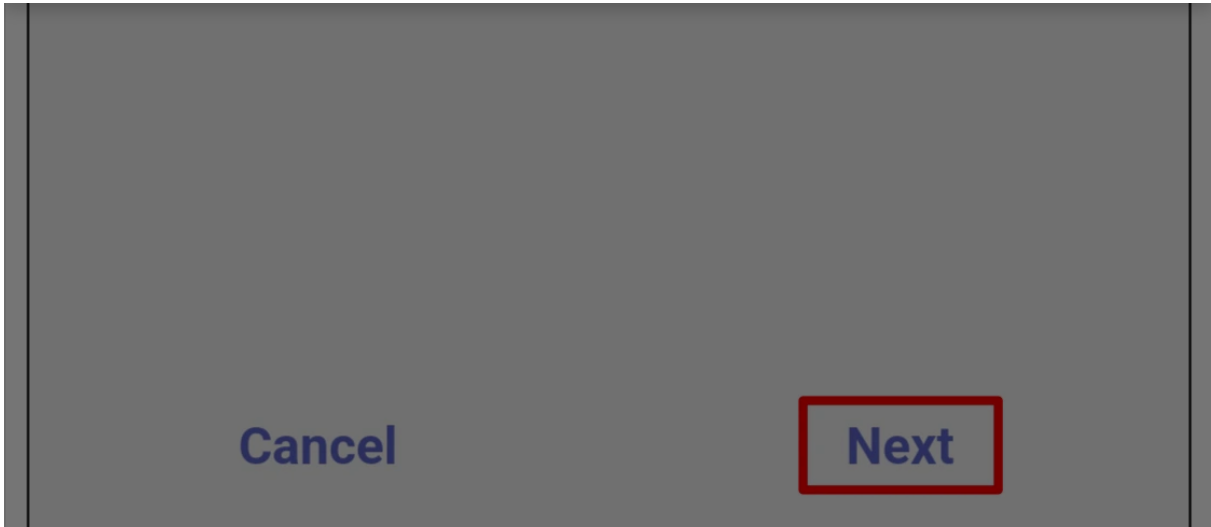

Paso 3. Seleccione **Advanced Gator Monitoring** y toque **Next**.

Cookie consent

We use cookies to measure the effectiveness of our documentation and whether users find what they're searching for. With your consent, you're helping us to make our documentation better.

Google Analytics



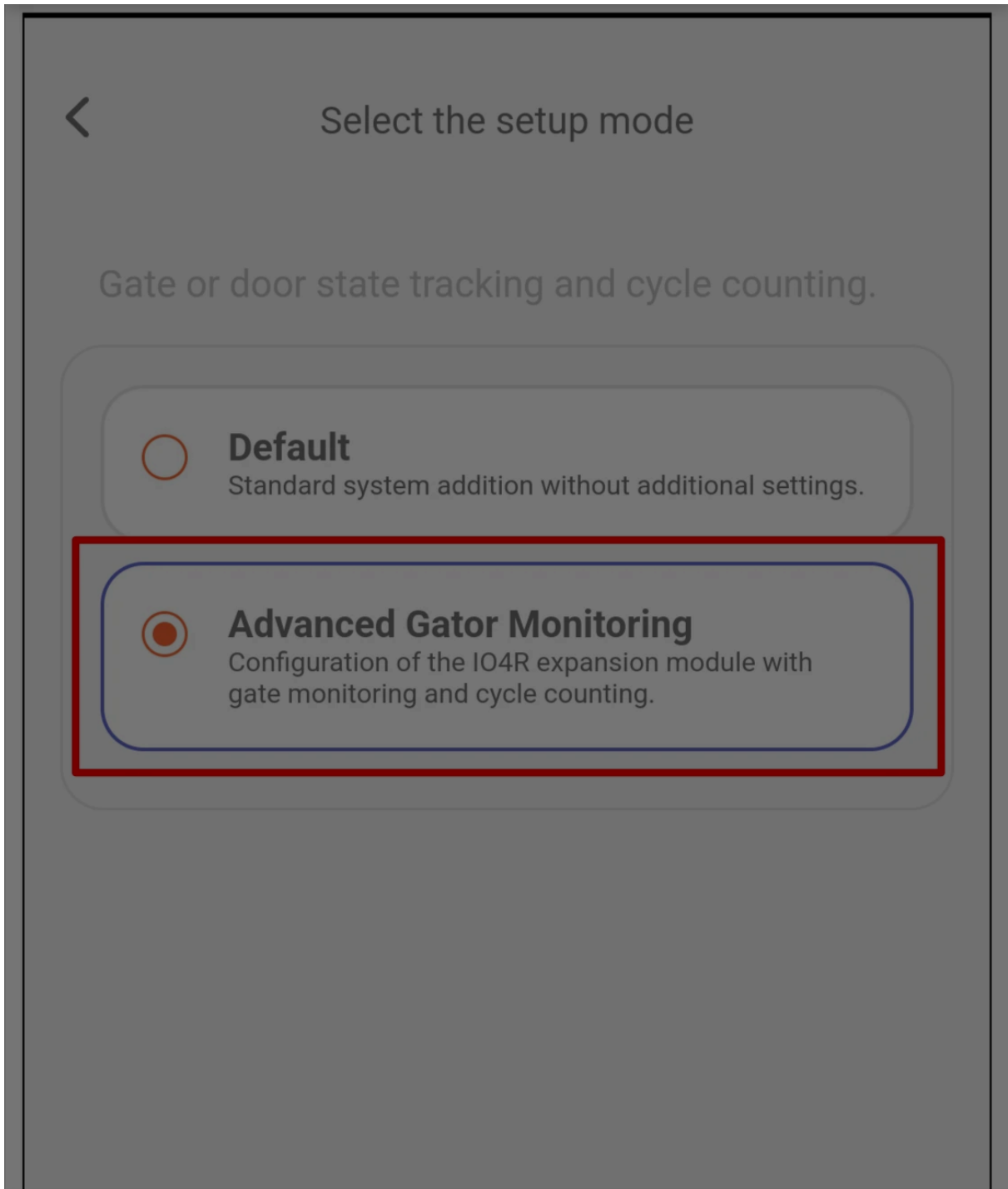

Cookie consent

We use cookies to measure the effectiveness of our documentation and whether users find what they're searching for. With your consent, you're helping us to make our documentation better.

Google Analytics





Cancel

Next

Paso 4. Defina el número de **Cycles** tras el cual se requiere mantenimiento y toque **Next**.

Cookie consent

We use cookies to measure the effectiveness of our documentation and whether users find what they're searching for. With your consent, you're helping us to make our documentation better.

Google Analytics





Gate control and maintenance

Output 5 Name
Gate control

Users will see the PGM name and Icon.

Gate/Door position input
I/O 3 terminal input will be used to determine gate position and count cycles.

I/O 3 Name
I/O 3

Users will see the IN3 name and icon.

Type NO

Cycles
3000

Cookie consent

We use cookies to measure the effectiveness of our documentation and whether users find what they're searching for. With your consent, you're helping us to make our documentation better.

Google Analytics



Output 3 uses the 3 input (I/O 3) to track state and count full opening and closing cycles.

Note: IN3 (I/O 3) is used for cycle counting and cannot be changed. IN1/IN2 are reserved for Wiegand.

Cancel

Next

Paso 5. Active cada salida iO4R que esté conectada a un sensor de seguridad monitorizado o a un circuito de estado.

Cookie consent

We use cookies to measure the effectiveness of our documentation and whether users find what they're searching for. With your consent, you're helping us to make our documentation better.

Google Analytics



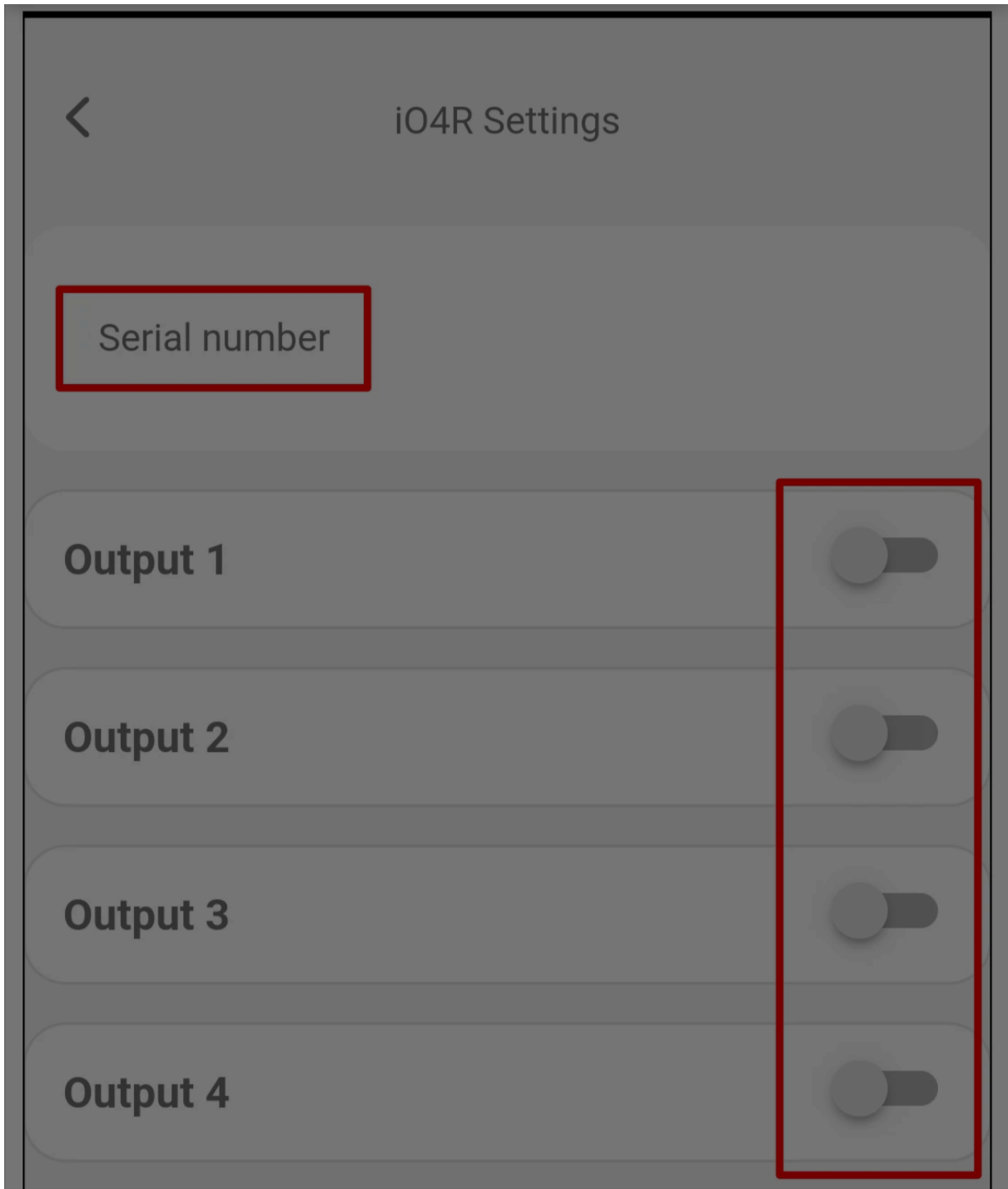

Cookie consent

We use cookies to measure the effectiveness of our documentation and whether users find what they're searching for. With your consent, you're helping us to make our documentation better.

Google Analytics



Cancel

Next

Paso 6. Introduzca el **Serial number** del iO4R y toque **OK**.

Cookie consent

We use cookies to measure the effectiveness of our documentation and whether users find what they're searching for. With your consent, you're helping us to make our documentation better.

Google Analytics



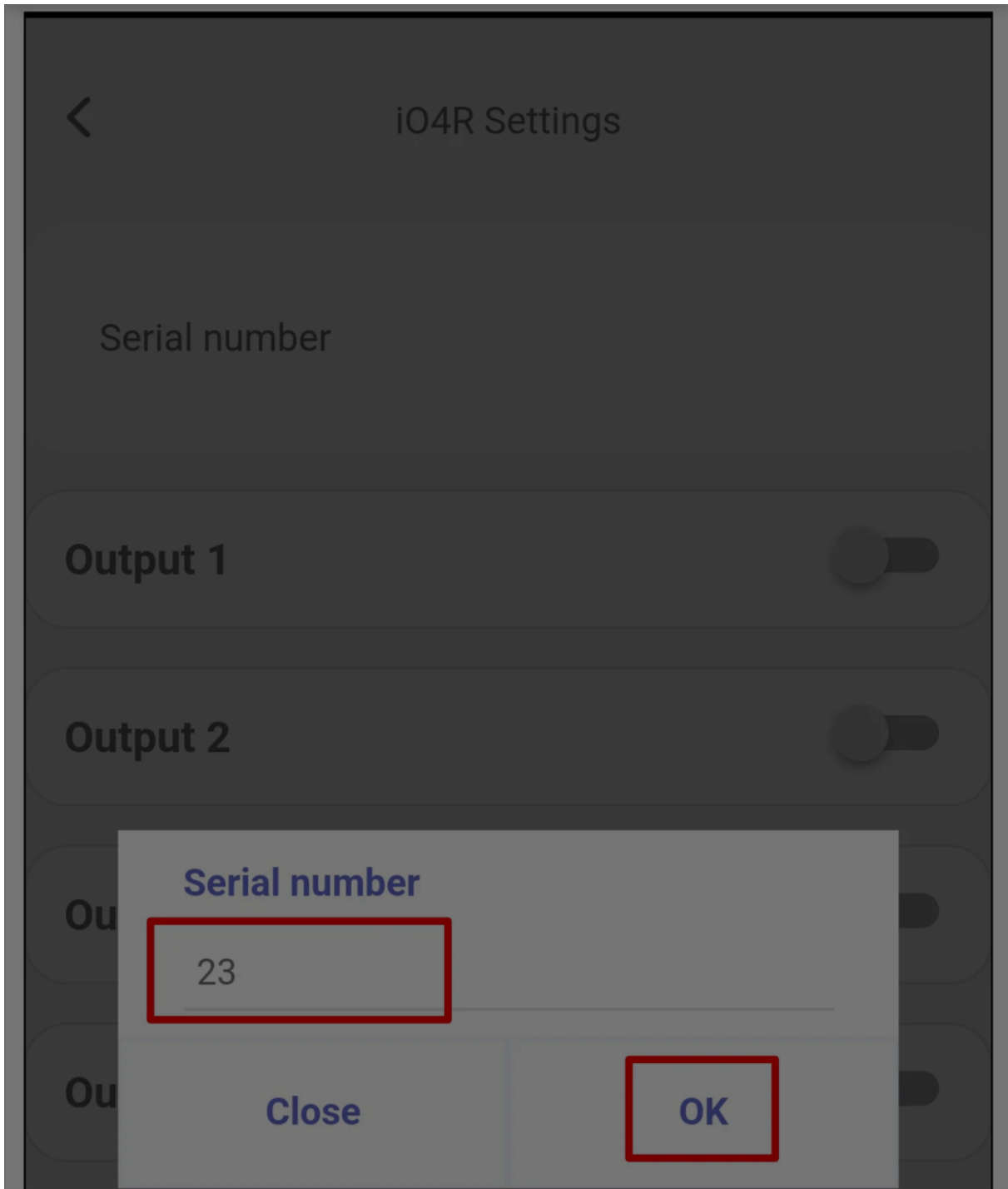

Cookie consent

We use cookies to measure the effectiveness of our documentation and whether users find what they're searching for. With your consent, you're helping us to make our documentation better.

Google Analytics



Cancel

Next

Paso 7. Para cada salida activada, defina el nombre y el icono, deje el **Type** de la salida como **Guard**, asigne la entrada iO4R correspondiente y defina el **Type** de la entrada según el cableado. En el ejemplo mostrado, el tipo de entrada es **NO**. Toque **Next**.

Cookie consent

We use cookies to measure the effectiveness of our documentation and whether users find what they're searching for. With your consent, you're helping us to make our documentation better.

Google Analytics



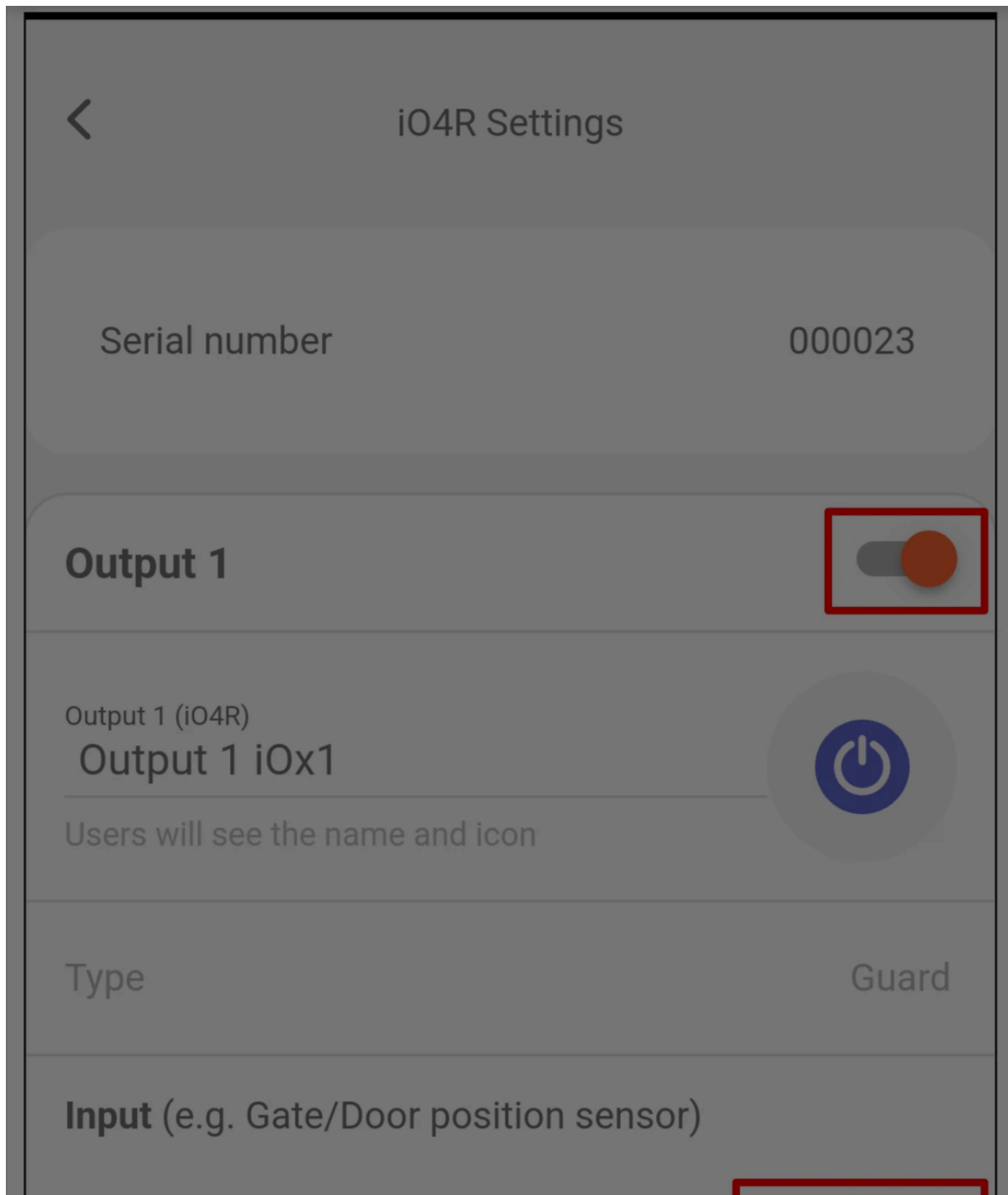

Cookie consent

We use cookies to measure the effectiveness of our documentation and whether users find what they're searching for. With your consent, you're helping us to make our documentation better.

Google Analytics

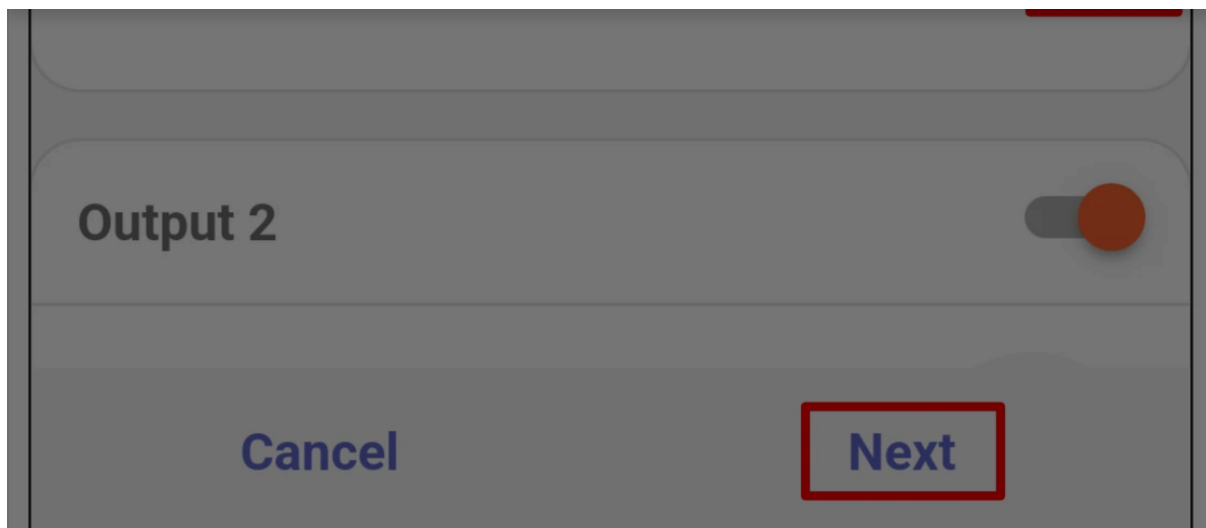

Paso 8. Espere mientras Protegus2 escribe los datos.

Cookie consent

We use cookies to measure the effectiveness of our documentation and whether users find what they're searching for. With your consent, you're helping us to make our documentation better.

Google Analytics





Restarting device

Connection succeeded

Preparation succeeded

Cookie consent

We use cookies to measure the effectiveness of our documentation and whether users find what they're searching for. With your consent, you're helping us to make our documentation better.

Google Analytics





Cancel

Paso 9. Toque **Next**.

Cookie consent

We use cookies to measure the effectiveness of our documentation and whether users find what they're searching for. With your consent, you're helping us to make our documentation better.

Google Analytics



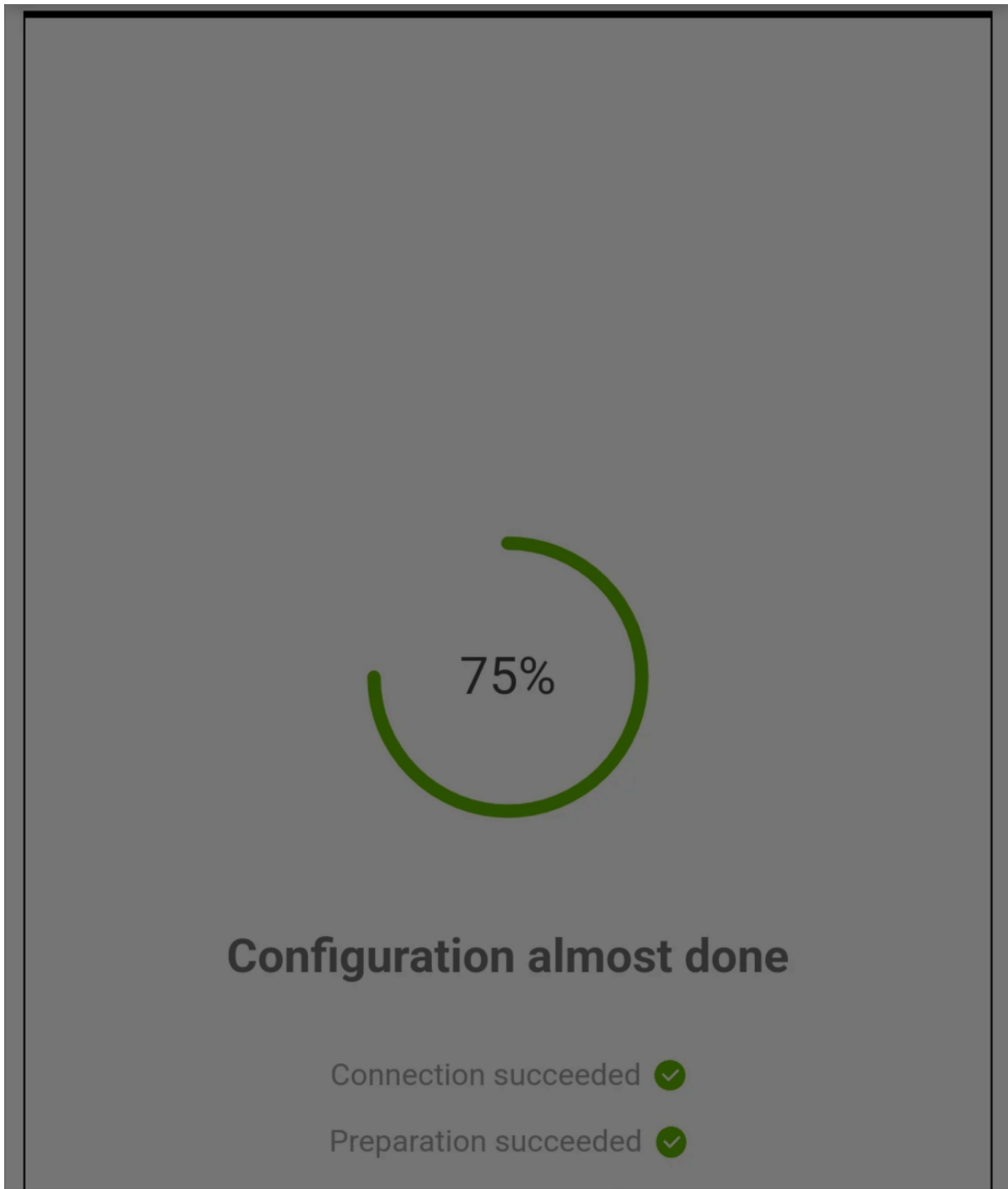

Cookie consent

We use cookies to measure the effectiveness of our documentation and whether users find what they're searching for. With your consent, you're helping us to make our documentation better.

Google Analytics





Advanced settings

Next

Paso 10. Introduzca el **Name** del sistema y toque **Next**.

Cookie consent

We use cookies to measure the effectiveness of our documentation and whether users find what they're searching for. With your consent, you're helping us to make our documentation better.

Google Analytics





Add new system

Name

Gator

Background



Time zone

Europe/Vilnius



Cookie consent

We use cookies to measure the effectiveness of our documentation and whether users find what they're searching for. With your consent, you're helping us to make our documentation better.

Google Analytics





Paso 11. Toque **Skip**, salvo que quiera añadir usuarios ahora.

Cookie consent

We use cookies to measure the effectiveness of our documentation and whether users find what they're searching for. With your consent, you're helping us to make our documentation better.

Google Analytics



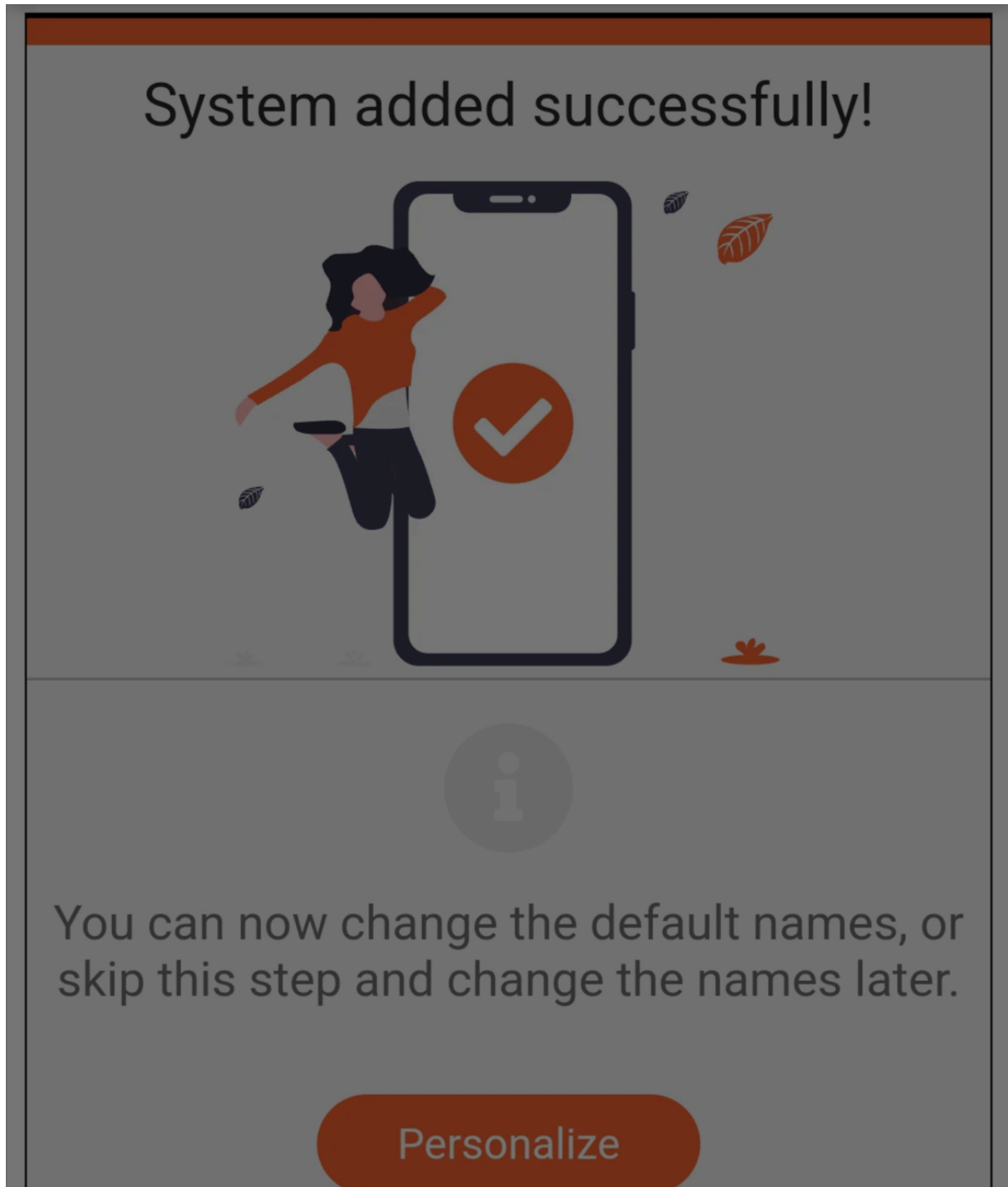

Cookie consent

We use cookies to measure the effectiveness of our documentation and whether users find what they're searching for. With your consent, you're helping us to make our documentation better.

Google Analytics



Skip

Paso 12. Espere aproximadamente 1 minuto hasta que finalice.

Cookie consent

We use cookies to measure the effectiveness of our documentation and whether users find what they're searching for. With your consent, you're helping us to make our documentation better.

Google Analytics



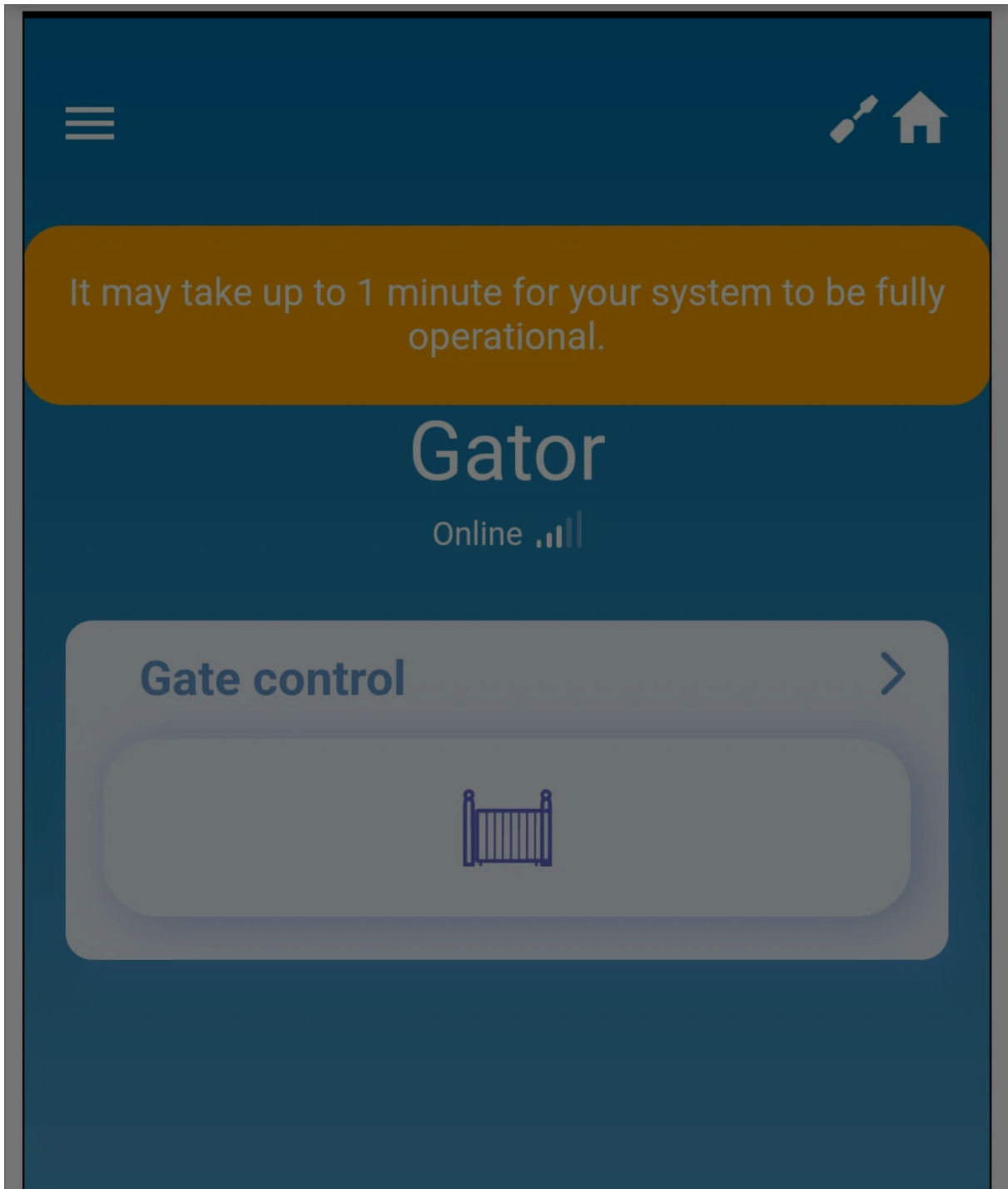

Cookie consent

We use cookies to measure the effectiveness of our documentation and whether users find what they're searching for. With your consent, you're helping us to make our documentation better.

Google Analytics



4. Transferir el sistema al usuario

Cuando la configuración esté completa, transfiera el sistema a la cuenta Protegus2 del usuario.

Paso 13. Toque **Menu**.

Cookie consent

We use cookies to measure the effectiveness of our documentation and whether users find what they're searching for. With your consent, you're helping us to make our documentation better.

Google Analytics



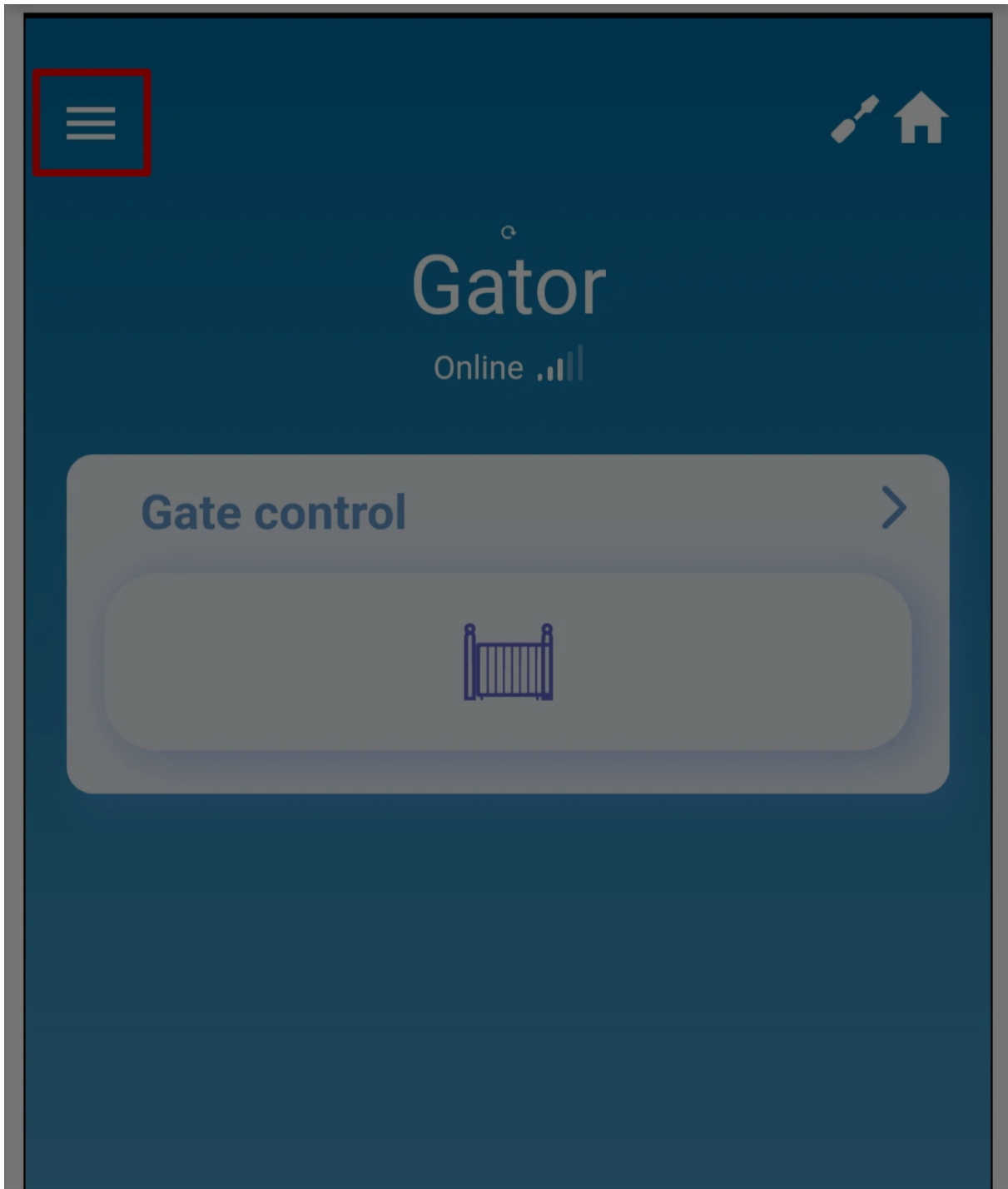

Cookie consent

We use cookies to measure the effectiveness of our documentation and whether users find what they're searching for. With your consent, you're helping us to make our documentation better.

Google Analytics





Paso 14. Toque **Settings**.

Cookie consent

We use cookies to measure the effectiveness of our documentation and whether users find what they're searching for. With your consent, you're helping us to make our documentation better.

Google Analytics



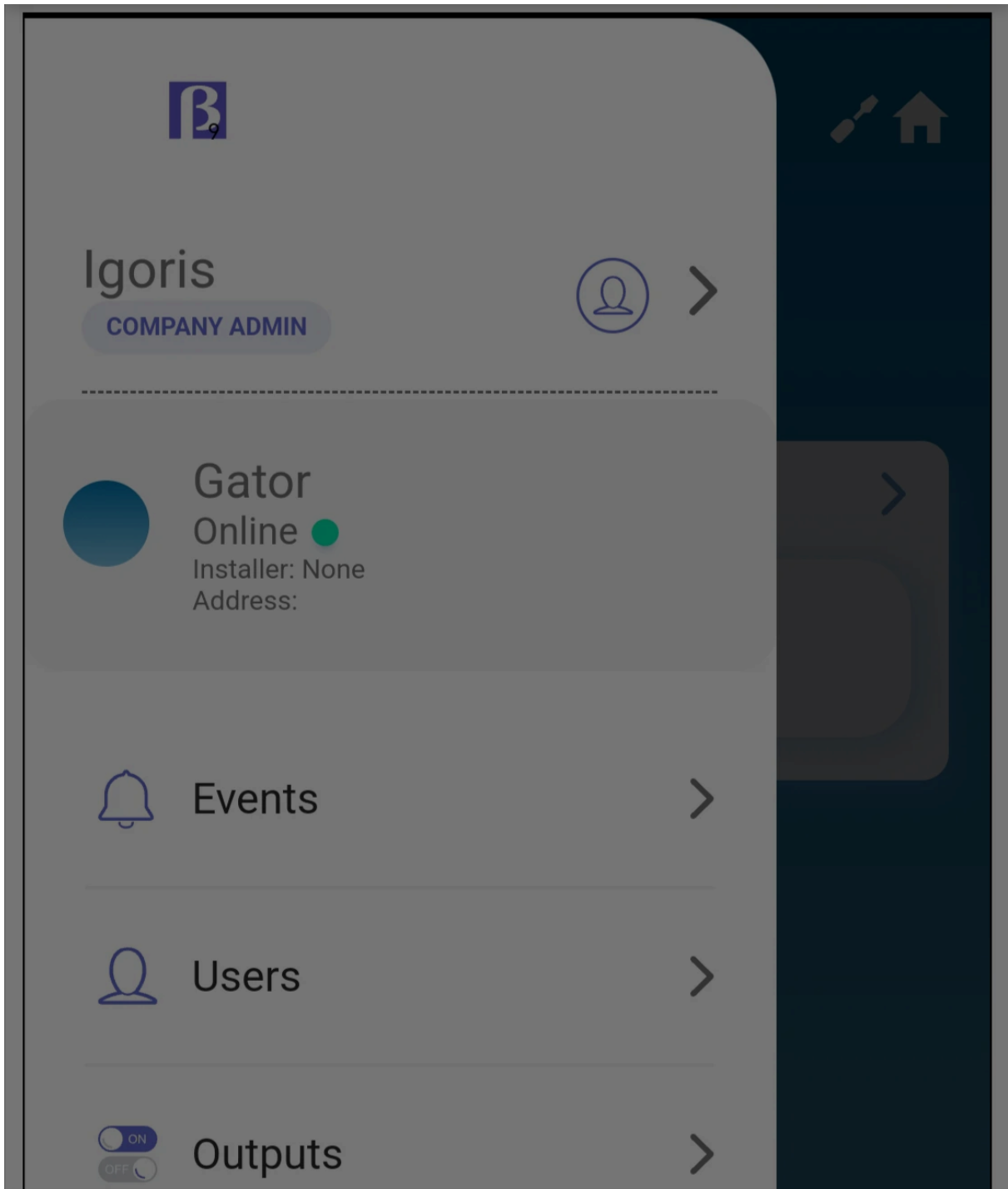

Cookie consent

We use cookies to measure the effectiveness of our documentation and whether users find what they're searching for. With your consent, you're helping us to make our documentation better.

Google Analytics

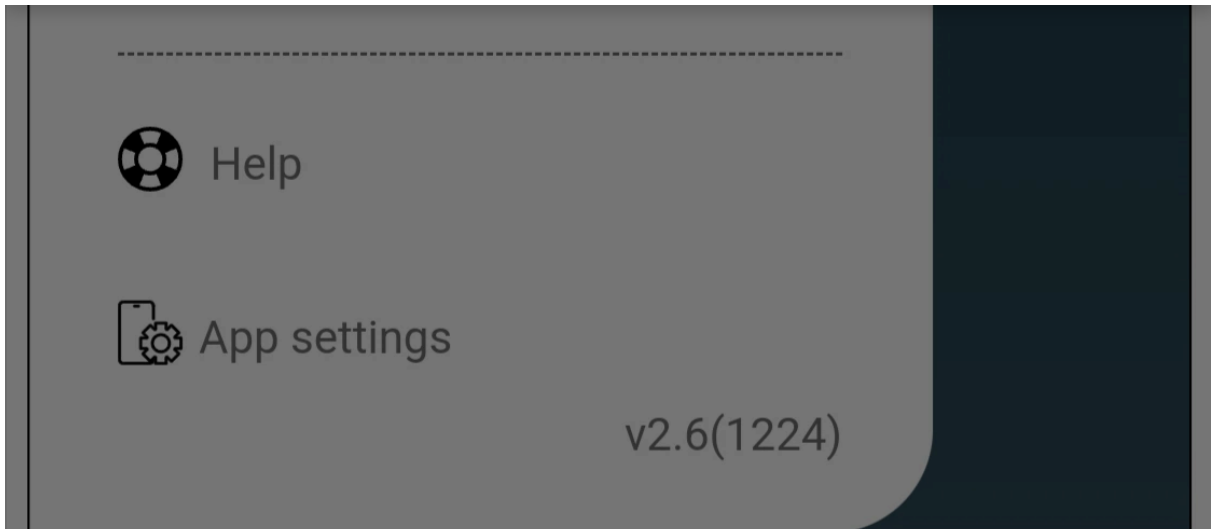

Paso 15. Toque **Transfer system**.

Cookie consent

We use cookies to measure the effectiveness of our documentation and whether users find what they're searching for. With your consent, you're helping us to make our documentation better.

Google Analytics



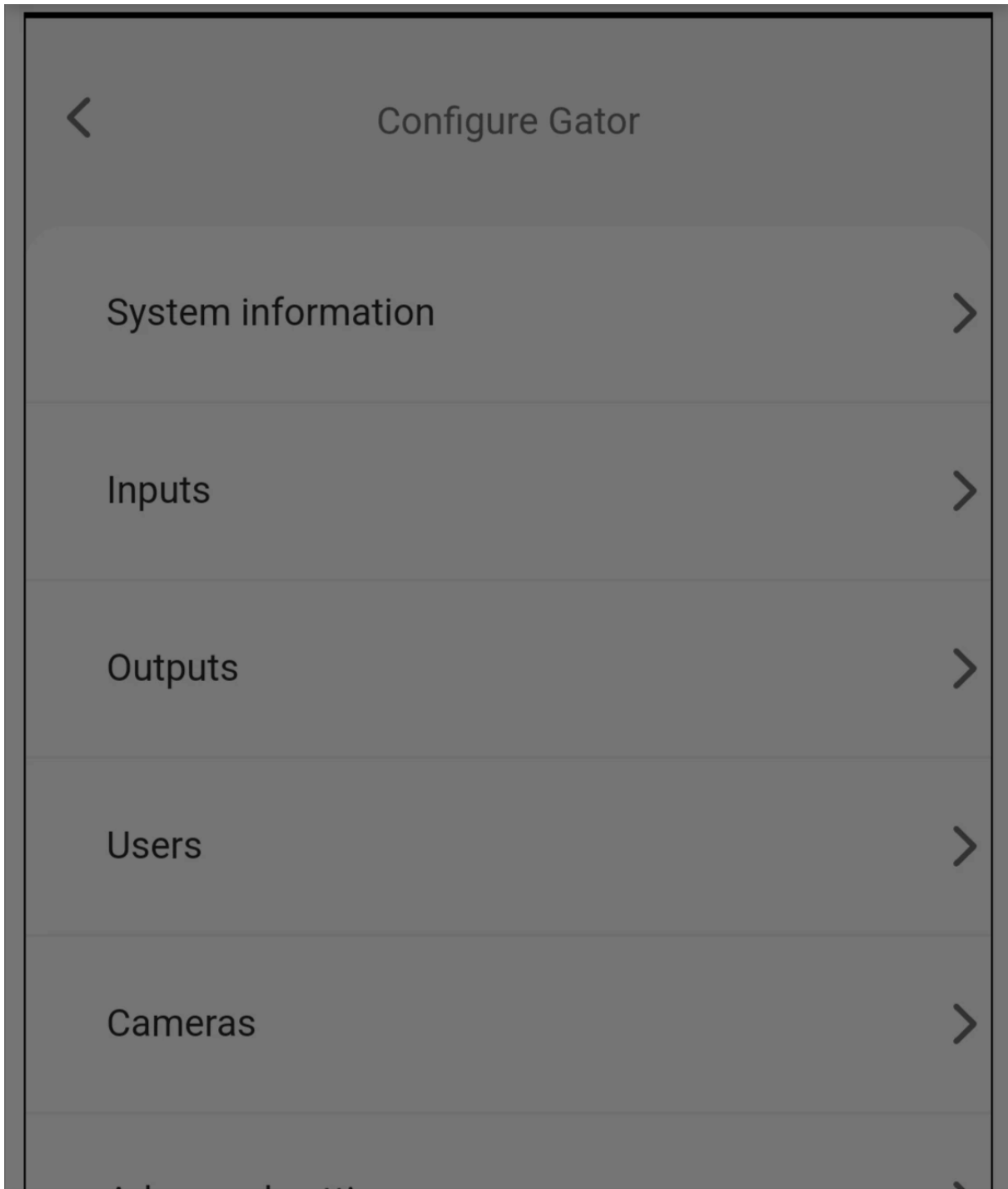

Cookie consent

We use cookies to measure the effectiveness of our documentation and whether users find what they're searching for. With your consent, you're helping us to make our documentation better.

Google Analytics



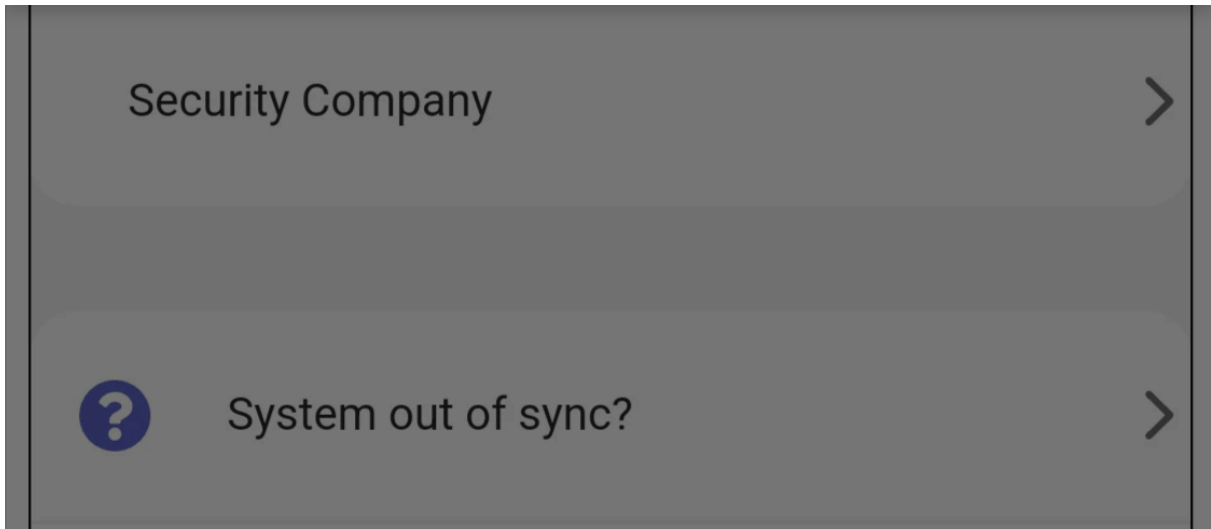

Paso 16. Introduzca la dirección de correo electrónico del usuario y toque **Transfer**.

Cookie consent

We use cookies to measure the effectiveness of our documentation and whether users find what they're searching for. With your consent, you're helping us to make our documentation better.

Google Analytics



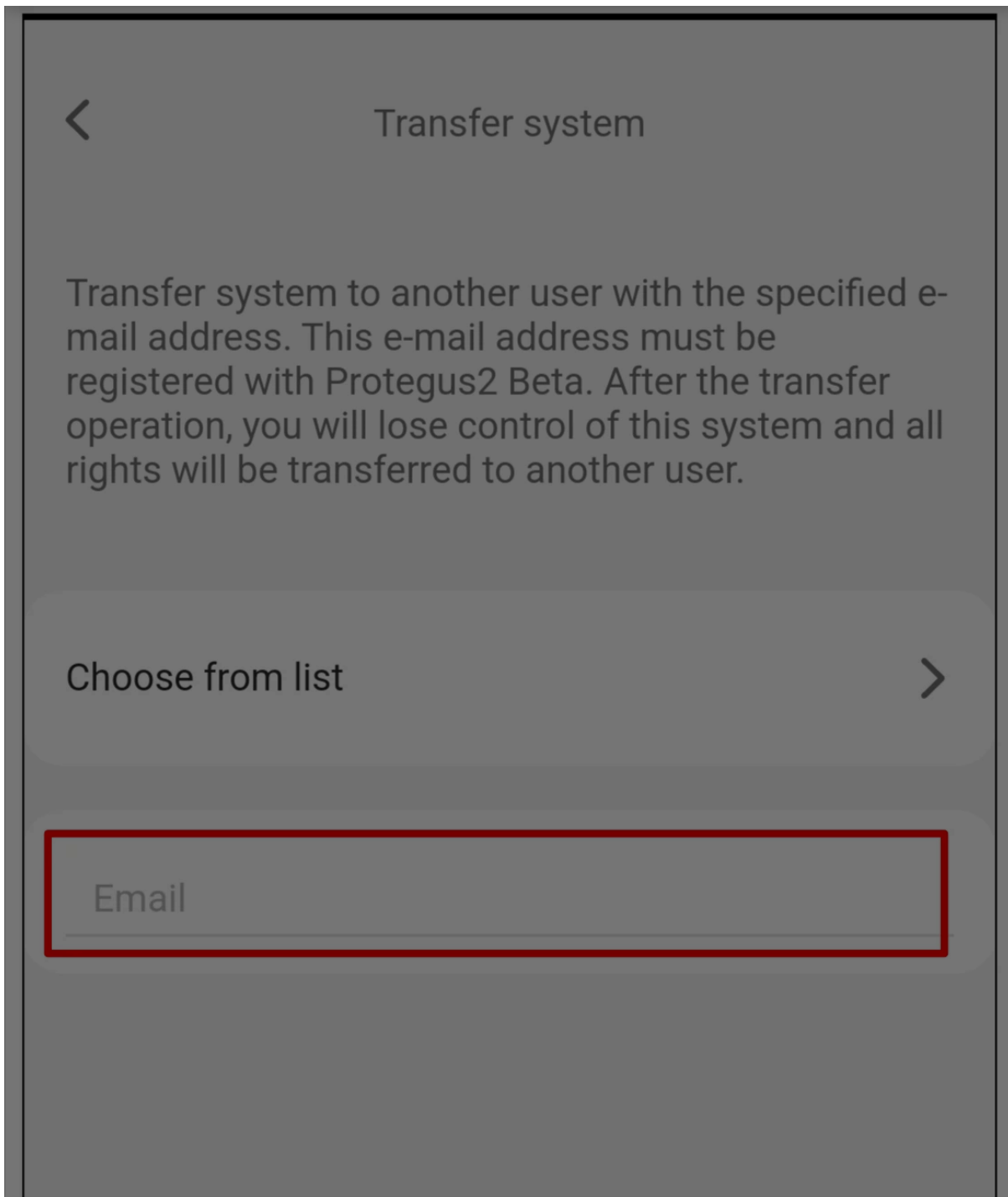

Cookie consent

We use cookies to measure the effectiveness of our documentation and whether users find what they're searching for. With your consent, you're helping us to make our documentation better.

Google Analytics





5. Comprobar la monitorización y el control de la puerta

El usuario debe iniciar sesión en Protegus2 con su cuenta después de la transferencia.

ADVERTENCIA

Anular un sensor de seguridad de puerta puede desactivar la protección de seguridad. Use la anulación solo como una acción de servicio temporal y autorizada, y restablezca el funcionamiento normal del sensor antes de dejar la instalación en servicio.

Transfer

Paso 17. Toque **Gate control** para ver el contador de ciclos de la puerta.

Cookie consent

We use cookies to measure the effectiveness of our documentation and whether users find what they're searching for. With your consent, you're helping us to make our documentation better.

Google Analytics

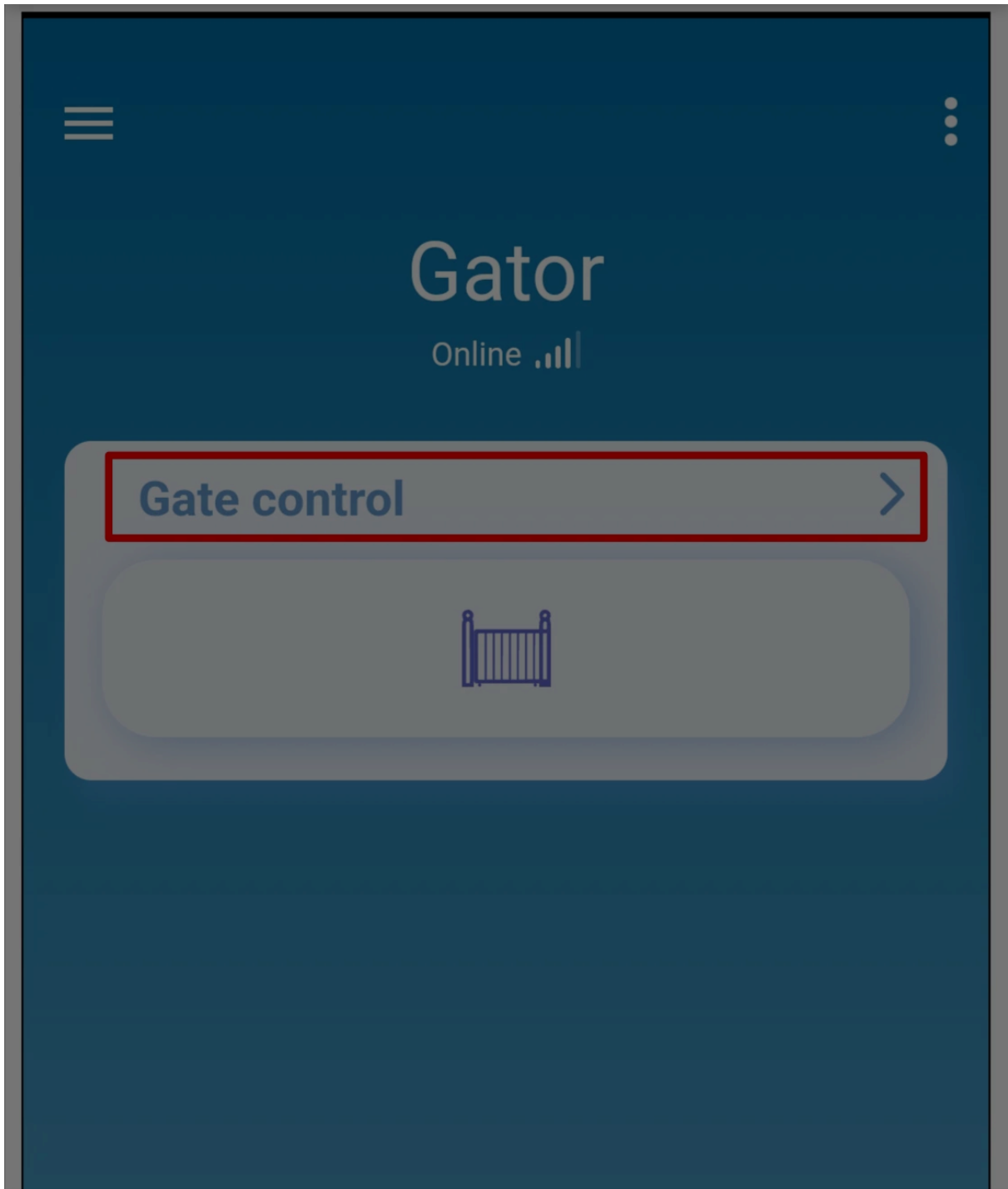

Cookie consent

We use cookies to measure the effectiveness of our documentation and whether users find what they're searching for. With your consent, you're helping us to make our documentation better.

Google Analytics





Paso 18. Revise **Total cycles** y **Cycles to maintenance**. Si un instalador autorizado necesita inspeccionar el estado de los sensores de seguridad, toque **Input status**.

Cookie consent

We use cookies to measure the effectiveness of our documentation and whether users find what they're searching for. With your consent, you're helping us to make our documentation better.

Google Analytics



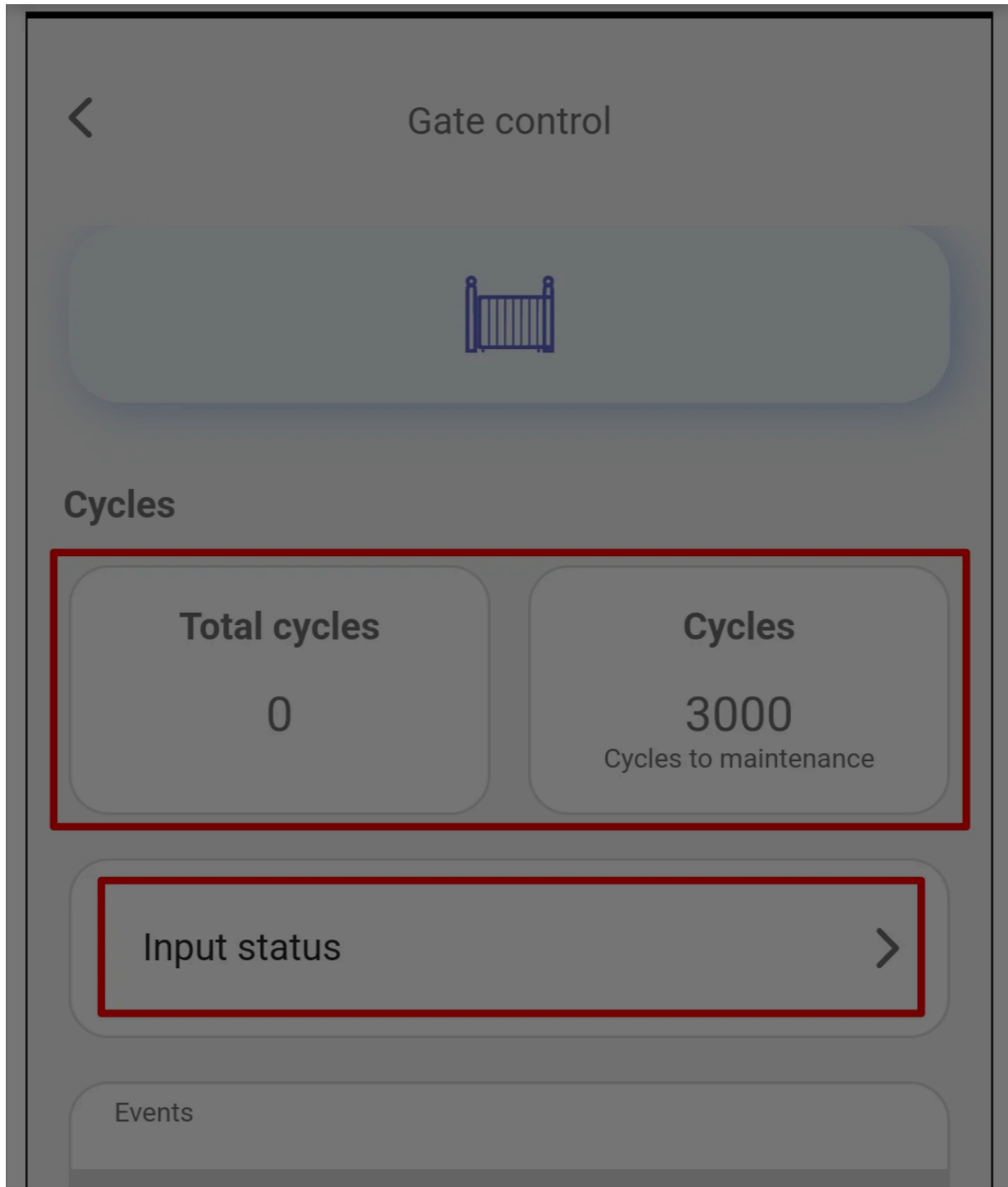

Cookie consent

We use cookies to measure the effectiveness of our documentation and whether users find what they're searching for. With your consent, you're helping us to make our documentation better.

Google Analytics



Paso 19. Use **Input status / bypass** solo cuando se haya comprobado un sensor de seguridad y la anulación sea necesaria temporalmente.

Cookie consent

We use cookies to measure the effectiveness of our documentation and whether users find what they're searching for. With your consent, you're helping us to make our documentation better.

Google Analytics

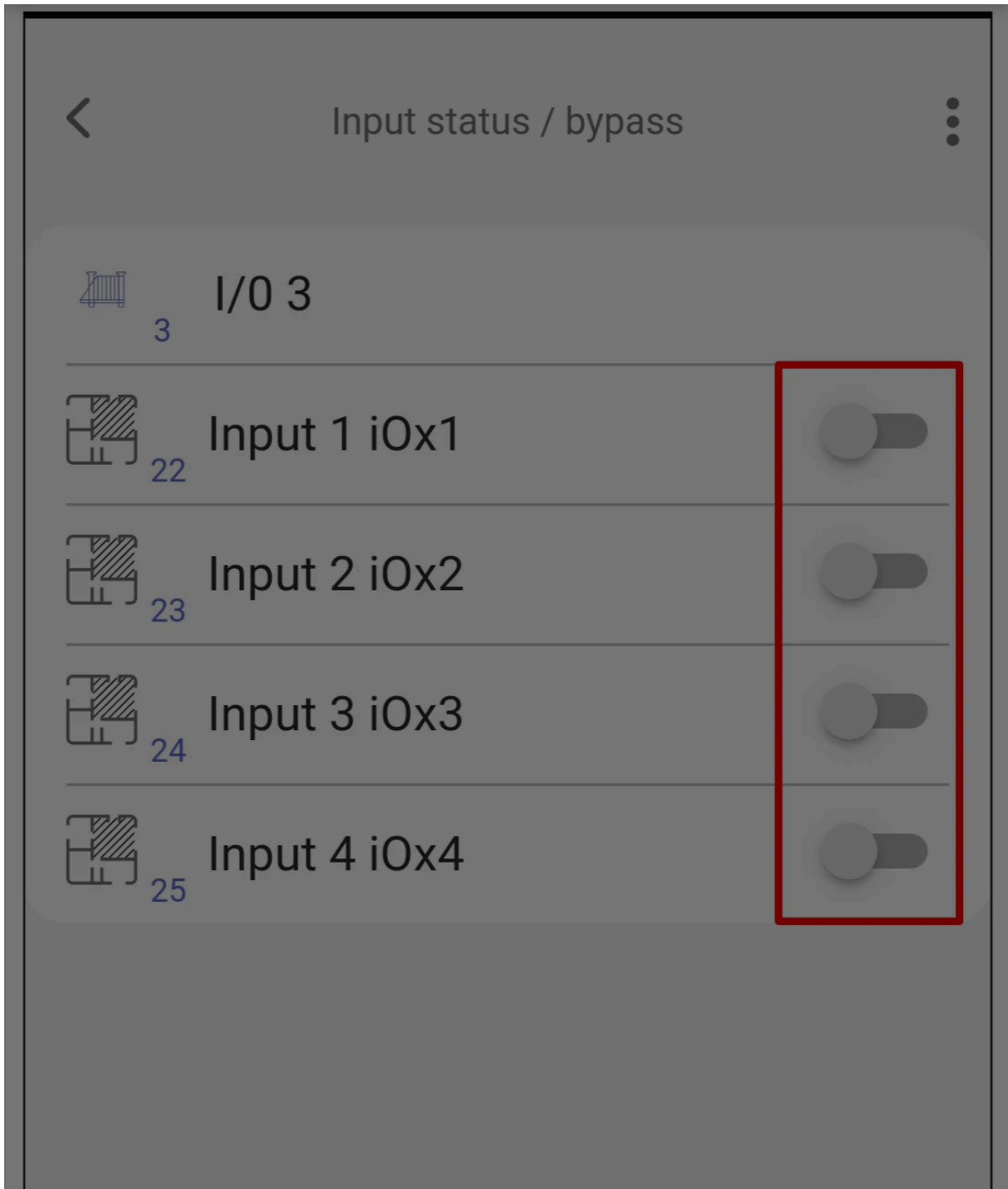

Cookie consent

We use cookies to measure the effectiveness of our documentation and whether users find what they're searching for. With your consent, you're helping us to make our documentation better.

Google Analytics



Paso 20. Toque el icono de control de puerta para abrir la puerta.

Cookie consent

We use cookies to measure the effectiveness of our documentation and whether users find what they're searching for. With your consent, you're helping us to make our documentation better.

Google Analytics



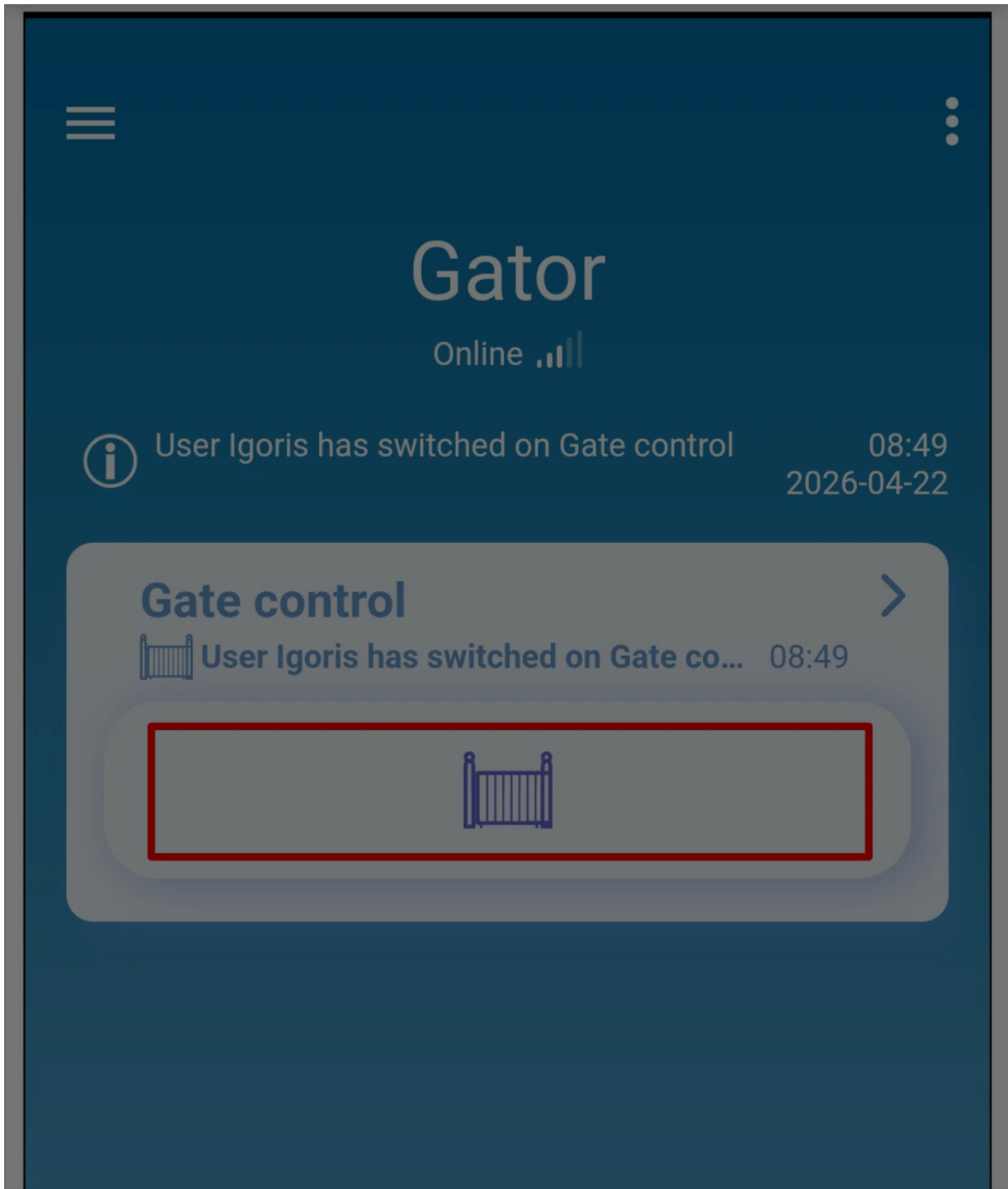

Cookie consent

We use cookies to measure the effectiveness of our documentation and whether users find what they're searching for. With your consent, you're helping us to make our documentation better.

- Google Analytics





6. Comprobación del sistema

1. Abra y cierre la puerta completamente y confirme que el contador de ciclos cambia como se espera.
2. Active cada entrada iO4R monitorizada y confirme que el estado de la entrada cambia en Protegus2.
3. Pruebe el icono de control de puerta y confirme que el operador de puerta responde correctamente.

Cookie consent

We use cookies to measure the effectiveness of our documentation and whether users find what they're searching for. With your consent, you're helping us to make our documentation better.

Google Analytics

