

VALDIKLIAI

GATOR LTE ir GATOR WiFi su iO4R greitas paruošimas

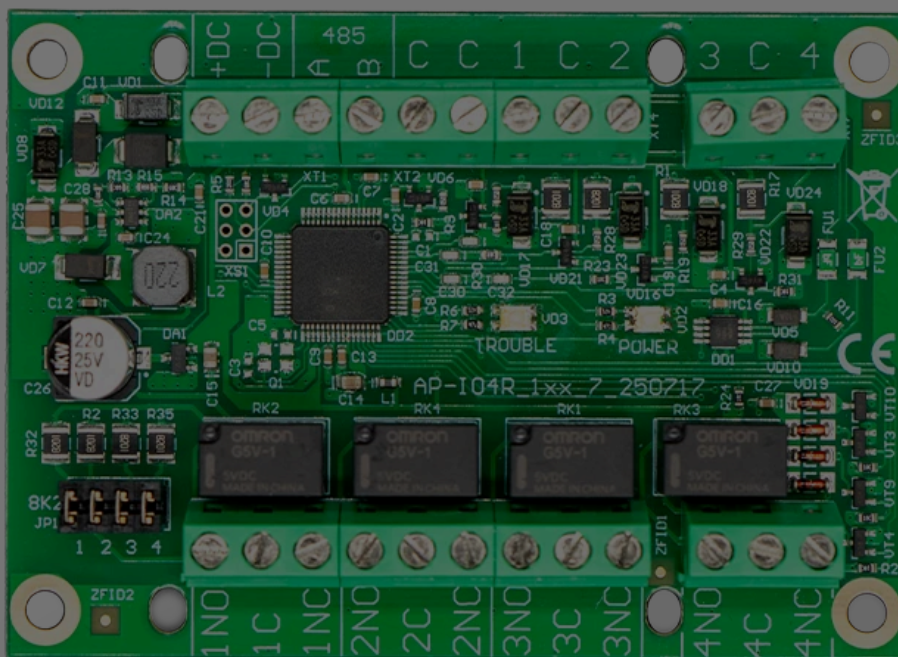

Trumpi prijungimo ir Protegus2 programavimo žingsniai, kaip prijungti iO4R plėtiklį prie GATOR LTE arba GATOR WiFi vartų valdiklio. Kitus montavimo ir konfigūravimo nustatymus rasite pilnuose GATOR ir GATOR WiFi vadovuose.

iO4R naudojamas pažangesniam vartų stebėjimui. Jis prideda stebimus apsaugos jutiklių Guard įėjimus ir leidžia įgaliotam specialistui laikinai apeiti jutiklio gedimą, kol bus atlikta techninė priežiūra. Protegus2 taip pat skaičiuoja pilnus vartų atidarymo ir uždarymo ciklus ir įspėja, kai reikia atlikti techninę priežiūrą. Tai padeda neplanuotus iškvietimus pakeisti suplanuotais aptarnavimo vizitais ir pasikartojančiomis priežiūros sutartimis.

Cookie consent

We use cookies to measure the effectiveness of our documentation and whether users find what they're searching for. With your consent, you're helping us to make our documentation better.

Google Analytics

Accept

Reject



1. Būtinios sąlygos

- Paruoštas GATOR LTE arba GATOR WiFi vartų valdiklis. Jungiant laidus maitinimas turi būti atjungtas.
- iO4R plėtiklio serijos numeris.
- Protegus2 įmonės arba montuotojo paskyra ir valdiklio IMEI / Unique ID.
- Vartų būsenos jutiklis prijungtas prie valdiklio vartų padėties įėjimo.
- Vartų apsaugos jutikliai prijungti per iO4R plėtiklį, jeigu jie bus stebimi arba laikinai apeinami Protegus2 programoje.

2. Laidų prijungimas

Prijunkite iO4R plėtiklį prie valdiklio RS485 magistralės ir maitinimo gnybtų, kaip parodyta žemiau.

PASTABA

Schemoje parodyti GATOR LTE gnybtų pavadinimai. GATOR WiFi valdiklyje naudokite atitinkamus +DC, -DC, A RS485 ir B RS485 gnybtus iš GATOR WiFi vadovo.

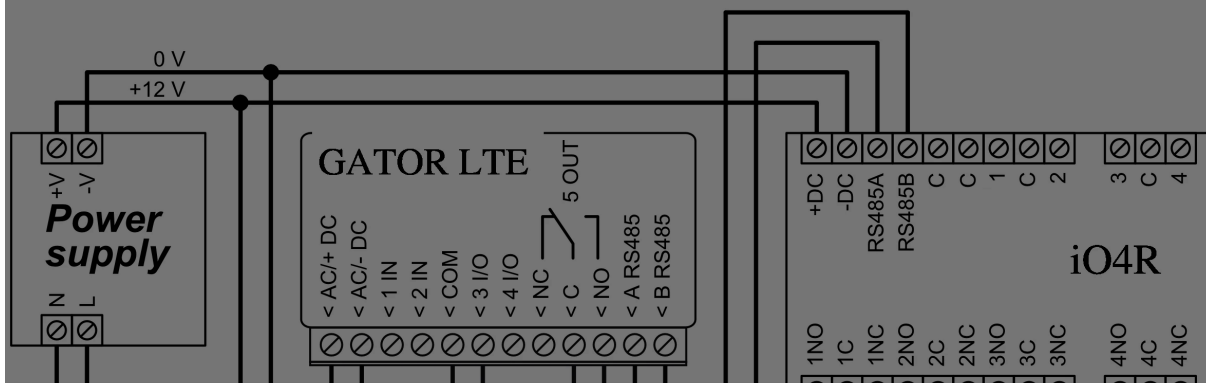

Cookie consent

We use cookies to measure the effectiveness of our documentation and whether users find what they're searching for. With your consent, you're helping us to make our documentation better.

Google Analytics



SVARBU

Protegeus2 stebėjimo sąrankoje I/O 3 rezervuotas vartų padėčiai ir ciklų skaičiavimui. Jo neperkonfigūruokite. Įėjimai IN1 ir IN2 rezervuoti Wiegand.

3. Valdiklio ir iO4R pridėjimas Protegeus2 programoje

Prisijunkite prie Protegeus2 naudodami įmonės arba montuotojo paskyrą, tada pridėkite valdiklį.

1 žingsnis. Paspauskite **Add new system**.

Cookie consent

We use cookies to measure the effectiveness of our documentation and whether users find what they're searching for. With your consent, you're helping us to make our documentation better.

Google Analytics



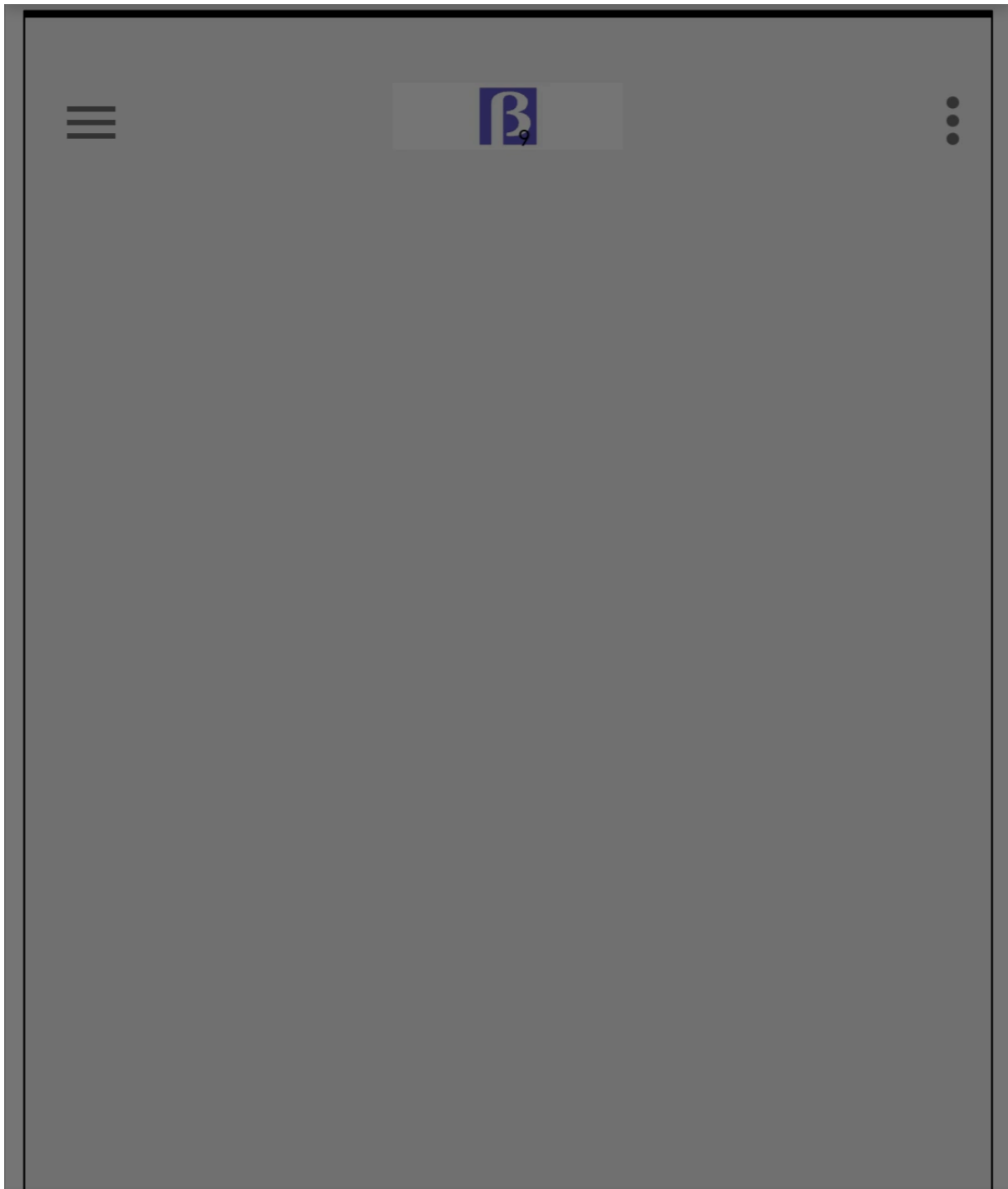

Cookie consent

We use cookies to measure the effectiveness of our documentation and whether users find what they're searching for. With your consent, you're helping us to make our documentation better.

Google Analytics





2 žingsnis. Įveskite valdiklio **IMEI**, tada paspauskite **Next**.

Cookie consent

We use cookies to measure the effectiveness of our documentation and whether users find what they're searching for. With your consent, you're helping us to make our documentation better.

Google Analytics



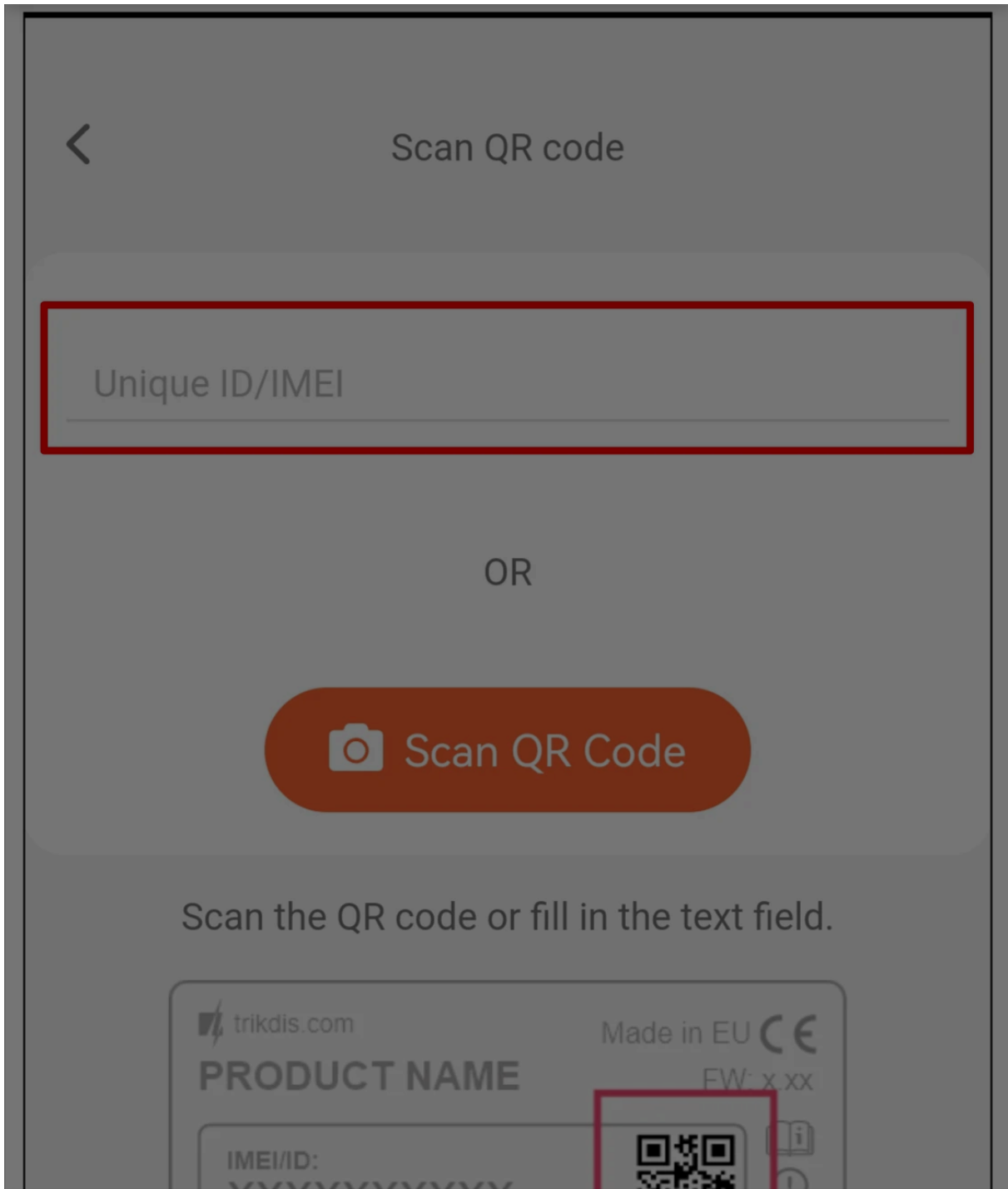

Cookie consent

We use cookies to measure the effectiveness of our documentation and whether users find what they're searching for. With your consent, you're helping us to make our documentation better.

Google Analytics



Cancel

Next

3 žingsnis. Pasirinkite **Advanced Gator Monitoring**, tada paspauskite **Next**.

Cookie consent

We use cookies to measure the effectiveness of our documentation and whether users find what they're searching for. With your consent, you're helping us to make our documentation better.

Google Analytics



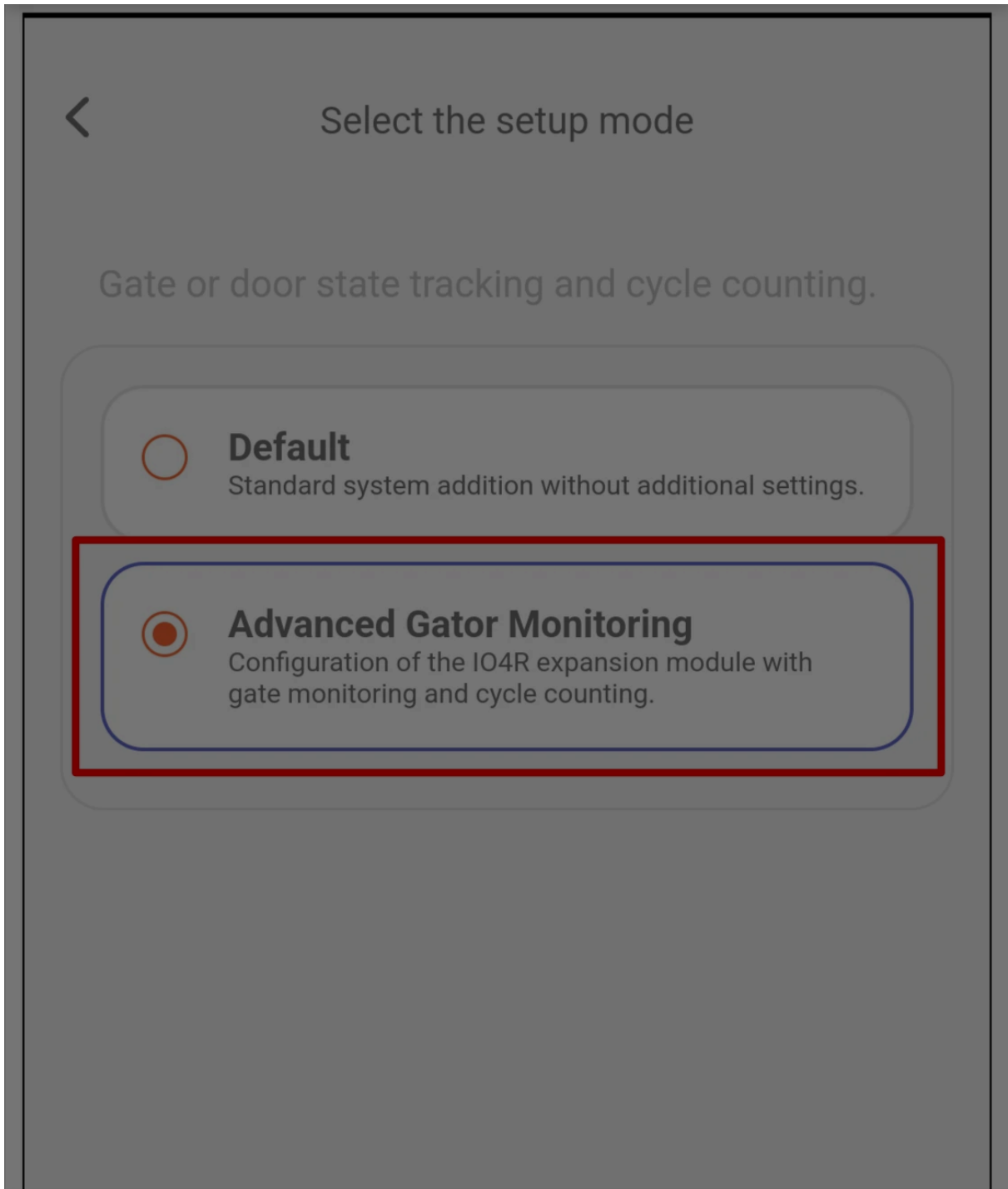

Cookie consent

We use cookies to measure the effectiveness of our documentation and whether users find what they're searching for. With your consent, you're helping us to make our documentation better.

Google Analytics



Cancel

Next

4 žingsnis. Nustatykite **Cycles** skaičių, po kurio bus reikalinga techninė priežiūra, tada paspauskite **Next**.

Cookie consent

We use cookies to measure the effectiveness of our documentation and whether users find what they're searching for. With your consent, you're helping us to make our documentation better.

Google Analytics



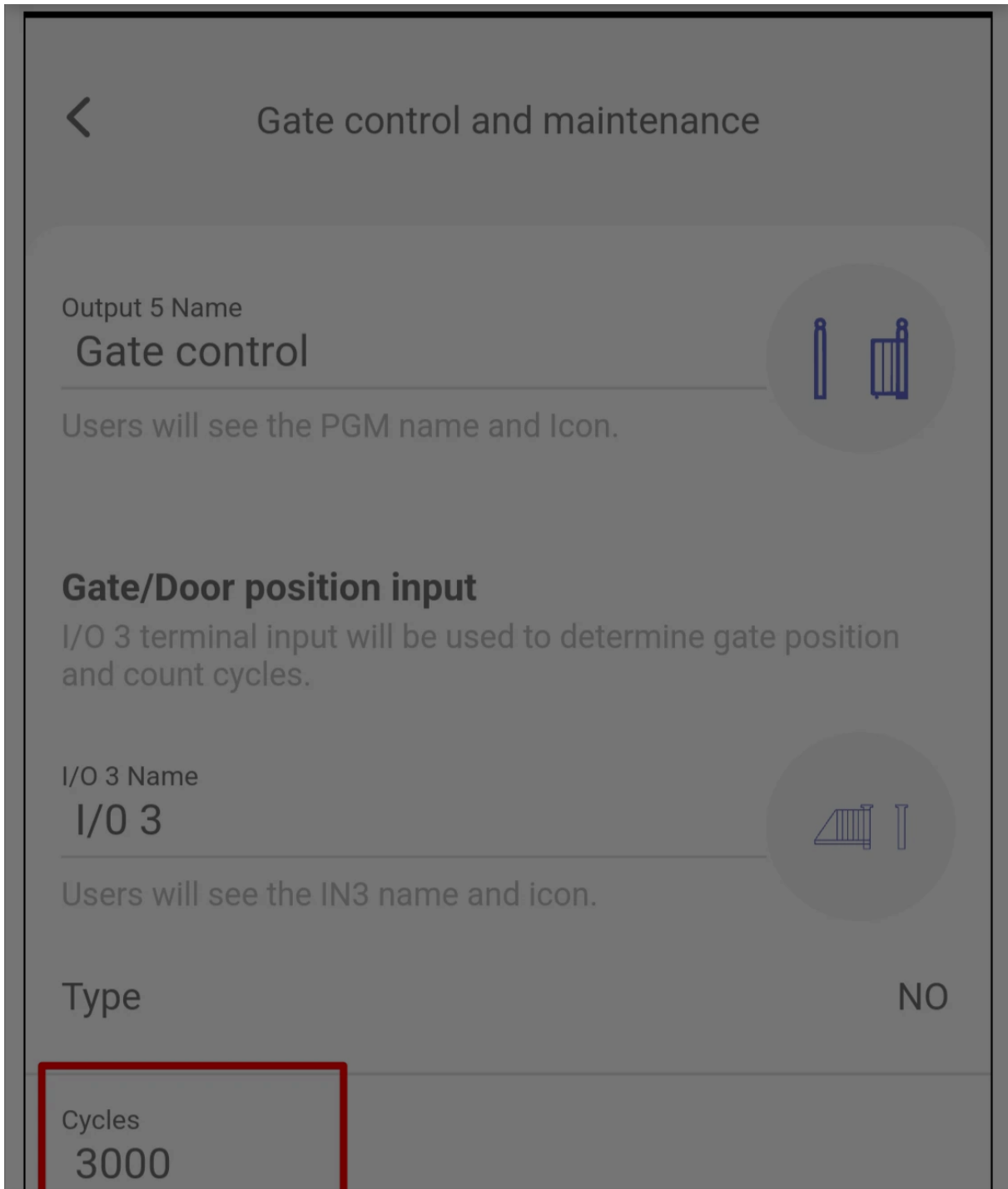

Cookie consent

We use cookies to measure the effectiveness of our documentation and whether users find what they're searching for. With your consent, you're helping us to make our documentation better.

Google Analytics



Output 3 uses the 3 input (I/O 3) to track state and count full opening and closing cycles.

Note: IN3 (I/O 3) is used for cycle counting and cannot be changed. IN1/IN2 are reserved for Wiegand.

Cancel

Next

5 žingsnis. Įjunkite kiekvieną iO4R išėjimą, kuris prijungtas prie stebimo apsaugos jutiklio arba būsenos grandinės.

Cookie consent

We use cookies to measure the effectiveness of our documentation and whether users find what they're searching for. With your consent, you're helping us to make our documentation better.

Google Analytics



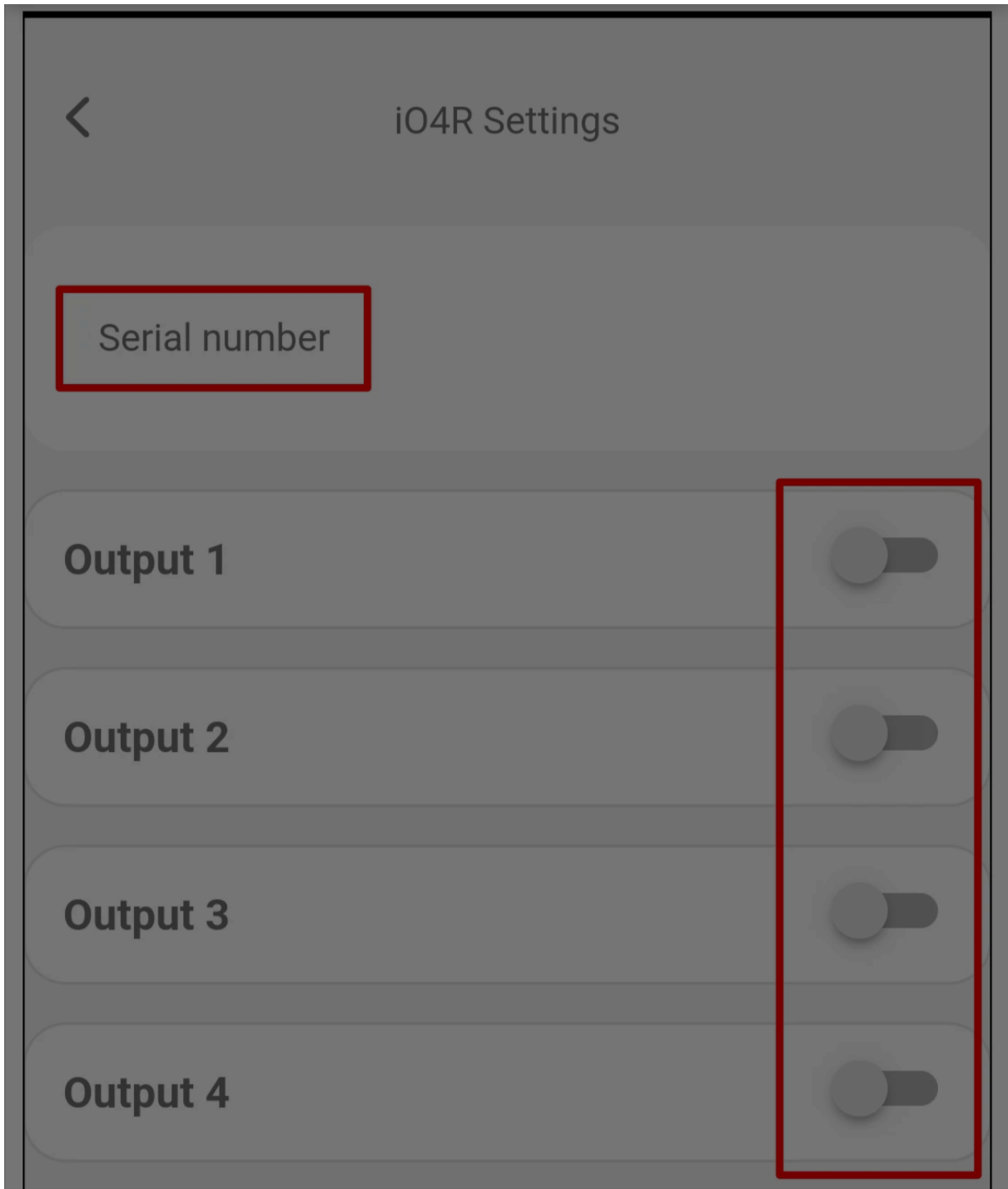

Cookie consent

We use cookies to measure the effectiveness of our documentation and whether users find what they're searching for. With your consent, you're helping us to make our documentation better.

Google Analytics



Cancel

Next

6 žingsnis. Įveskite iO4R **Serial number**, tada paspauskite **OK**.

Cookie consent

We use cookies to measure the effectiveness of our documentation and whether users find what they're searching for. With your consent, you're helping us to make our documentation better.

Google Analytics



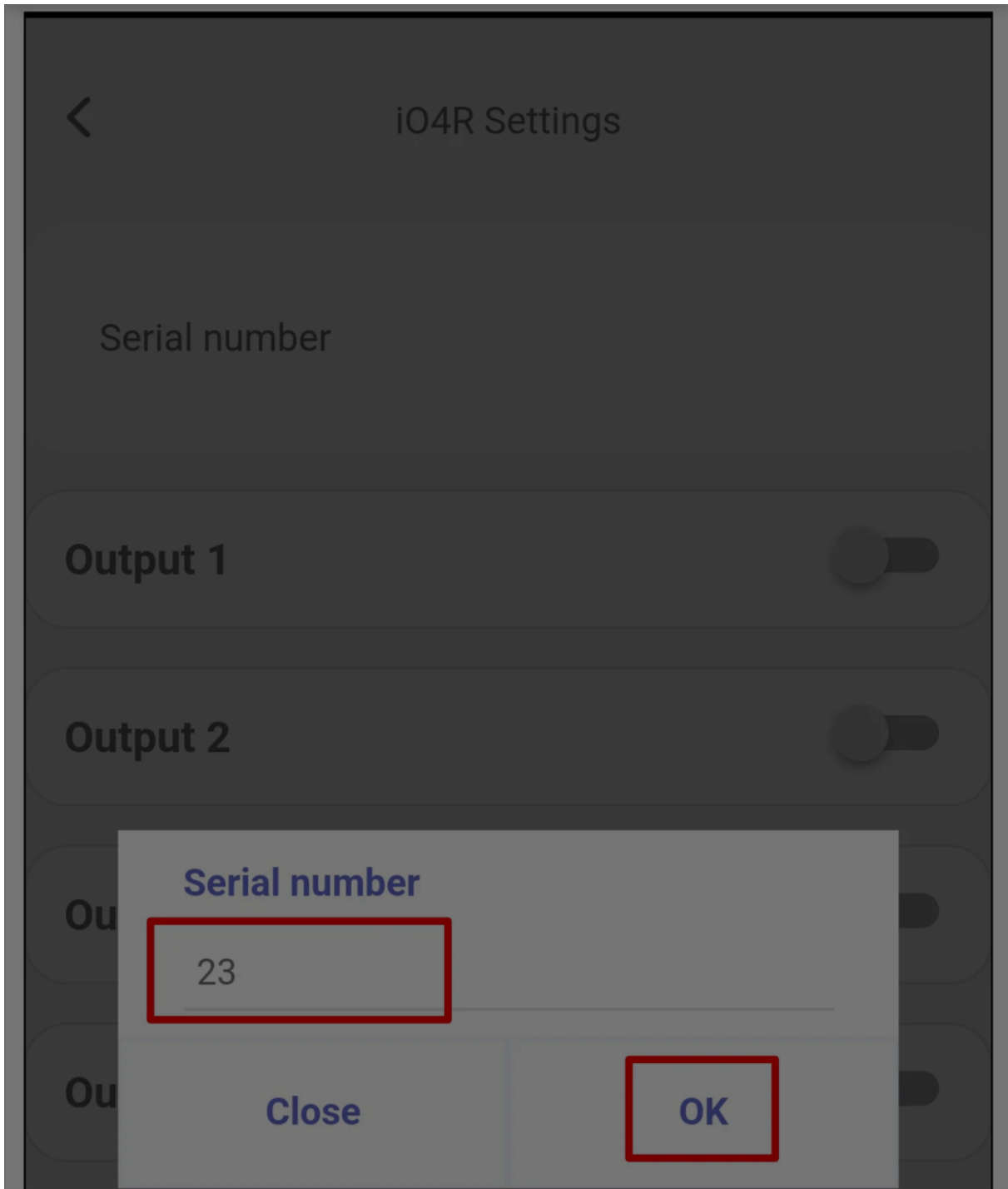

Cookie consent

We use cookies to measure the effectiveness of our documentation and whether users find what they're searching for. With your consent, you're helping us to make our documentation better.

Google Analytics



Cancel

Next

7 žingsnis. Kiekvienam įjungtam išėjimui nustatykite pavadinimą ir piktogramą, išėjimo **Type** palikite **Guard**, priskirkite atitinkamą iO4R įėjimą ir įėjimo **Type** nustatykite pagal laidų prijungimą. Pavyzdyje parodytas įėjimo tipas yra **NO**. Paspauskite **Next**.

Cookie consent

We use cookies to measure the effectiveness of our documentation and whether users find what they're searching for. With your consent, you're helping us to make our documentation better.

Google Analytics



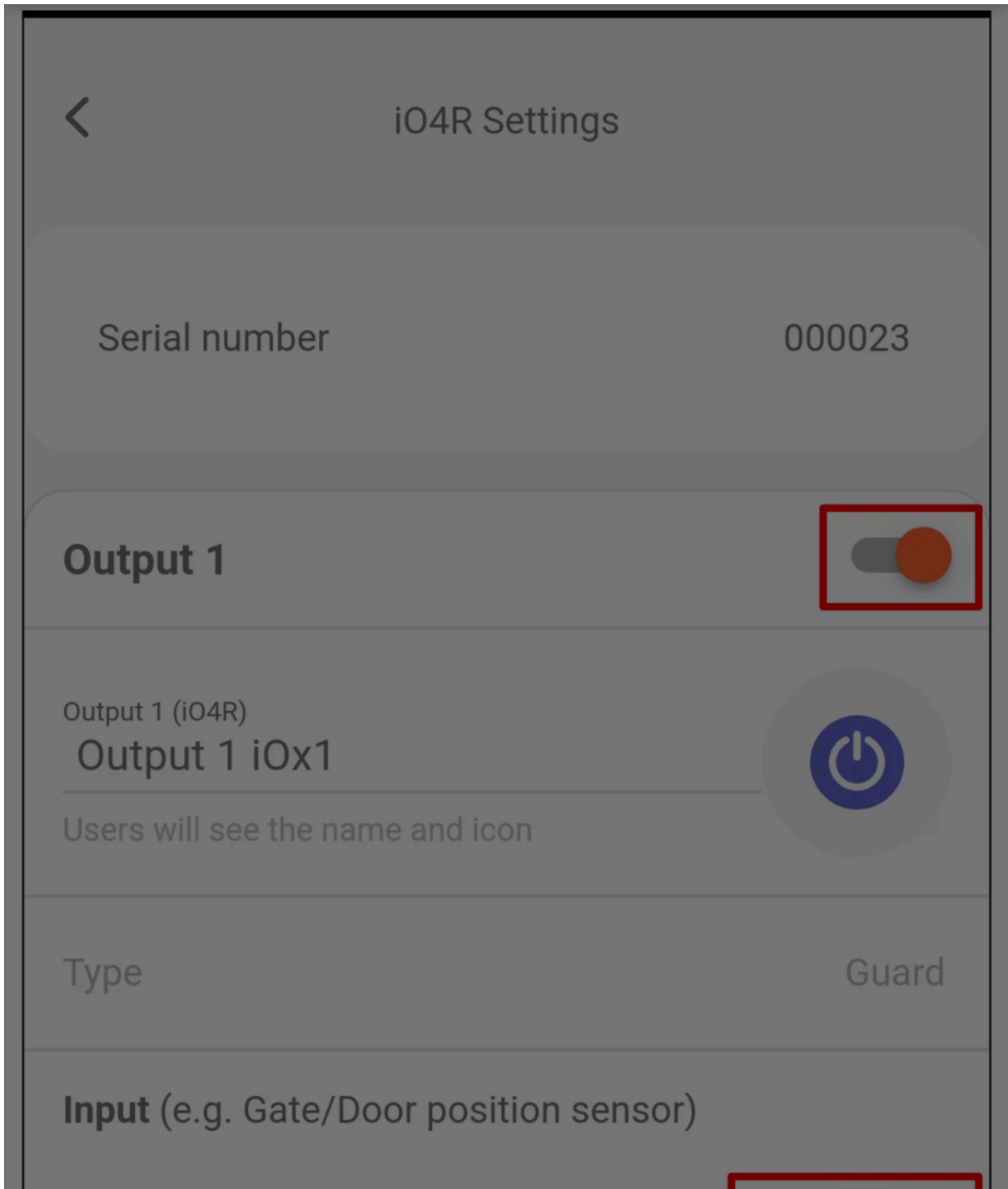

Cookie consent

We use cookies to measure the effectiveness of our documentation and whether users find what they're searching for. With your consent, you're helping us to make our documentation better.

Google Analytics

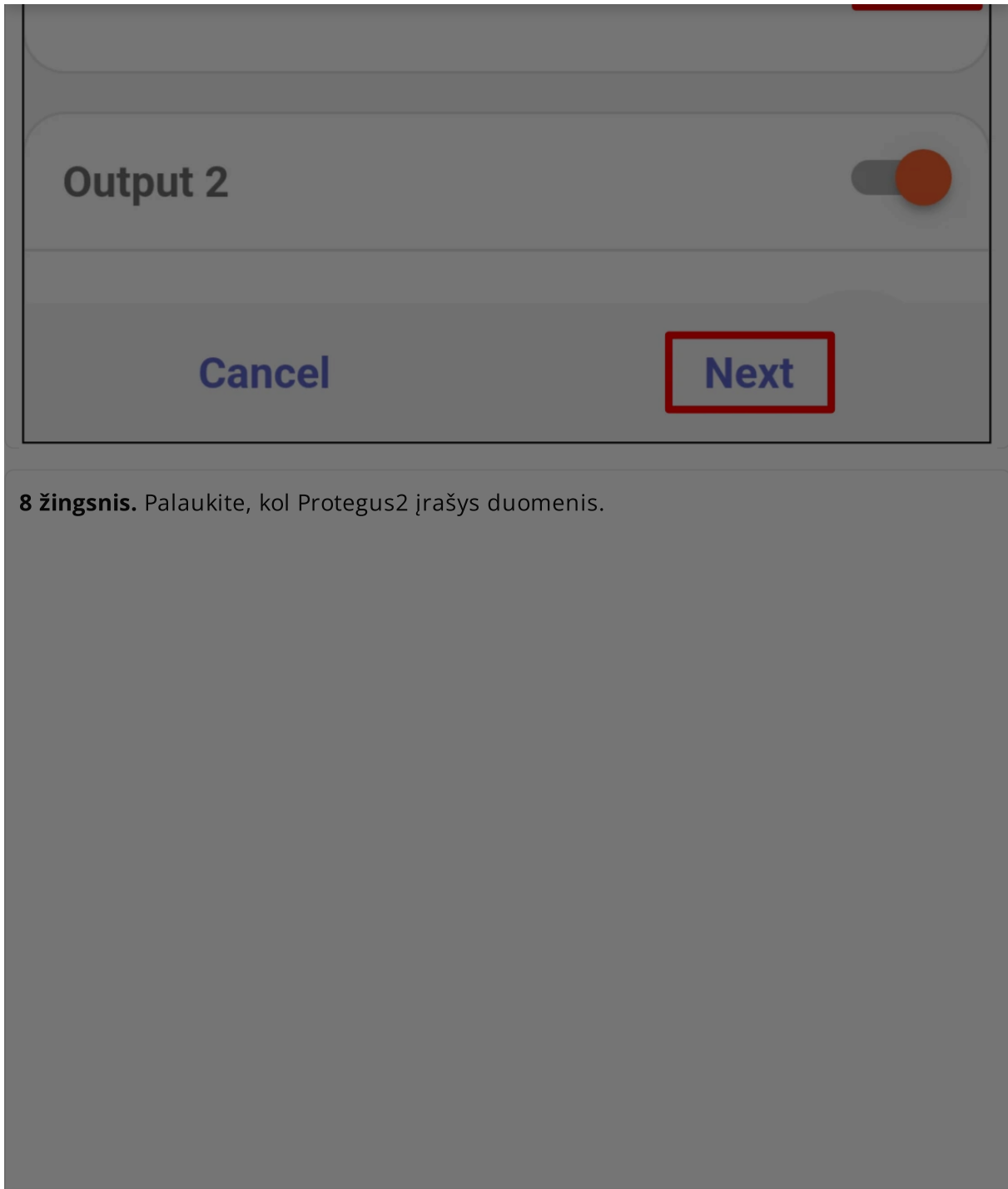

Cookie consent

We use cookies to measure the effectiveness of our documentation and whether users find what they're searching for. With your consent, you're helping us to make our documentation better.

Google Analytics





Restarting device

Connection succeeded

Preparation succeeded

Cookie consent

We use cookies to measure the effectiveness of our documentation and whether users find what they're searching for. With your consent, you're helping us to make our documentation better.

Google Analytics





Cancel

9 žingsnis. Paspauskite **Next**.

Cookie consent

We use cookies to measure the effectiveness of our documentation and whether users find what they're searching for. With your consent, you're helping us to make our documentation better.

Google Analytics



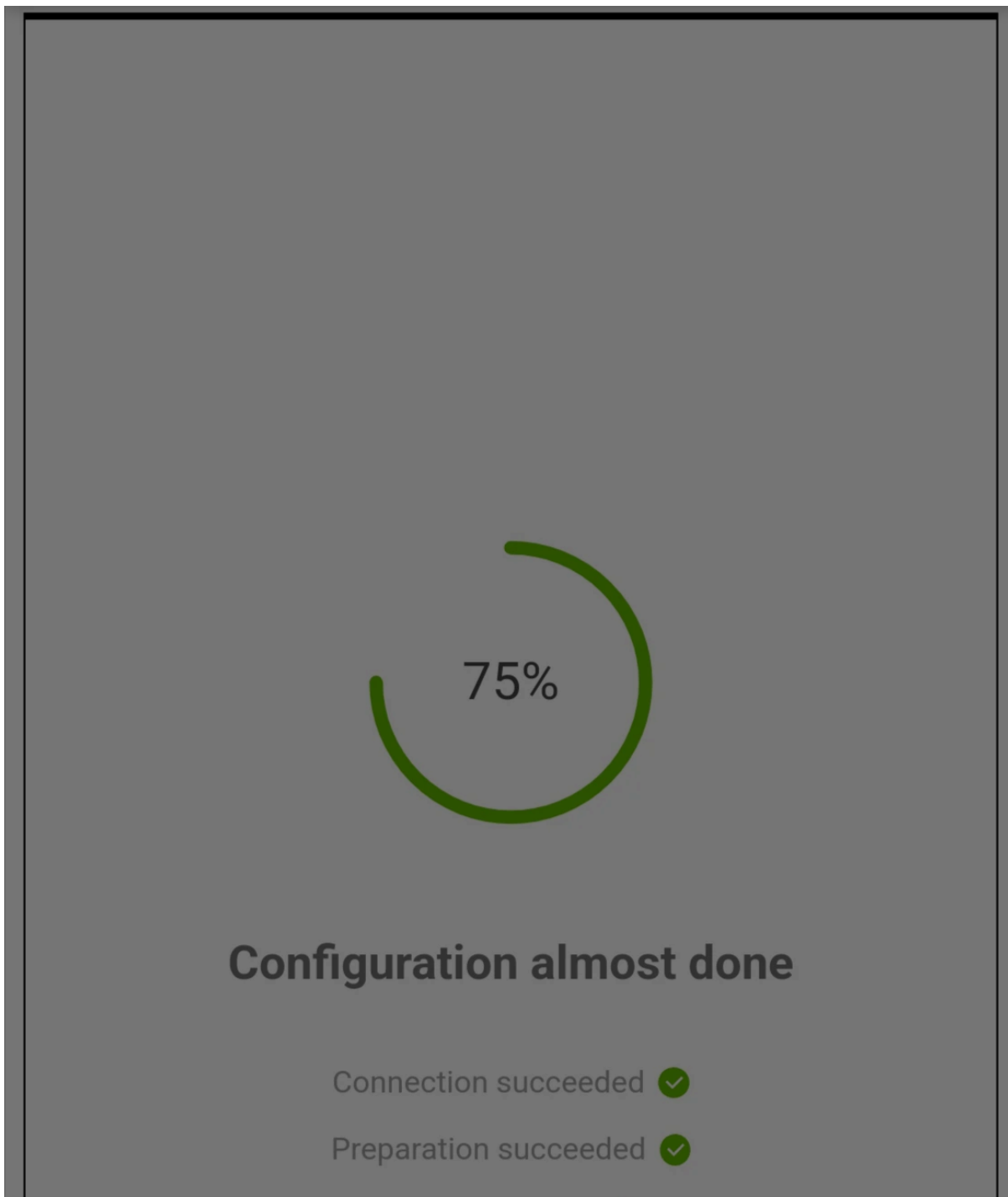

Cookie consent

We use cookies to measure the effectiveness of our documentation and whether users find what they're searching for. With your consent, you're helping us to make our documentation better.

Google Analytics



Advanced settings

Next

10 žingsnis. Įveskite sistemos **Name**, tada paspauskite **Next**.

Cookie consent

We use cookies to measure the effectiveness of our documentation and whether users find what they're searching for. With your consent, you're helping us to make our documentation better.

Google Analytics



Add new system

Name

Gator

Background



Time zone

Europe/Vilnius



Cookie consent

We use cookies to measure the effectiveness of our documentation and whether users find what they're searching for. With your consent, you're helping us to make our documentation better.

Google Analytics





Skip

Next

11 žingsnis. Paspauskite **Skip**, jeigu dabar nenorite pridėti vartotojų.

Cookie consent

We use cookies to measure the effectiveness of our documentation and whether users find what they're searching for. With your consent, you're helping us to make our documentation better.

Google Analytics



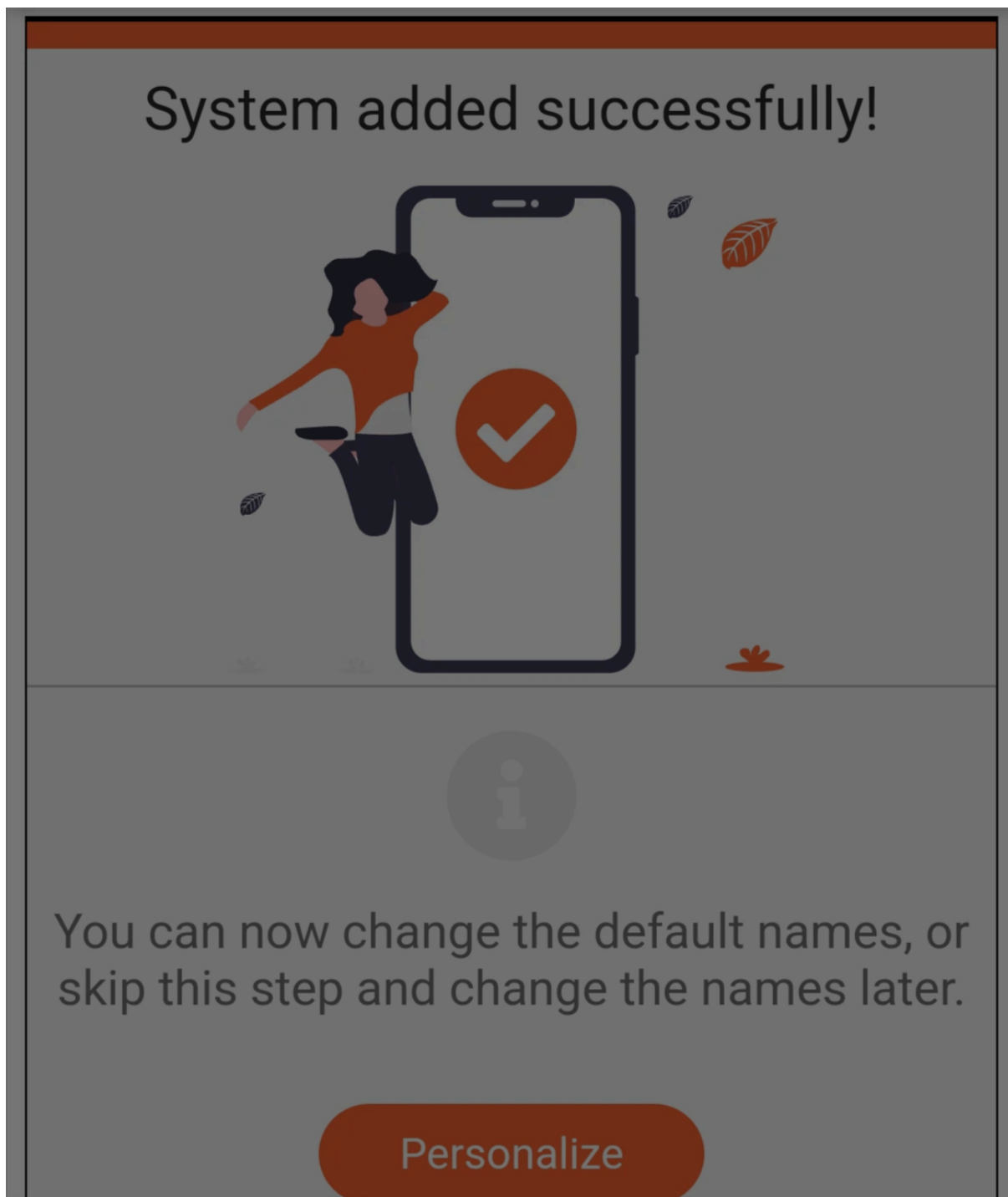

Cookie consent

We use cookies to measure the effectiveness of our documentation and whether users find what they're searching for. With your consent, you're helping us to make our documentation better.

Google Analytics



Skip

12 žingsnis. Palaukite apie 1 minutę, kol sąranka bus užbaigta.

Cookie consent

We use cookies to measure the effectiveness of our documentation and whether users find what they're searching for. With your consent, you're helping us to make our documentation better.

Google Analytics



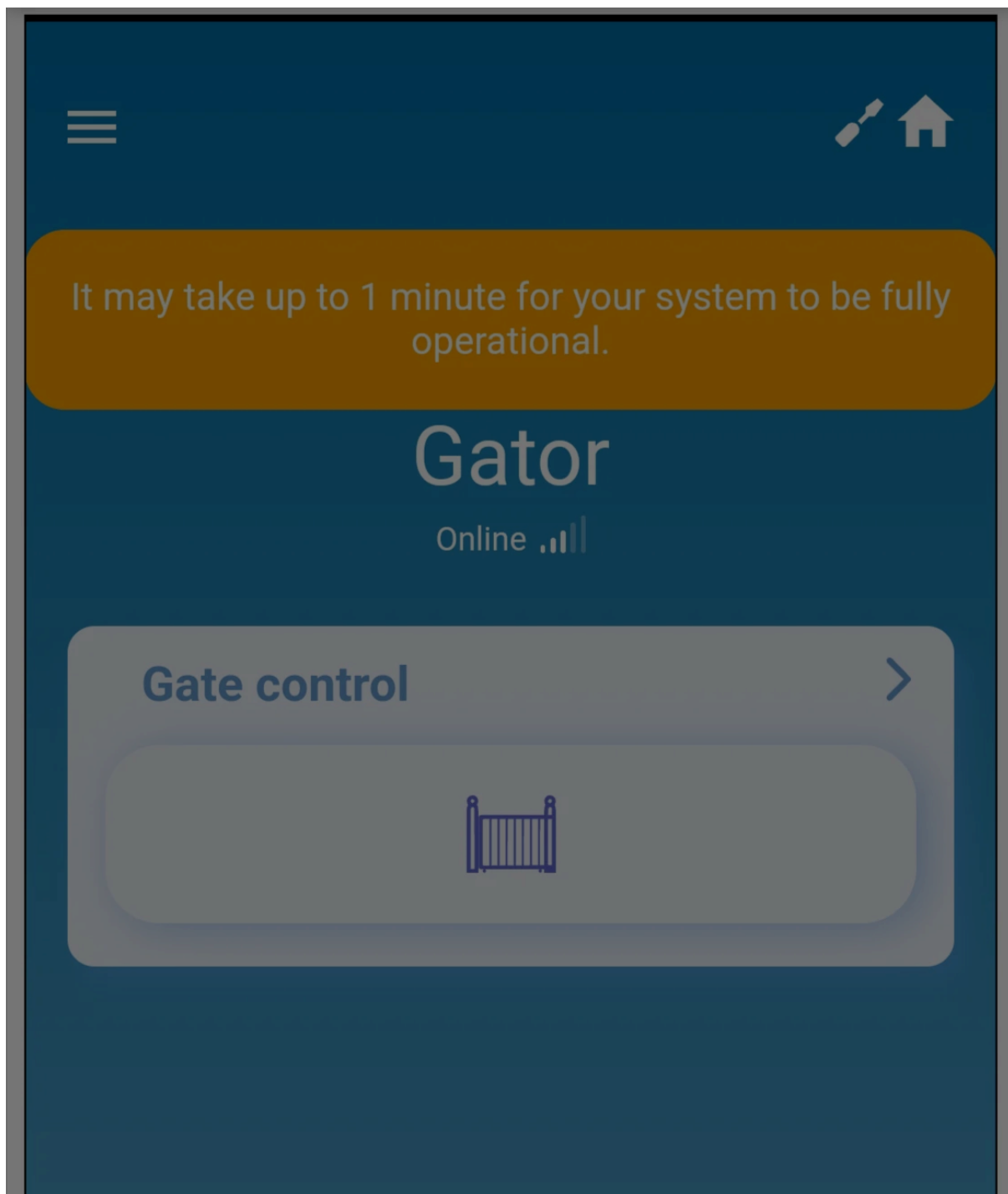

Cookie consent

We use cookies to measure the effectiveness of our documentation and whether users find what they're searching for. With your consent, you're helping us to make our documentation better.

Google Analytics





4. Sistemos perdavimas vartotojui

Baigę sąranką, perduokite sistemą vartotojo Protegus2 paskyrai.

13 žingsnis. Paspauskite **Menu**.

Cookie consent

We use cookies to measure the effectiveness of our documentation and whether users find what they're searching for. With your consent, you're helping us to make our documentation better.

Google Analytics



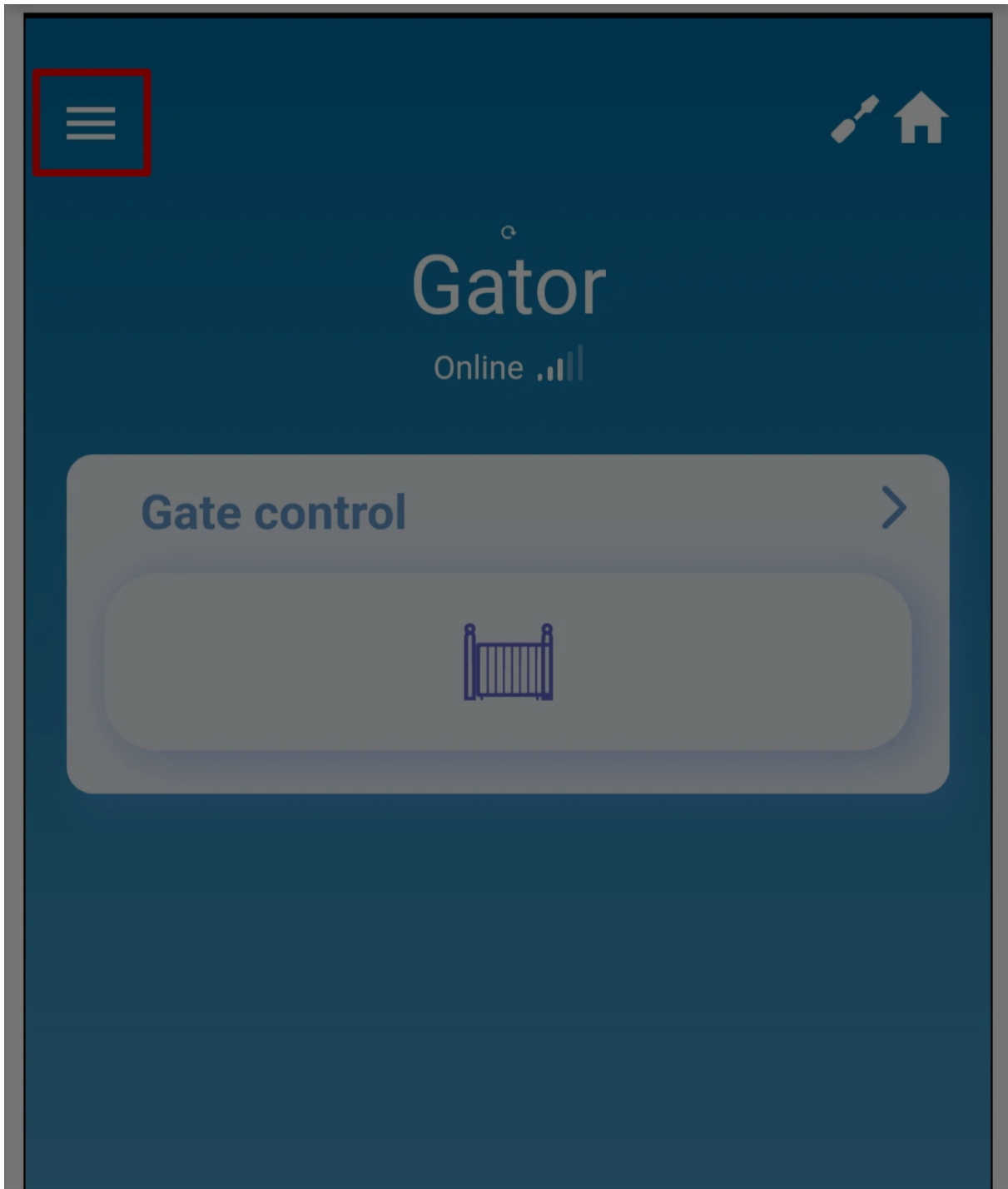

Cookie consent

We use cookies to measure the effectiveness of our documentation and whether users find what they're searching for. With your consent, you're helping us to make our documentation better.

Google Analytics





14 žingsnis. Paspauskite **Settings**.

Cookie consent

We use cookies to measure the effectiveness of our documentation and whether users find what they're searching for. With your consent, you're helping us to make our documentation better.

Google Analytics



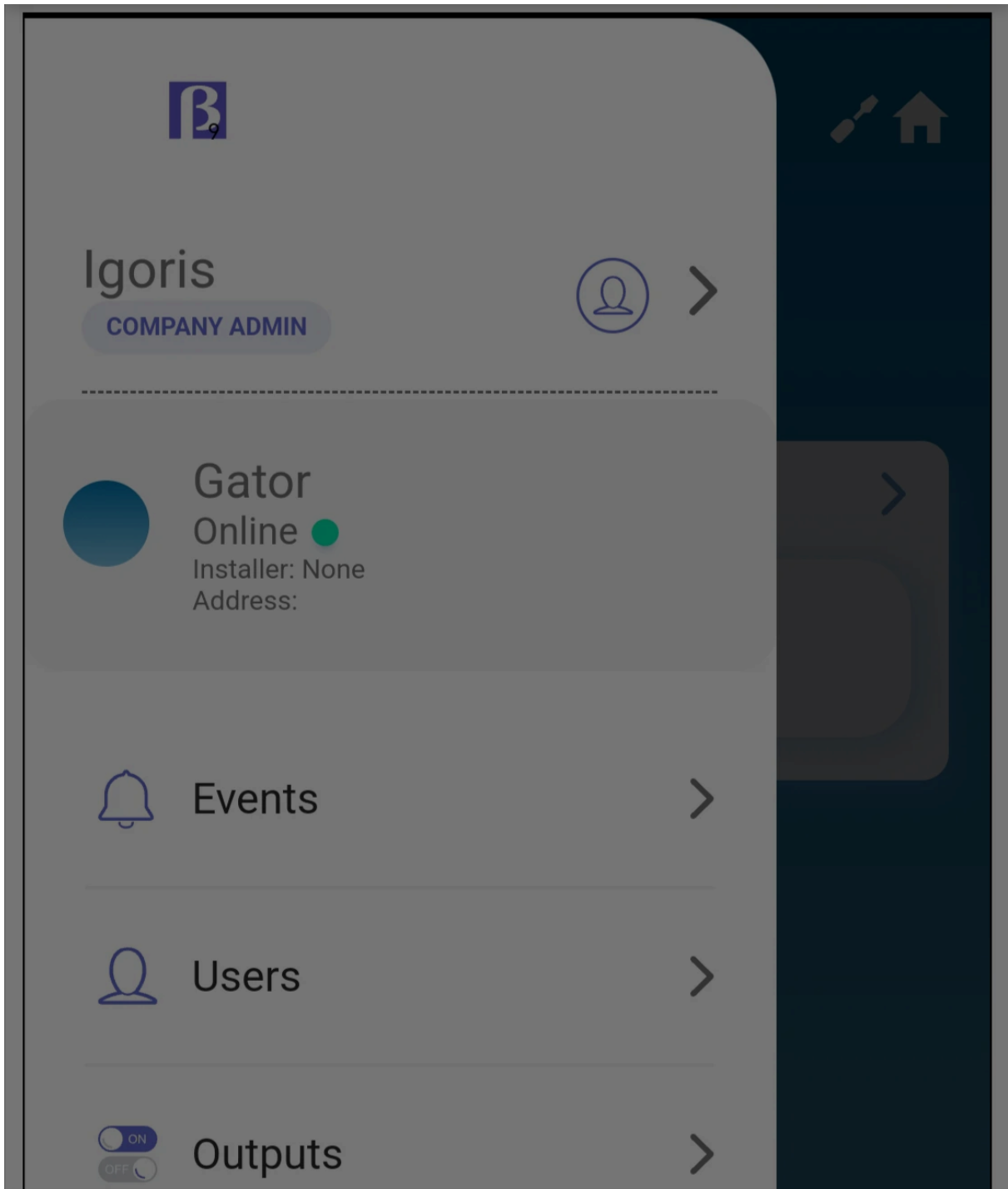

Cookie consent

We use cookies to measure the effectiveness of our documentation and whether users find what they're searching for. With your consent, you're helping us to make our documentation better.

Google Analytics

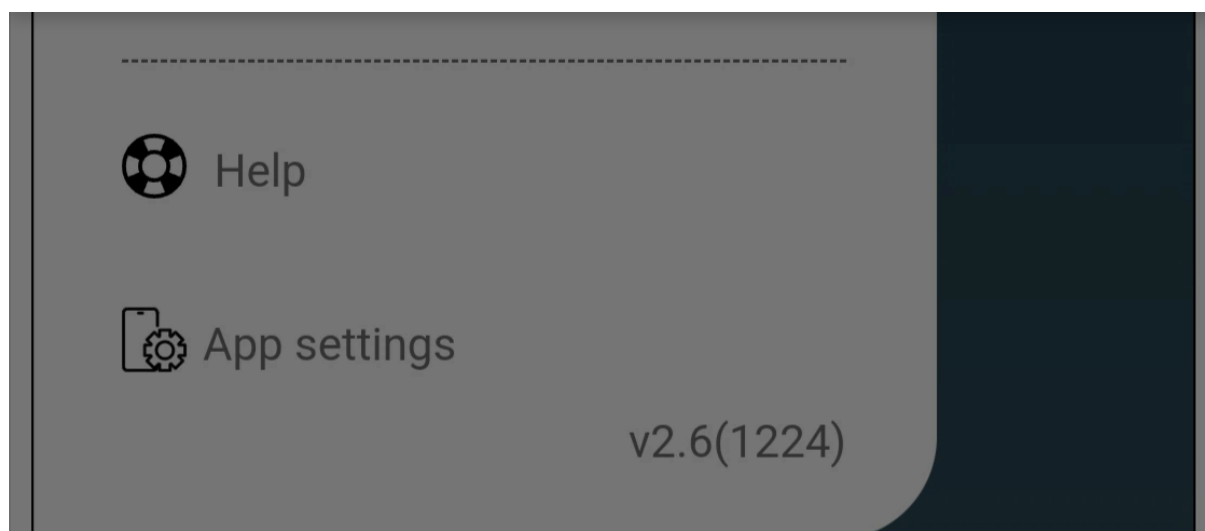

15 žingsnis. Paspauskite **Transfer system**.

Cookie consent

We use cookies to measure the effectiveness of our documentation and whether users find what they're searching for. With your consent, you're helping us to make our documentation better.

Google Analytics



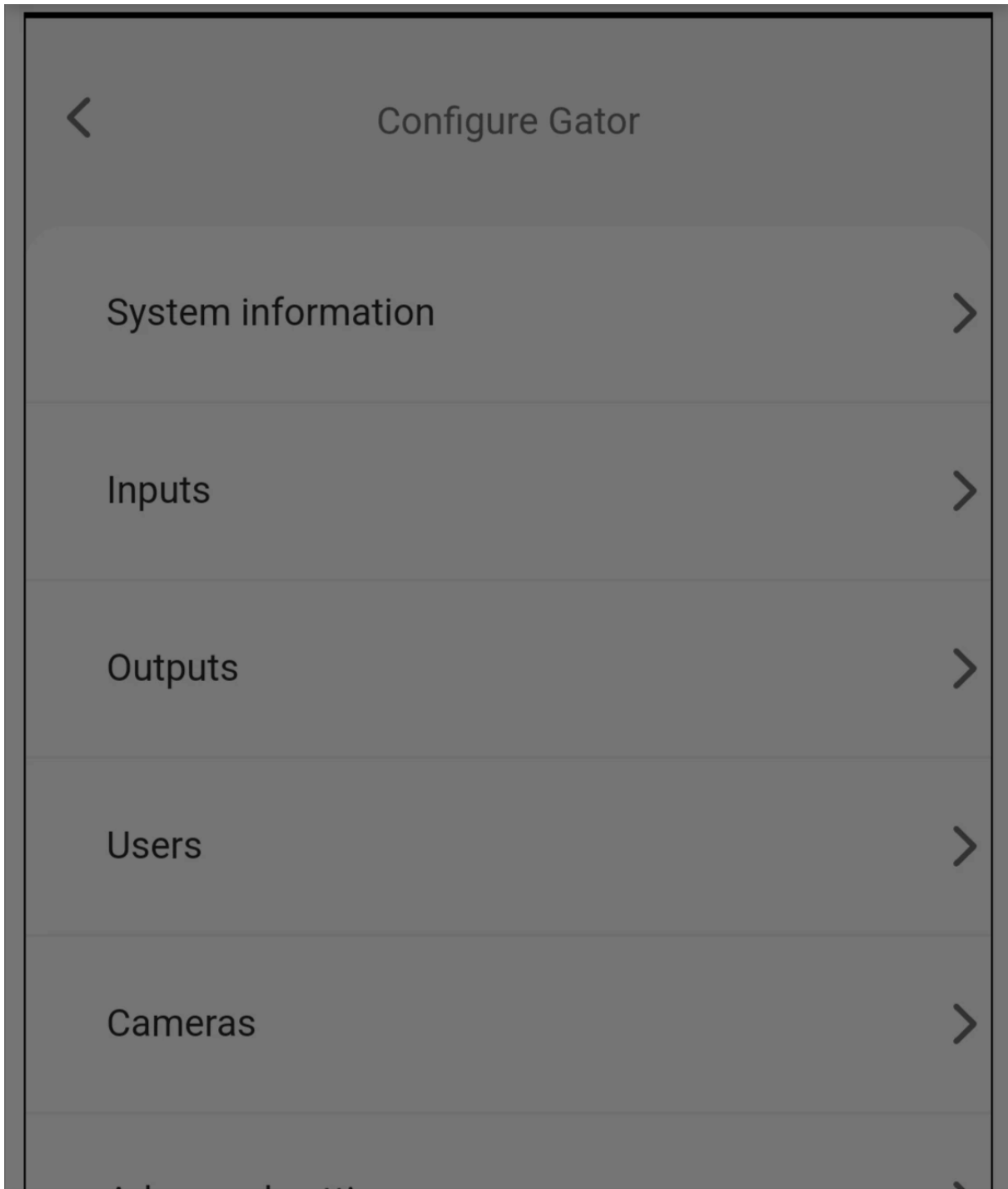

Cookie consent

We use cookies to measure the effectiveness of our documentation and whether users find what they're searching for. With your consent, you're helping us to make our documentation better.

Google Analytics



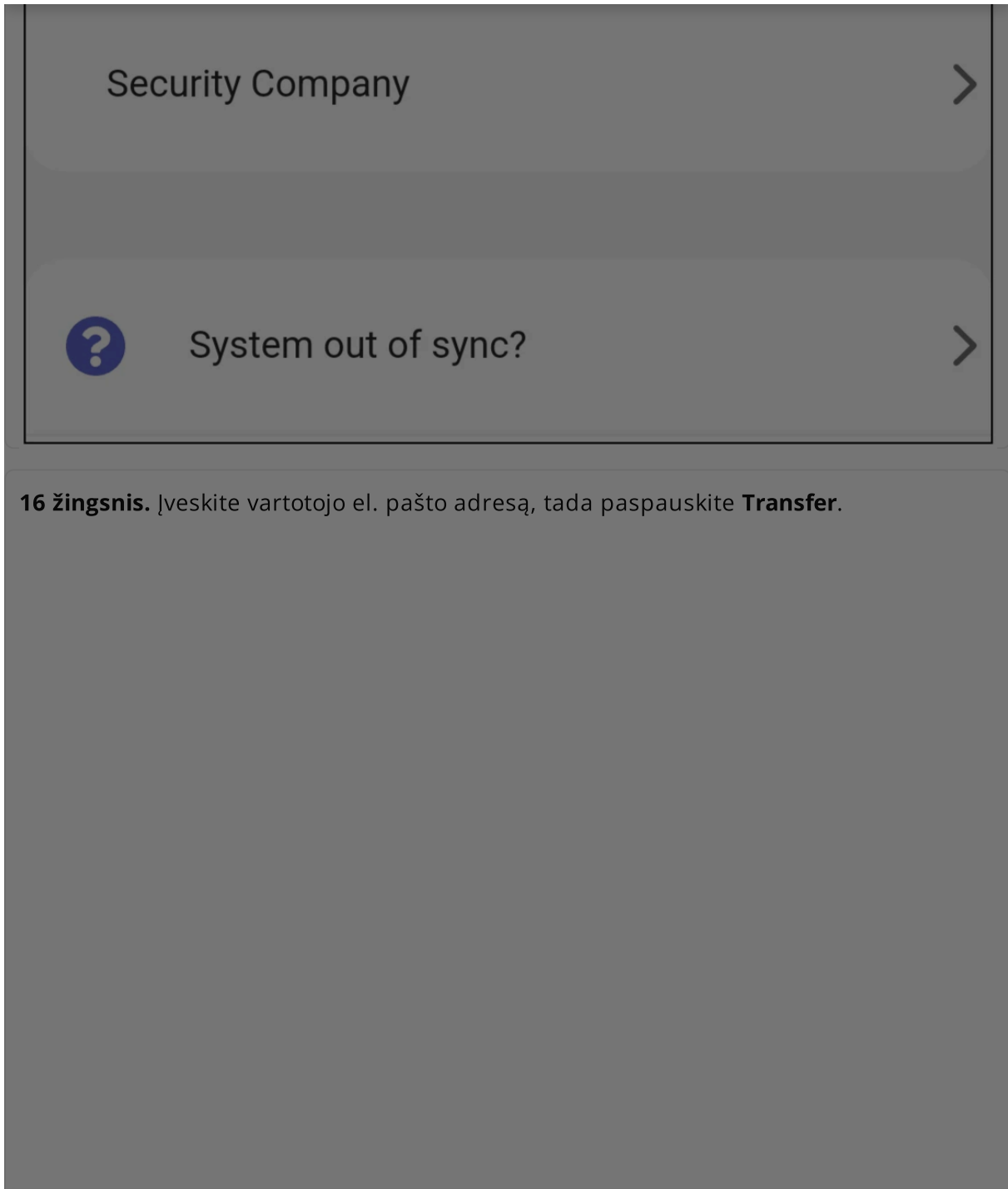

Cookie consent

We use cookies to measure the effectiveness of our documentation and whether users find what they're searching for. With your consent, you're helping us to make our documentation better.

Google Analytics



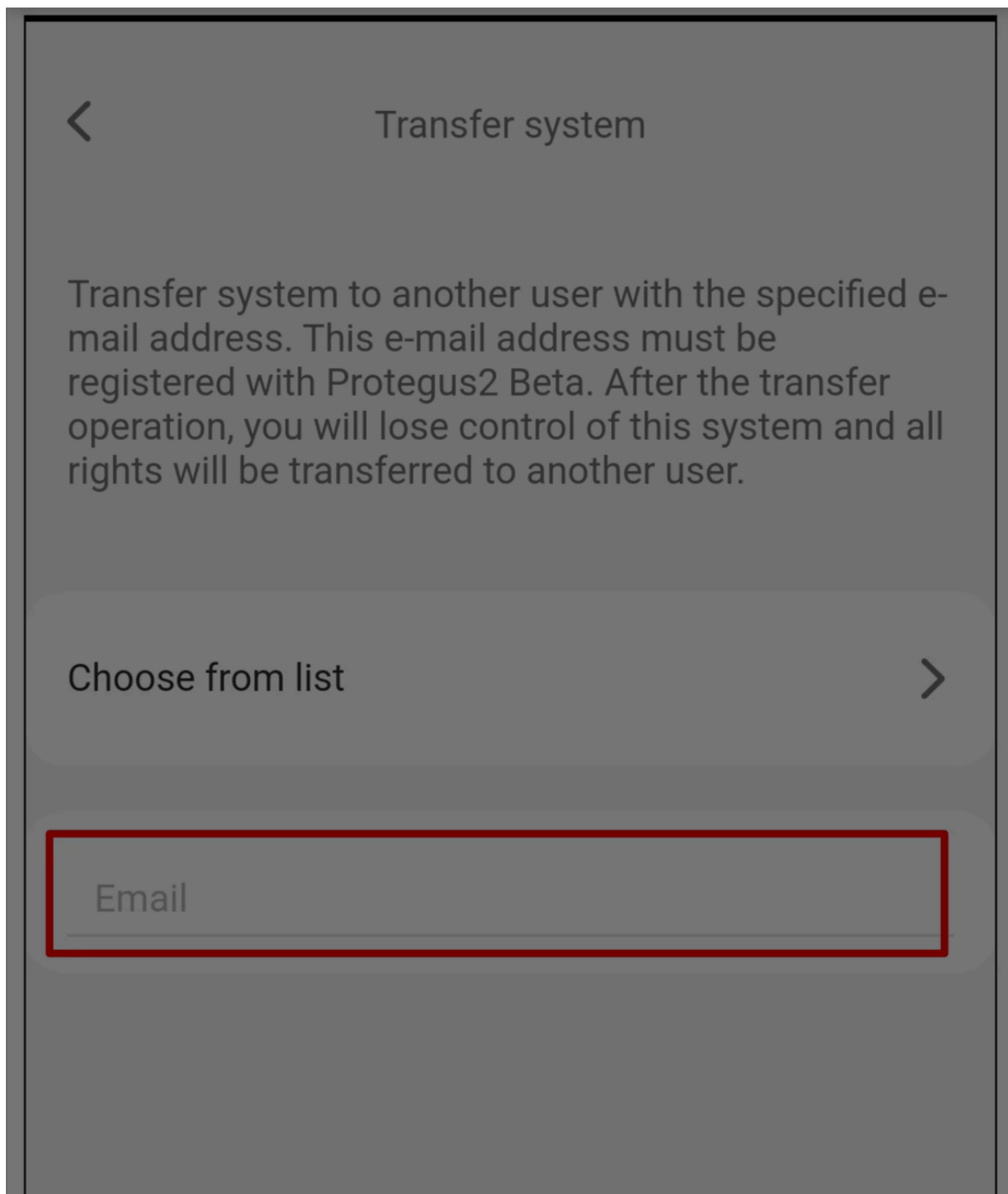

Cookie consent

We use cookies to measure the effectiveness of our documentation and whether users find what they're searching for. With your consent, you're helping us to make our documentation better.

Google Analytics





5. Vartų stebėjimo ir valdymo patikra

Po perdavimo vartotojas turi prisijungti prie Protegus2 naudodamas savo paskyrą.

ĮSPĖJIMAS

Vartų apsaugos jutiklio apėjimas gali išjungti saugos apsaugą. Apėjimą naudokite tik kaip laikiną, įgaliotą techninės priežiūros veiksmą ir prieš palikdami įrenginį naudoti atkurkite normalų jutiklio veikimą.

Transfer

17 žingsnis. Paspauskite **Gate control**, kad matytumėte vartų ciklą skaitiklį.

Cookie consent

We use cookies to measure the effectiveness of our documentation and whether users find what they're searching for. With your consent, you're helping us to make our documentation better.

Google Analytics

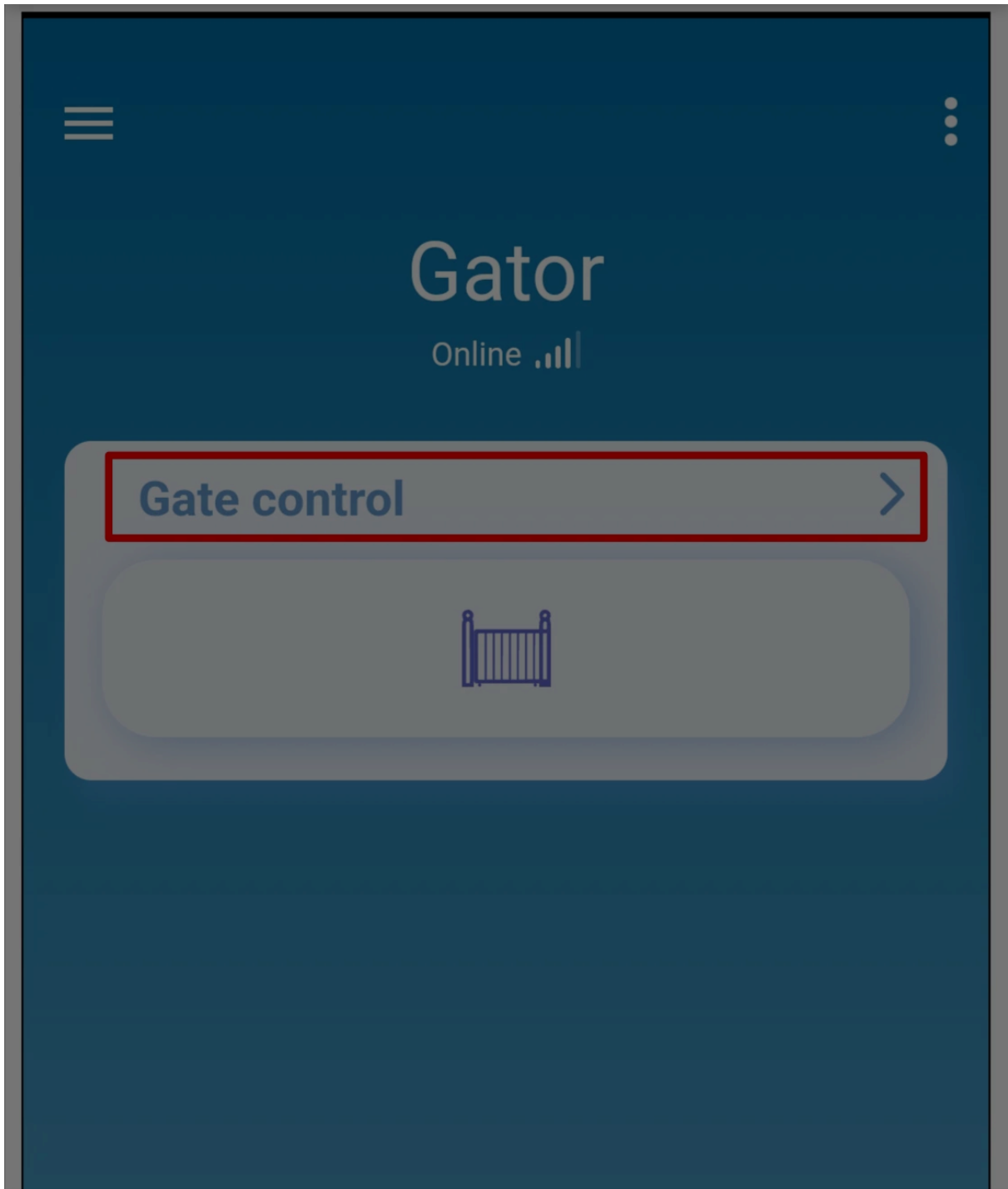

Cookie consent

We use cookies to measure the effectiveness of our documentation and whether users find what they're searching for. With your consent, you're helping us to make our documentation better.

Google Analytics





18 žingsnis. Peržiūrėkite **Total cycles** ir **Cycles to maintenance**. Jei įgaliotas montuotojas turi patikrinti apsaugos jutiklių būseną, paspauskite **Input status**.

Cookie consent

We use cookies to measure the effectiveness of our documentation and whether users find what they're searching for. With your consent, you're helping us to make our documentation better.

Google Analytics



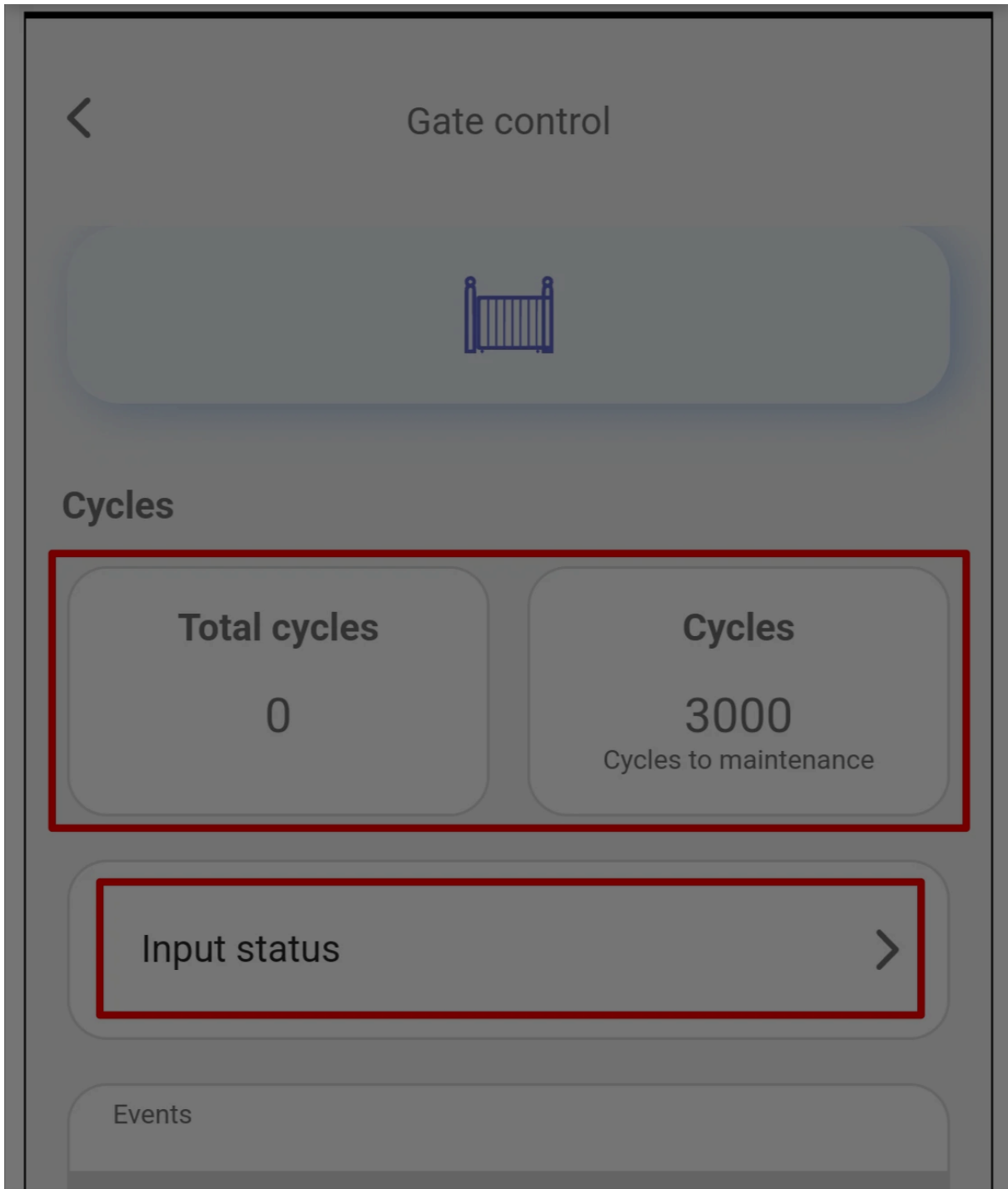

Cookie consent

We use cookies to measure the effectiveness of our documentation and whether users find what they're searching for. With your consent, you're helping us to make our documentation better.

Google Analytics



19 žingsnis. Input status / bypass naudokite tik tada, kai apsaugos jutiklis patikrintas ir apėjimas reikalingas laikinai.

Cookie consent

We use cookies to measure the effectiveness of our documentation and whether users find what they're searching for. With your consent, you're helping us to make our documentation better.

Google Analytics



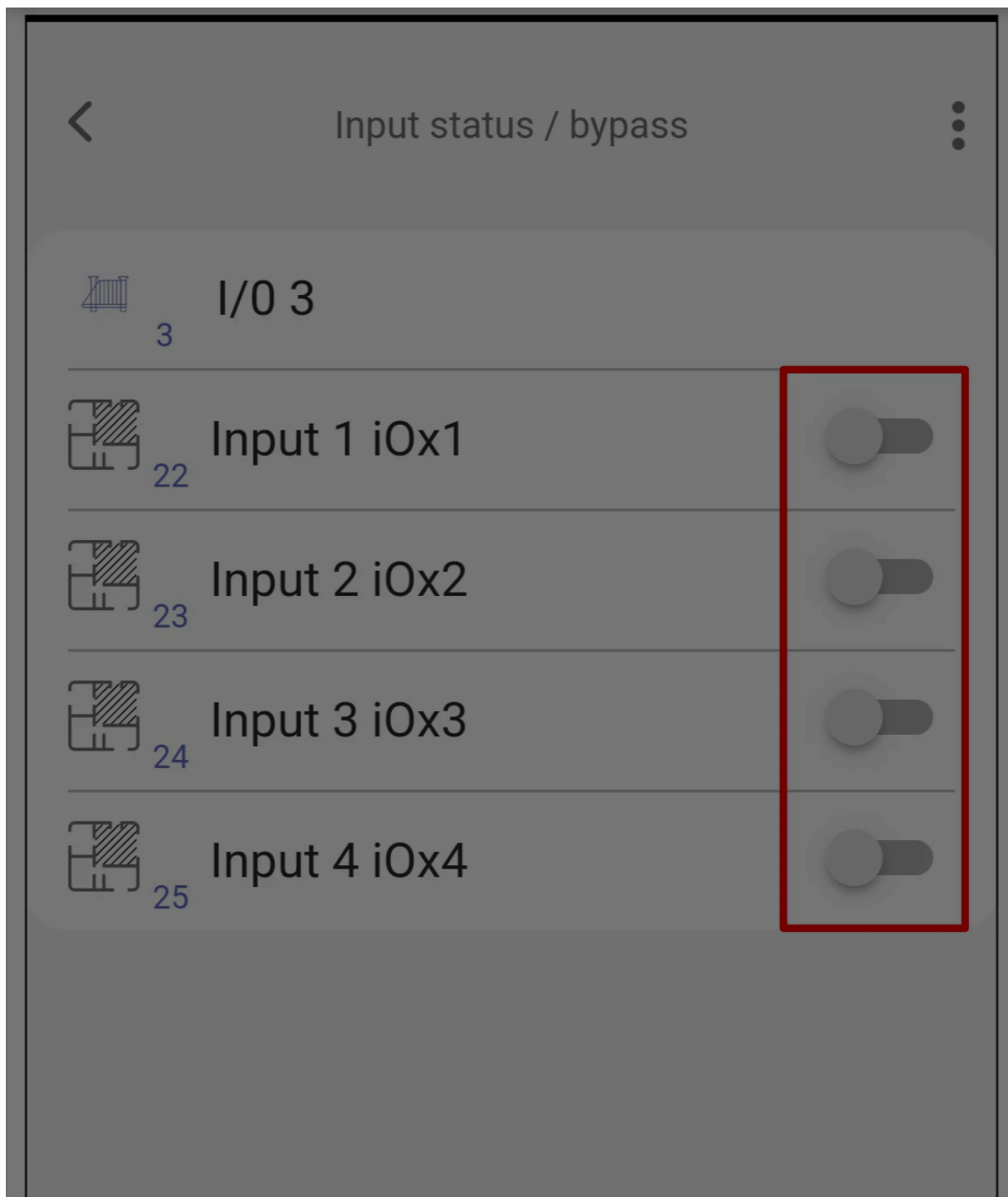

Cookie consent

We use cookies to measure the effectiveness of our documentation and whether users find what they're searching for. With your consent, you're helping us to make our documentation better.

Google Analytics



20 žingsnis. Paspauskite vartų valdymo piktogramą, kad atidarytumėte vartus.

Cookie consent

We use cookies to measure the effectiveness of our documentation and whether users find what they're searching for. With your consent, you're helping us to make our documentation better.

Google Analytics



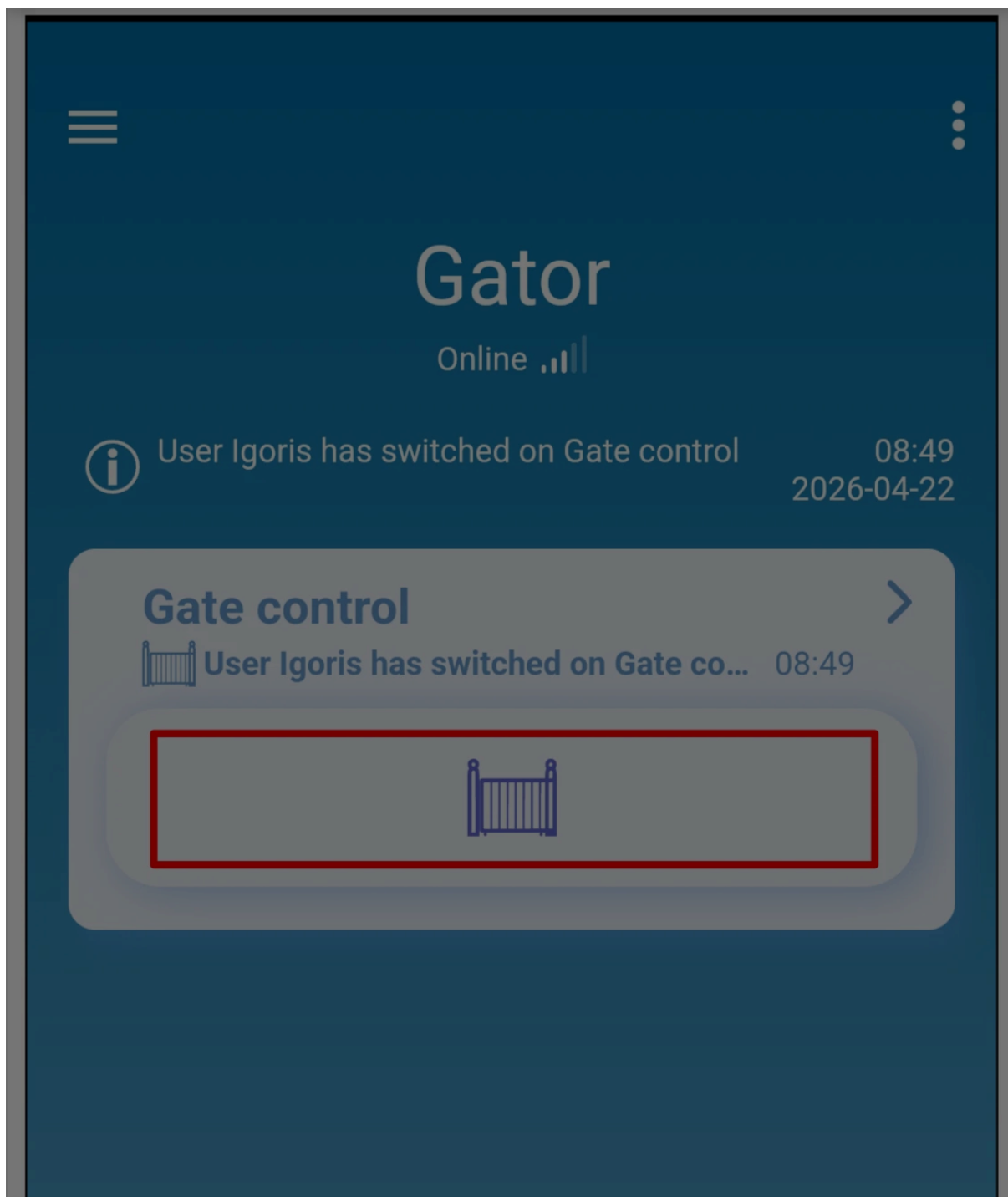

Cookie consent

We use cookies to measure the effectiveness of our documentation and whether users find what they're searching for. With your consent, you're helping us to make our documentation better.

Google Analytics





6. Sistemos patikra

1. Pilnai atidarykite ir uždarykite vartus, tada patikrinkite, ar ciklų skaitiklis pasikeičia kaip tikėtasi.
2. Suaktyvinkite kiekvieną stebimą iO4R jėjimą ir patikrinkite, ar jėjimo būseną pasikeičia Protegus2 programoje.
3. Patikrinkite vartų valdymo piktogramą ir įsitikinkite, kad vartų automatika reaguoja tinkamai.

Cookie consent

We use cookies to measure the effectiveness of our documentation and whether users find what they're searching for. With your consent, you're helping us to make our documentation better.

Google Analytics

