

КОНТРОЛЛЕРЫ

# Быстрая настройка GATOR LTE и GATOR WiFi с iO4R

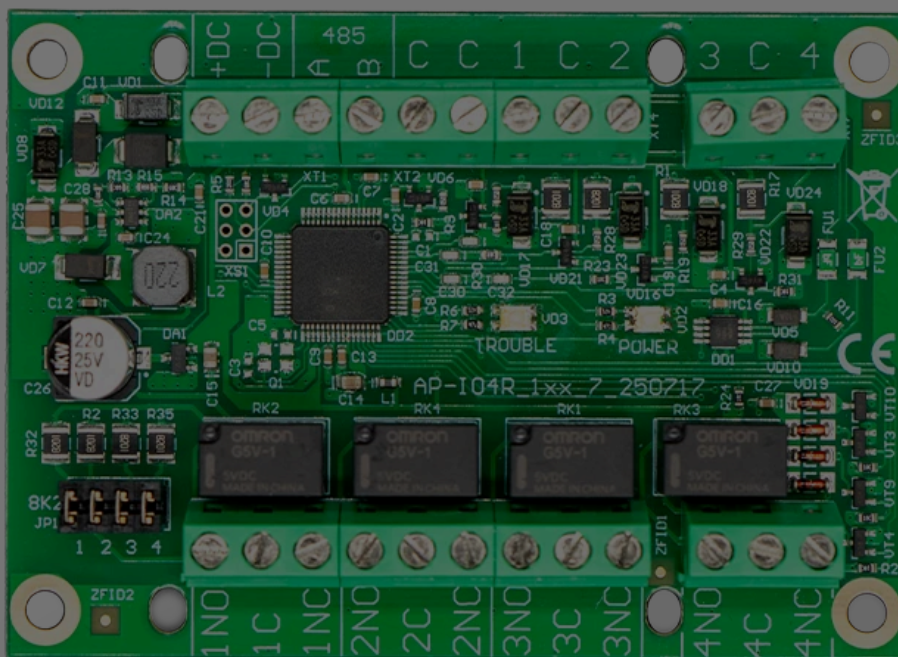

Краткие шаги подключения и программирования в Protegus2 для подключения расширителя iO4R к контроллеру ворот GATOR LTE или GATOR WiFi. Для остальных параметров установки и настройки используйте полные руководства GATOR и GATOR WiFi.

iO4R используется для расширенного мониторинга ворот. Он добавляет контролируемые входы Guard для датчиков безопасности ворот и позволяет уполномоченному специалисту временно выполнить обход, когда неисправность датчика нужно изолировать до проведения обслуживания. Protegus2 также считает

## Cookie consent

We use cookies to measure the effectiveness of our documentation and whether users find what they're searching for. With your consent, you're helping us to make our documentation better.

Google Analytics

Accept

Reject



### ОСТОРОЖНО

Установку и обслуживание должен выполнять только квалифицированный персонал. Перед подключением проводов отключите сетевое и низковольтное питание. Соблюдайте инструкции по безопасности производителя автоматике ворот и местные электротехнические нормы.

## 1. Предварительные условия

- Контроллер ворот GATOR LTE или GATOR WiFi готов к настройке. При подключении проводов питание должно быть отключено.
- Серийный номер расширителя iO4R.
- Учетная запись компании или установщика Protegus2 и IMEI / Unique ID контроллера.
- Датчик состояния ворот подключен к входу положения ворот контроллера.
- Датчики безопасности ворот подключены через расширитель iO4R, если их нужно контролировать или временно обходить в Protegus2.

## 2. Подключение проводов

Подключите расширитель iO4R к шине RS485 контроллера и к клеммам питания, как показано ниже.

### ПРИМЕЧАНИЕ

На схеме показаны обозначения клемм GATOR LTE. Для GATOR WiFi используйте соответствующие клеммы +DC, -DC, A RS485 и B RS485 из руководства GATOR WiFi.

### Cookie consent

We use cookies to measure the effectiveness of our documentation and whether users find what they're searching for. With your consent, you're helping us to make our documentation better.

Google Analytics



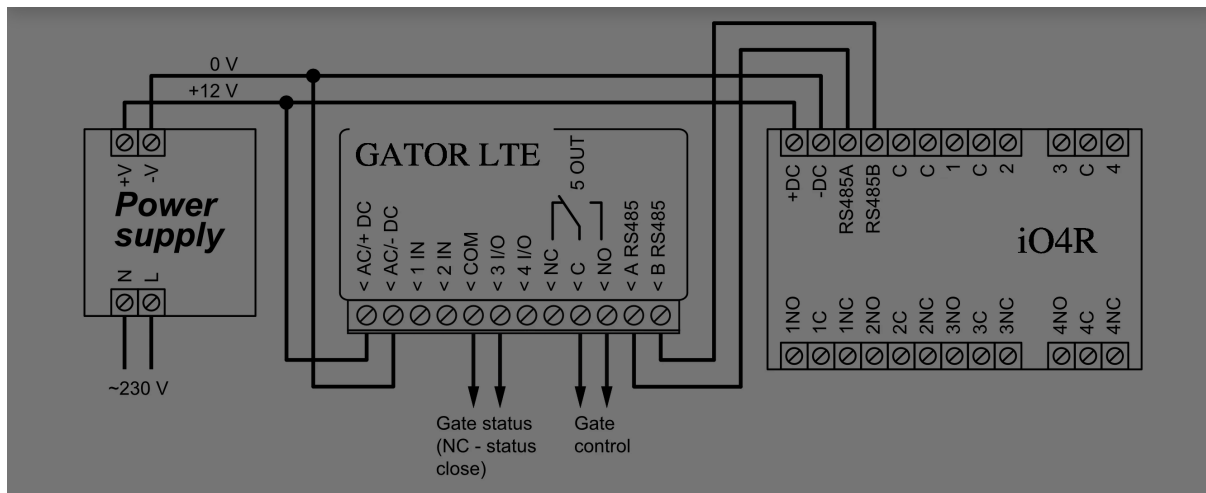

Используйте 3 I/O как вход положения ворот для подсчета циклов. Цикл засчитывается только после полного открытия и полного закрытия ворот.

#### ВАЖНО

В настройке мониторинга Protegus2 I/O 3 зарезервирован для положения ворот и подсчета циклов. Не переназначайте его. Входы IN1 и IN2 зарезервированы для Wiegand.

## 3. Добавление контроллера и iO4R в Protegus2

Войдите в Protegus2 с учетной записью компании или установщика, затем добавьте контроллер.

**Шаг 1.** Нажмите **Add new system**.

### Cookie consent

We use cookies to measure the effectiveness of our documentation and whether users find what they're searching for. With your consent, you're helping us to make our documentation better.

Google Analytics

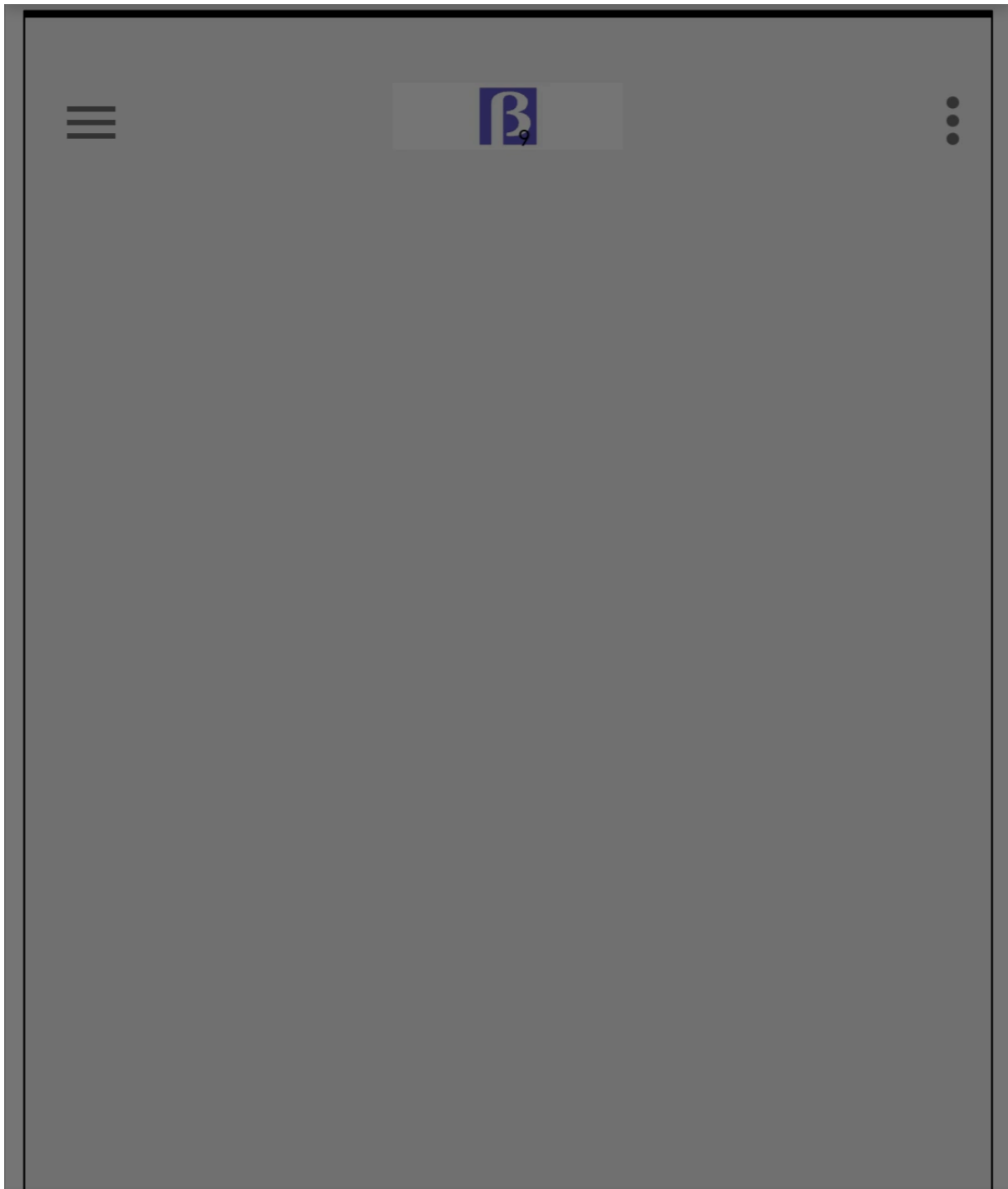

### Cookie consent

We use cookies to measure the effectiveness of our documentation and whether users find what they're searching for. With your consent, you're helping us to make our documentation better.

Google Analytics





**Шаг 2.** Введите **IMEI** контроллера, затем нажмите **Next**.

### Cookie consent

We use cookies to measure the effectiveness of our documentation and whether users find what they're searching for. With your consent, you're helping us to make our documentation better.

Google Analytics



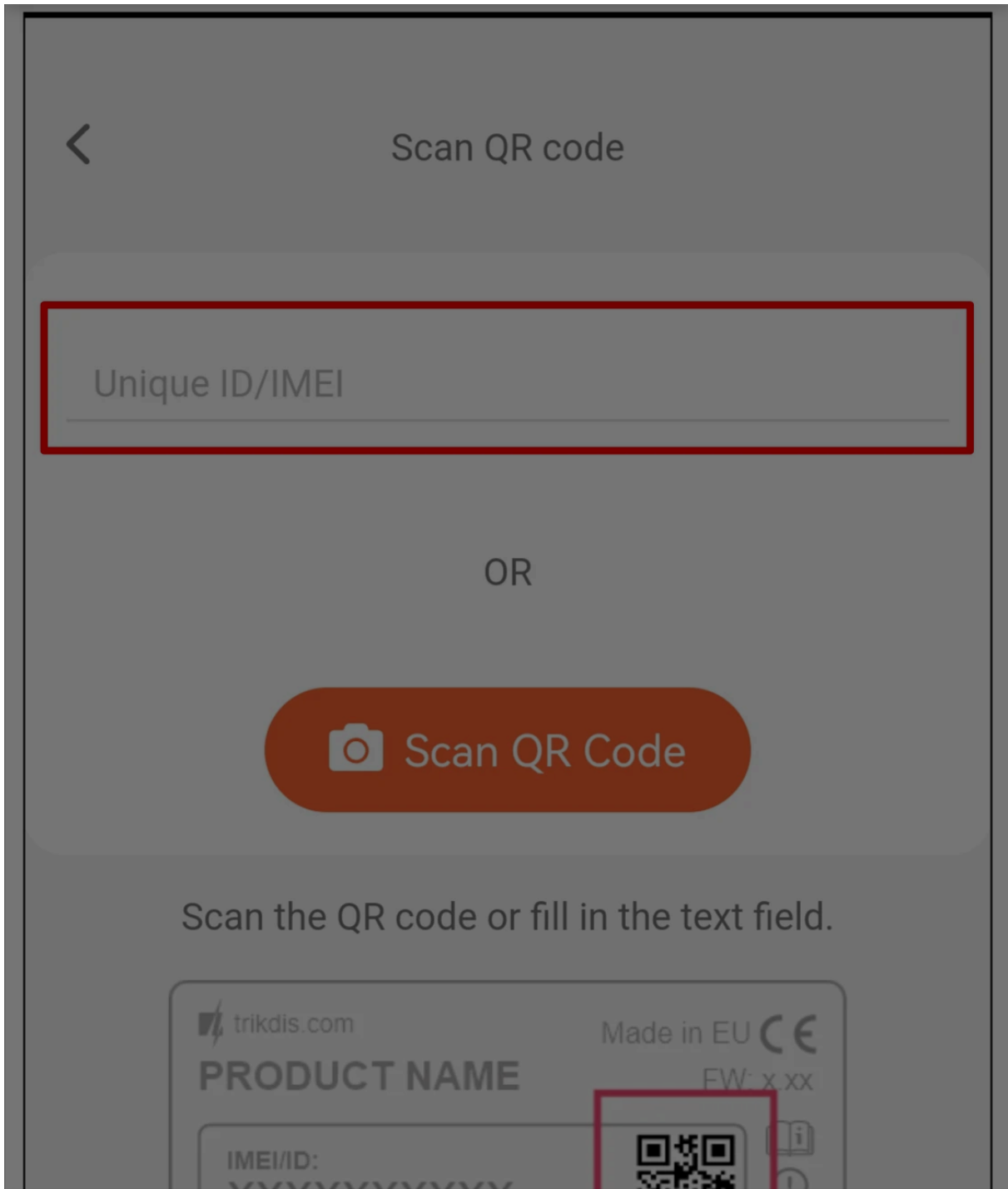

### Cookie consent

We use cookies to measure the effectiveness of our documentation and whether users find what they're searching for. With your consent, you're helping us to make our documentation better.

Google Analytics



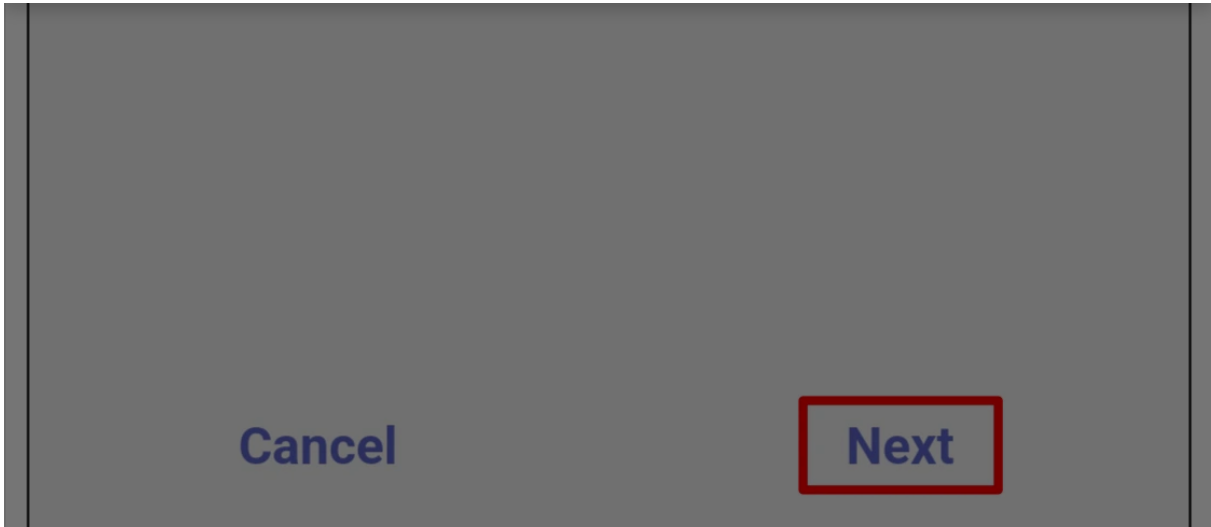

**Шаг 3.** Выберите **Advanced Gator Monitoring**, затем нажмите **Next**.

### Cookie consent

We use cookies to measure the effectiveness of our documentation and whether users find what they're searching for. With your consent, you're helping us to make our documentation better.

Google Analytics



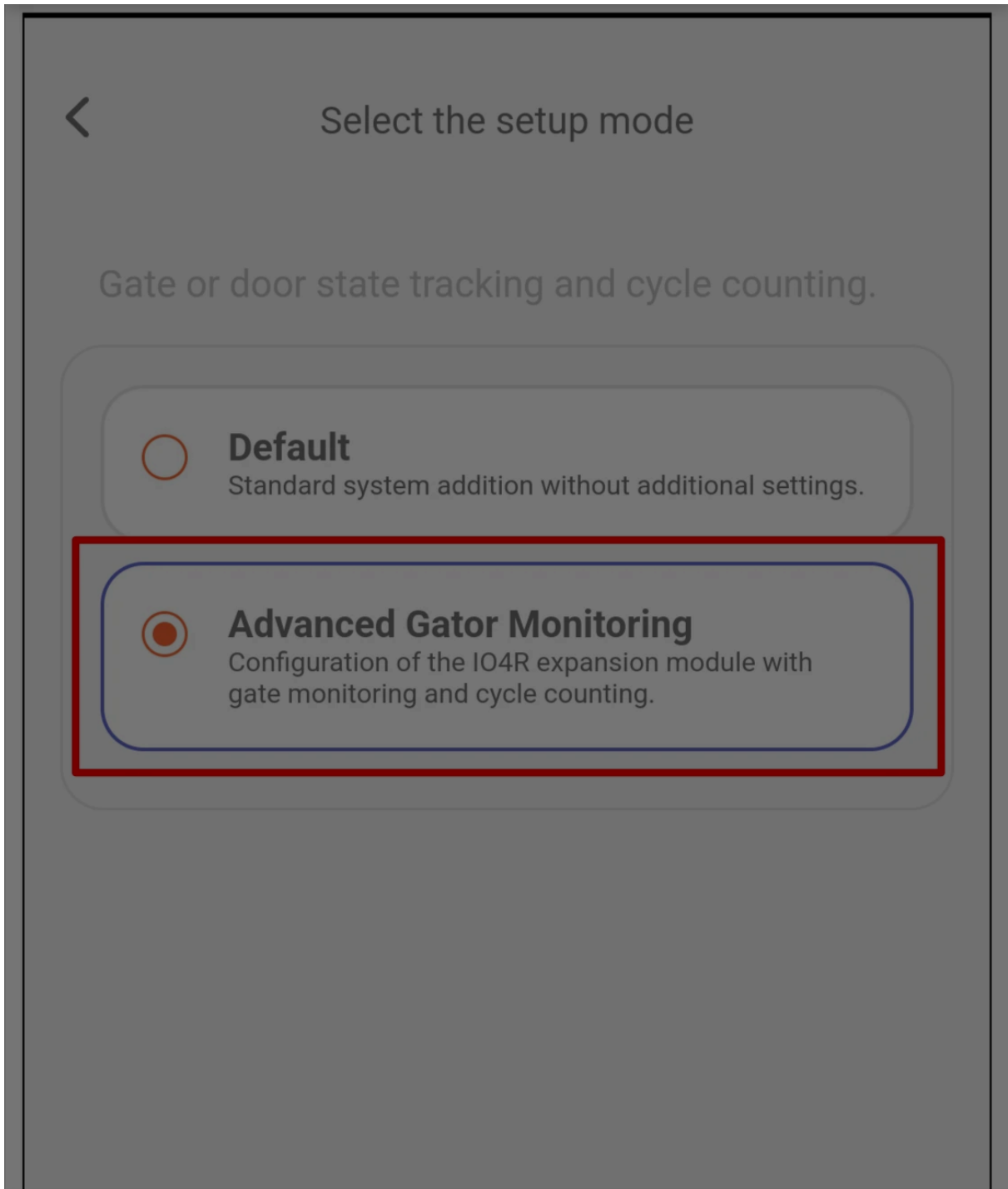

### Cookie consent

We use cookies to measure the effectiveness of our documentation and whether users find what they're searching for. With your consent, you're helping us to make our documentation better.

Google Analytics

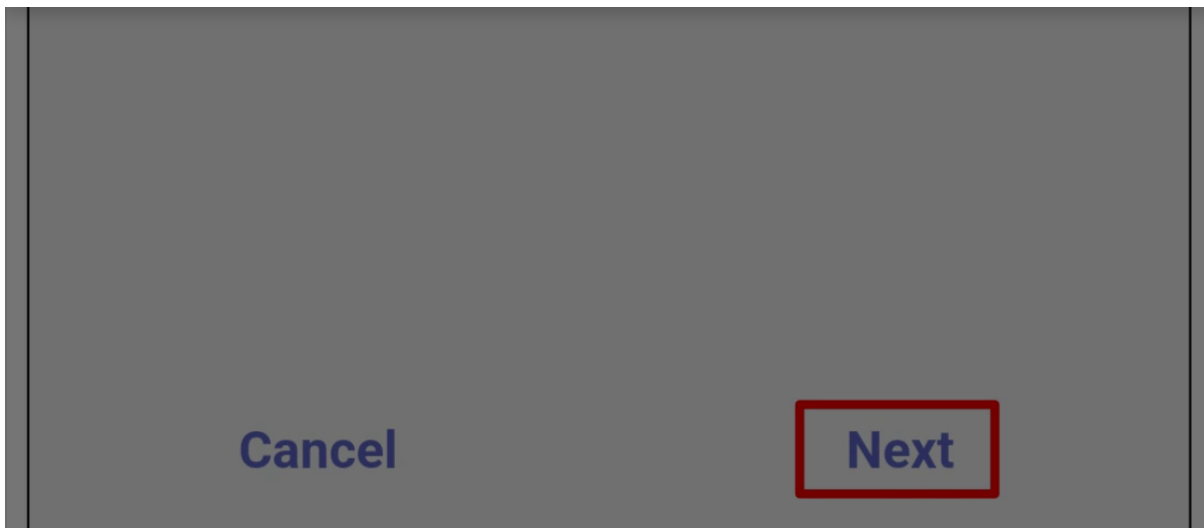

**Шаг 4.** Установите количество **Cycles**, после которого требуется обслуживание, затем нажмите **Next**.

### Cookie consent

We use cookies to measure the effectiveness of our documentation and whether users find what they're searching for. With your consent, you're helping us to make our documentation better.

Google Analytics



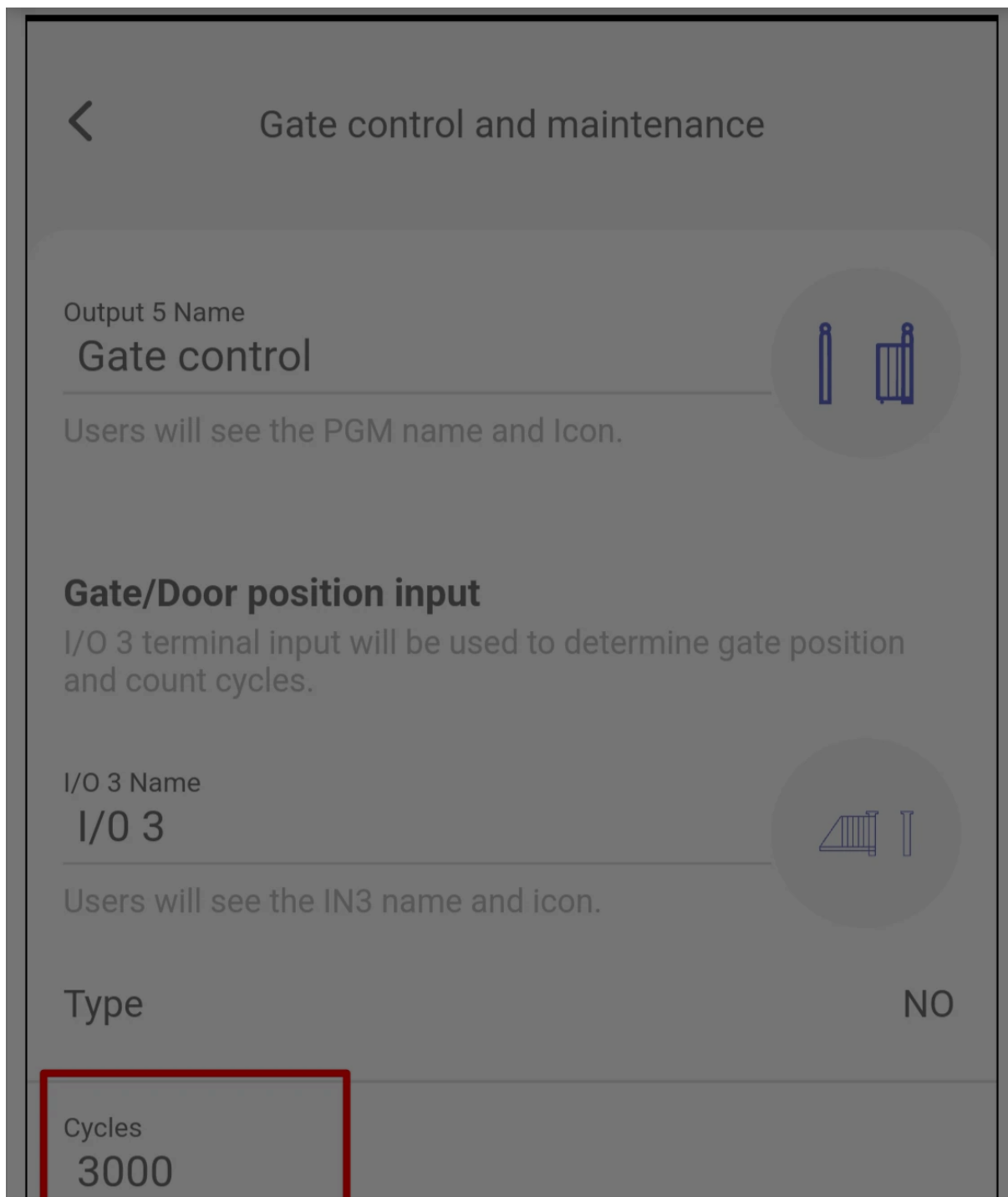

### Cookie consent

We use cookies to measure the effectiveness of our documentation and whether users find what they're searching for. With your consent, you're helping us to make our documentation better.

Google Analytics



Output 3 uses the 3 input (I/O 3) to track state and count full opening and closing cycles.

**Note:** IN3 (I/O 3) is used for cycle counting and cannot be changed. IN1/IN2 are reserved for Wiegand.

Cancel

Next

**Шаг 5.** Включите каждый выход iO4R, который подключен к контролируемому датчику безопасности или цепи состояния.

### Cookie consent

We use cookies to measure the effectiveness of our documentation and whether users find what they're searching for. With your consent, you're helping us to make our documentation better.

Google Analytics

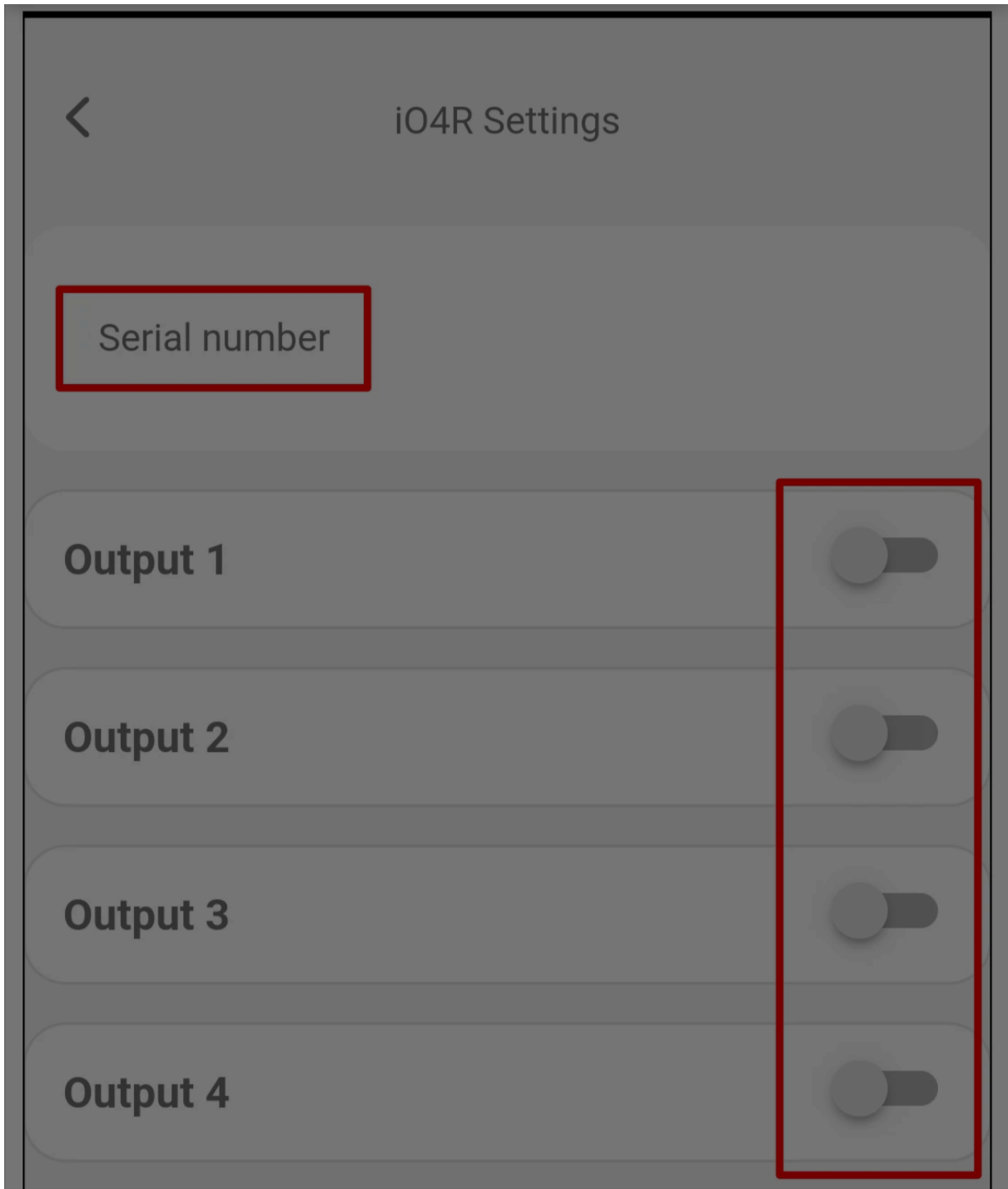

### Cookie consent

We use cookies to measure the effectiveness of our documentation and whether users find what they're searching for. With your consent, you're helping us to make our documentation better.

Google Analytics





Cancel

Next

**Шаг 6.** Введите **Serial number** iO4R, затем нажмите **OK**.

### Cookie consent

We use cookies to measure the effectiveness of our documentation and whether users find what they're searching for. With your consent, you're helping us to make our documentation better.

Google Analytics



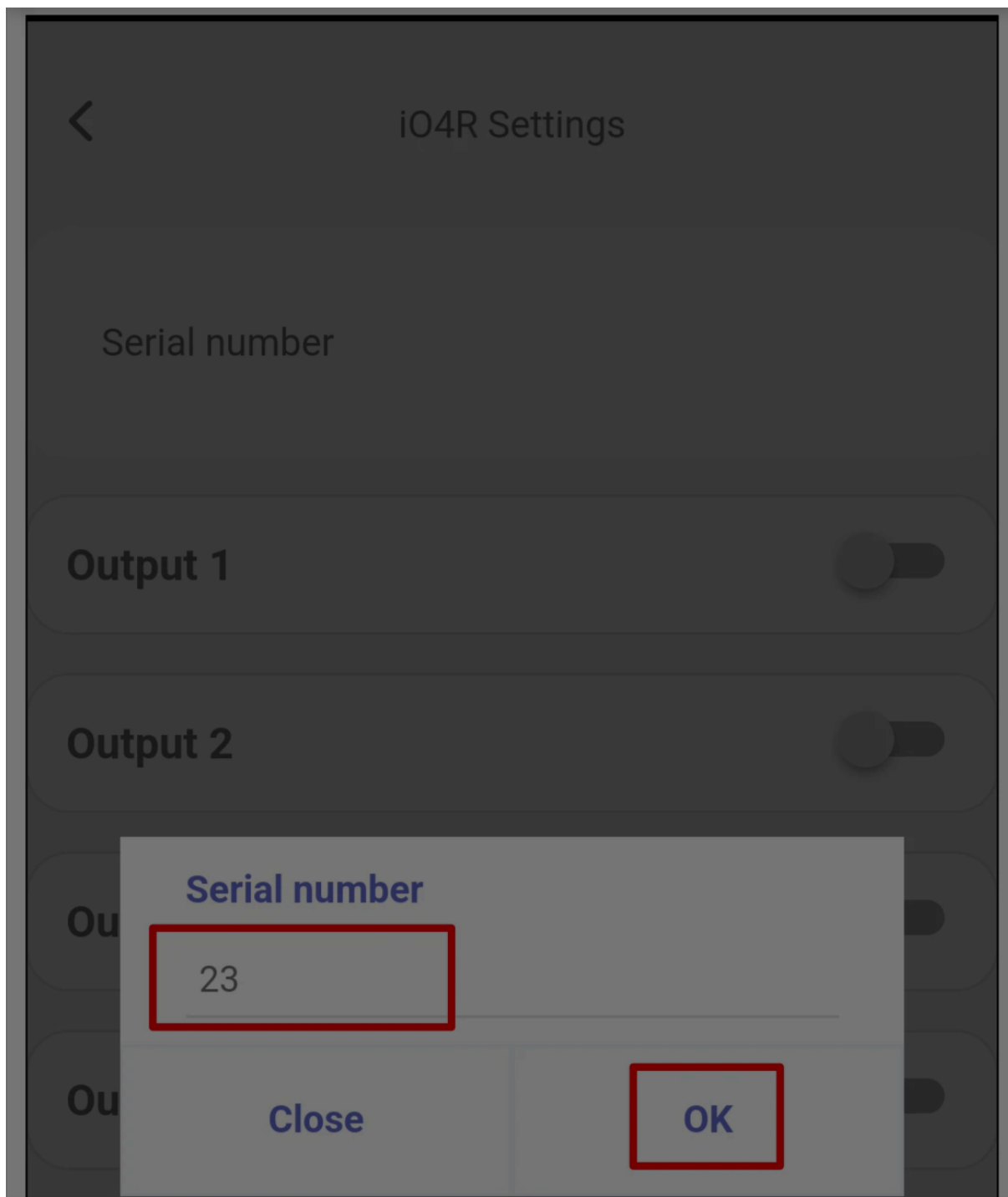

### Cookie consent

We use cookies to measure the effectiveness of our documentation and whether users find what they're searching for. With your consent, you're helping us to make our documentation better.

Google Analytics





Cancel

Next

**Шаг 7.** Для каждого включенного выхода задайте название и иконку, оставьте **Type** выхода как **Guard**, назначьте соответствующий вход iO4R и установите **Type** входа согласно подключению. В показанном примере тип входа: **NO**. Нажмите **Next**.

### Cookie consent

We use cookies to measure the effectiveness of our documentation and whether users find what they're searching for. With your consent, you're helping us to make our documentation better.

Google Analytics



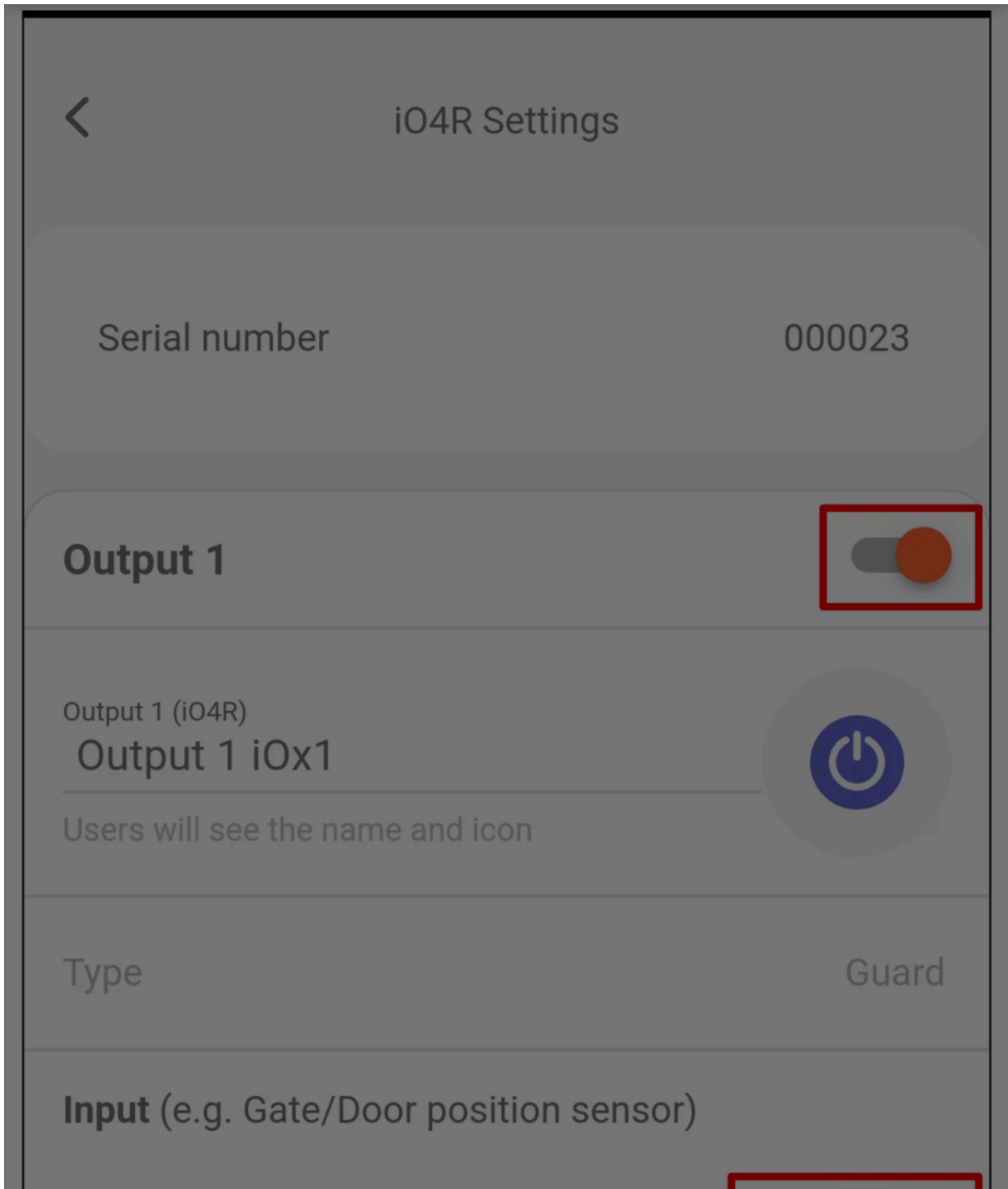

### Cookie consent

We use cookies to measure the effectiveness of our documentation and whether users find what they're searching for. With your consent, you're helping us to make our documentation better.

Google Analytics

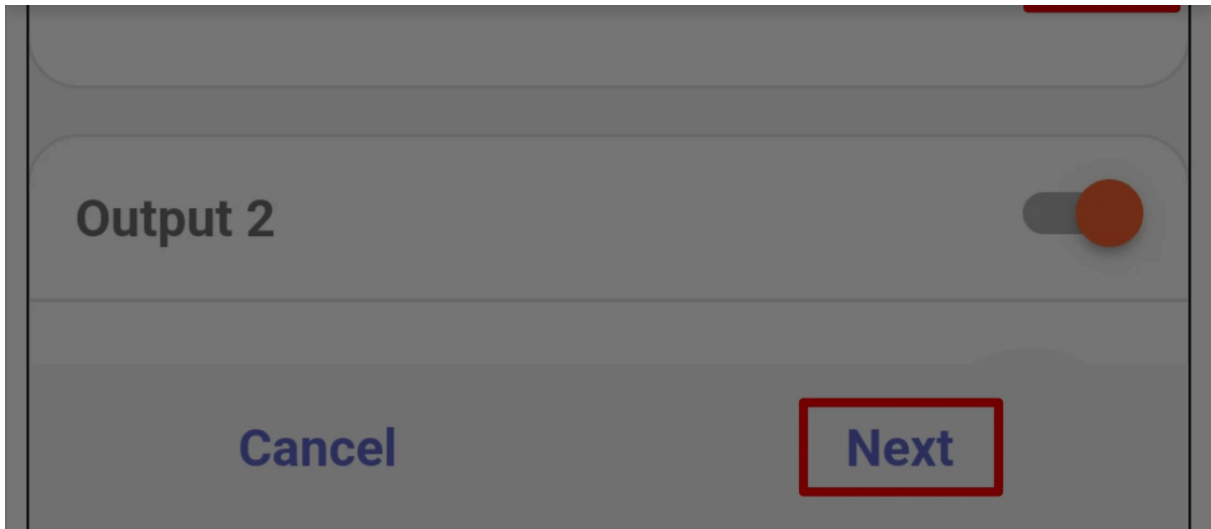

**Шаг 8.** Подождите, пока Protegus2 записывает данные.

### Cookie consent

We use cookies to measure the effectiveness of our documentation and whether users find what they're searching for. With your consent, you're helping us to make our documentation better.

Google Analytics



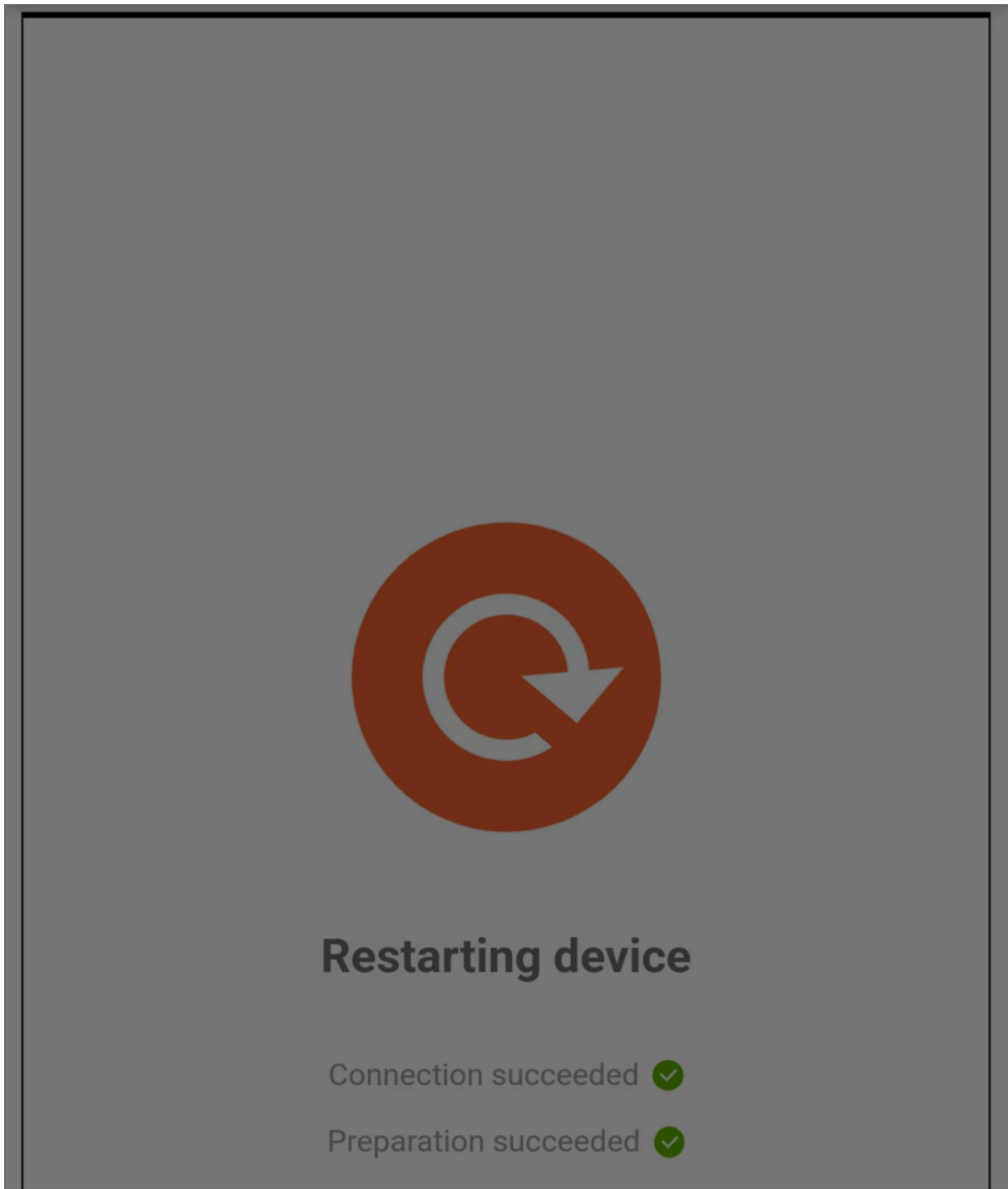

### Cookie consent

We use cookies to measure the effectiveness of our documentation and whether users find what they're searching for. With your consent, you're helping us to make our documentation better.

Google Analytics



Cancel

**Шаг 9.** Нажмите **Next**.

### Cookie consent

We use cookies to measure the effectiveness of our documentation and whether users find what they're searching for. With your consent, you're helping us to make our documentation better.

Google Analytics



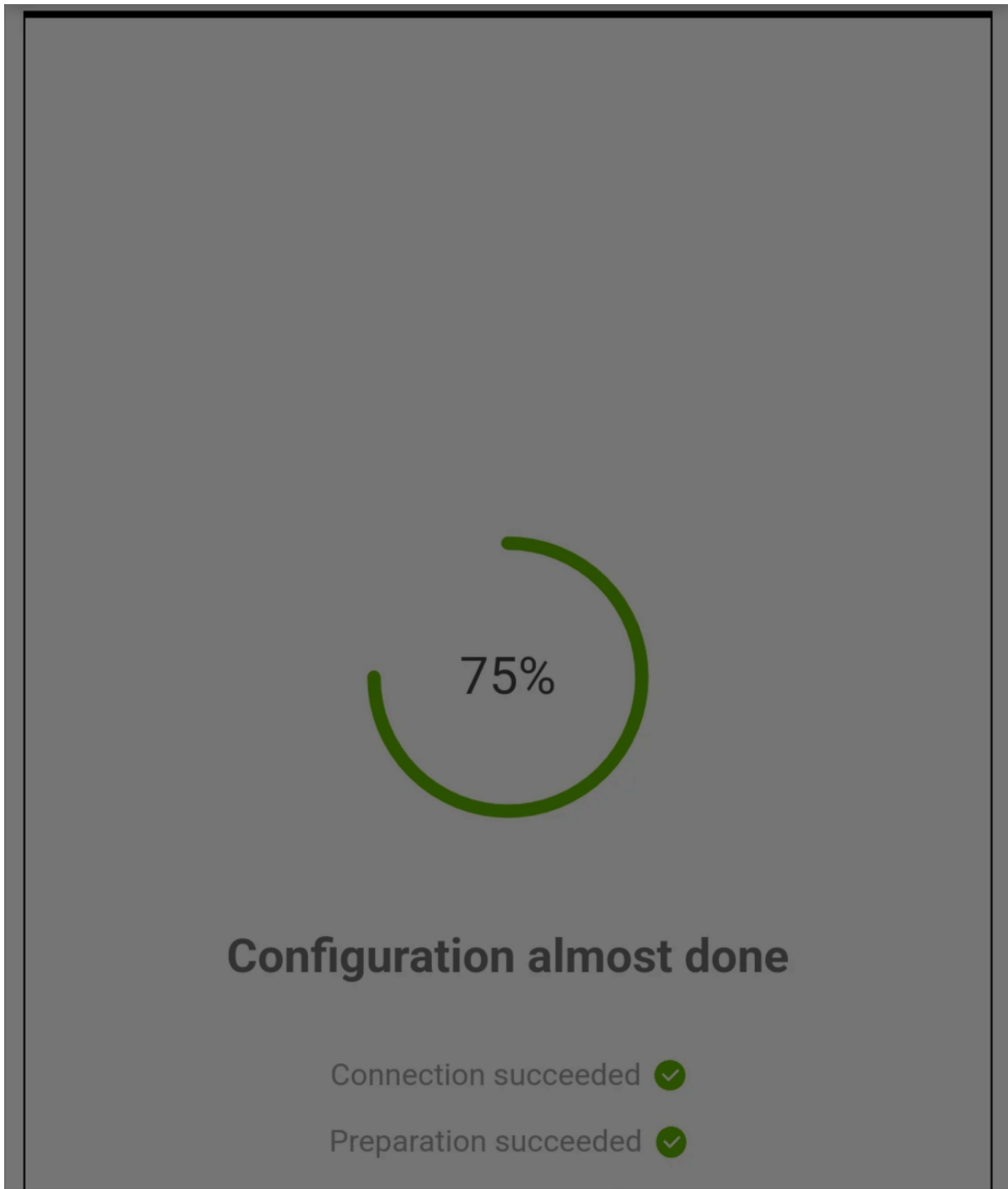

### Cookie consent

We use cookies to measure the effectiveness of our documentation and whether users find what they're searching for. With your consent, you're helping us to make our documentation better.

Google Analytics





Advanced settings

Next

**Шаг 10.** Введите **Name** системы, затем нажмите **Next**.

### Cookie consent

We use cookies to measure the effectiveness of our documentation and whether users find what they're searching for. With your consent, you're helping us to make our documentation better.

Google Analytics





## Add new system

Name  
**Gator**

Background 

Time zone  
Europe/Vilnius 

### Cookie consent

We use cookies to measure the effectiveness of our documentation and whether users find what they're searching for. With your consent, you're helping us to make our documentation better.

Google Analytics



**Шаг 11.** Нажмите **Skip**, если не хотите добавлять пользователей сейчас.

### Cookie consent

We use cookies to measure the effectiveness of our documentation and whether users find what they're searching for. With your consent, you're helping us to make our documentation better.

Google Analytics



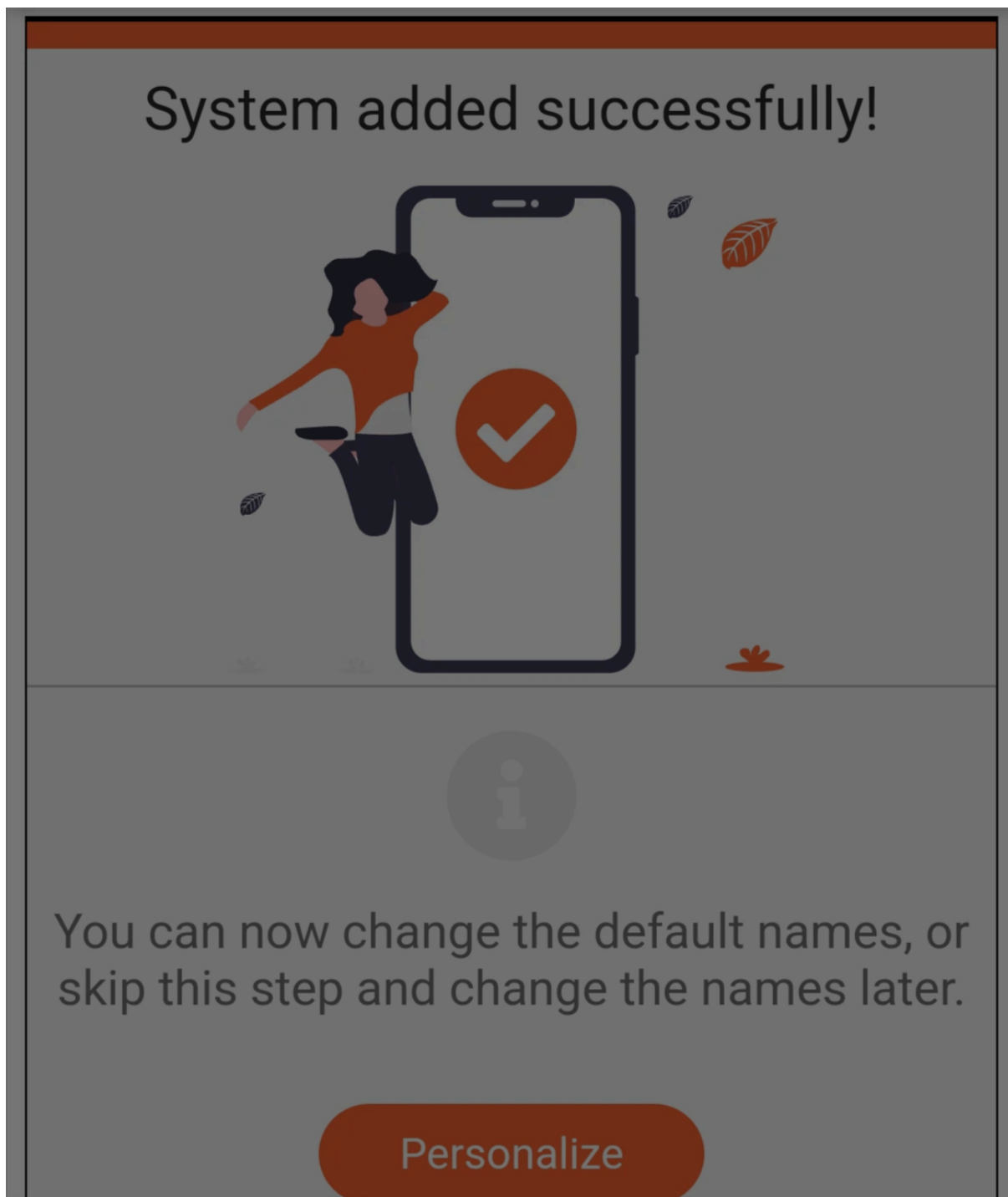

### Cookie consent

We use cookies to measure the effectiveness of our documentation and whether users find what they're searching for. With your consent, you're helping us to make our documentation better.

Google Analytics



Skip

**Шаг 12.** Подождите около 1 минуты до завершения.

### Cookie consent

We use cookies to measure the effectiveness of our documentation and whether users find what they're searching for. With your consent, you're helping us to make our documentation better.

Google Analytics



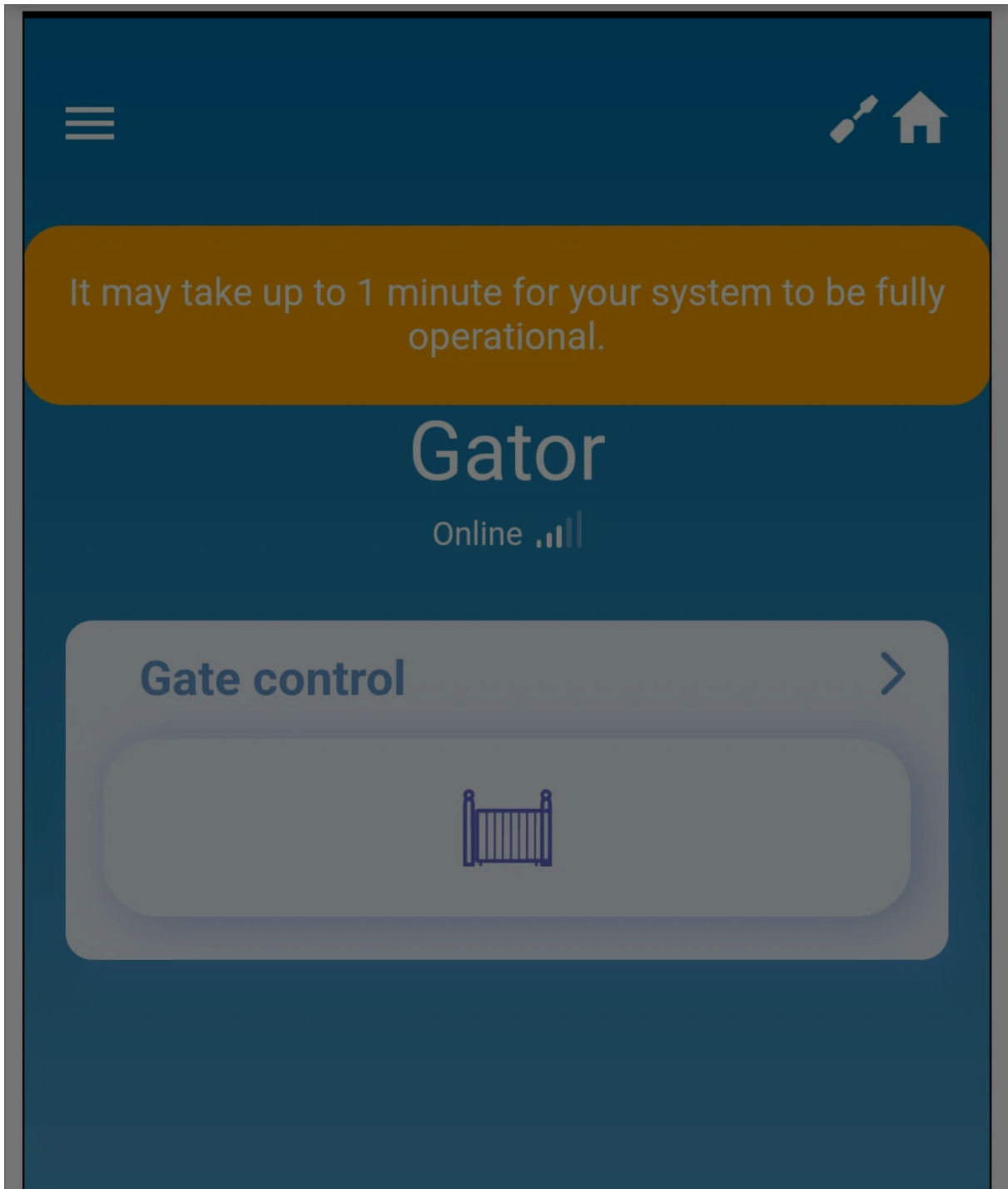

### Cookie consent

We use cookies to measure the effectiveness of our documentation and whether users find what they're searching for. With your consent, you're helping us to make our documentation better.

Google Analytics



## 4. Передача системы пользователю

После завершения настройки передайте систему в учетную запись Protegus2 пользователя.

**Шаг 13.** Нажмите **Menu**.

### Cookie consent

We use cookies to measure the effectiveness of our documentation and whether users find what they're searching for. With your consent, you're helping us to make our documentation better.

Google Analytics

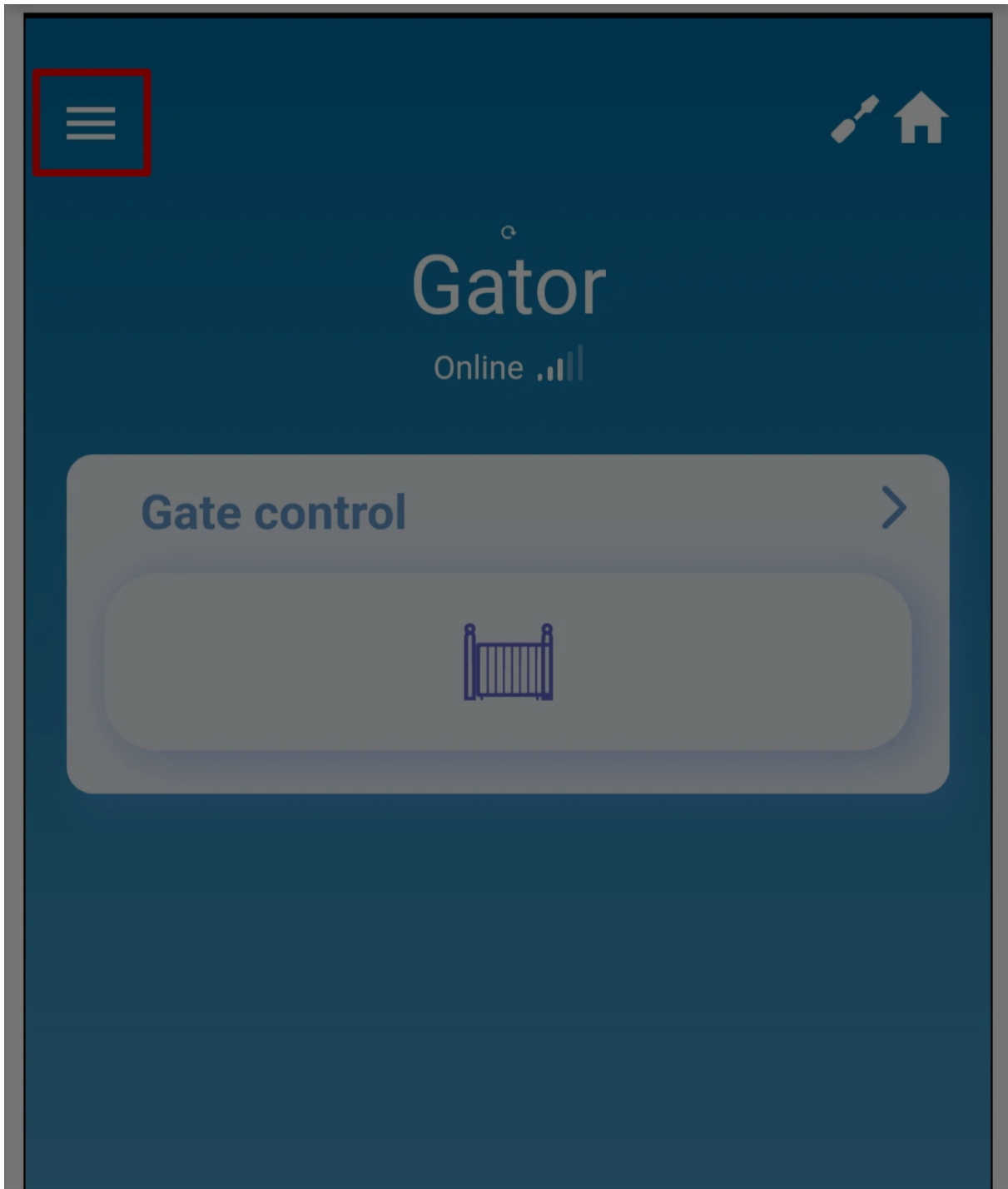

### Cookie consent

We use cookies to measure the effectiveness of our documentation and whether users find what they're searching for. With your consent, you're helping us to make our documentation better.

Google Analytics





**Шаг 14.** Нажмите **Settings**.

### Cookie consent

We use cookies to measure the effectiveness of our documentation and whether users find what they're searching for. With your consent, you're helping us to make our documentation better.

Google Analytics



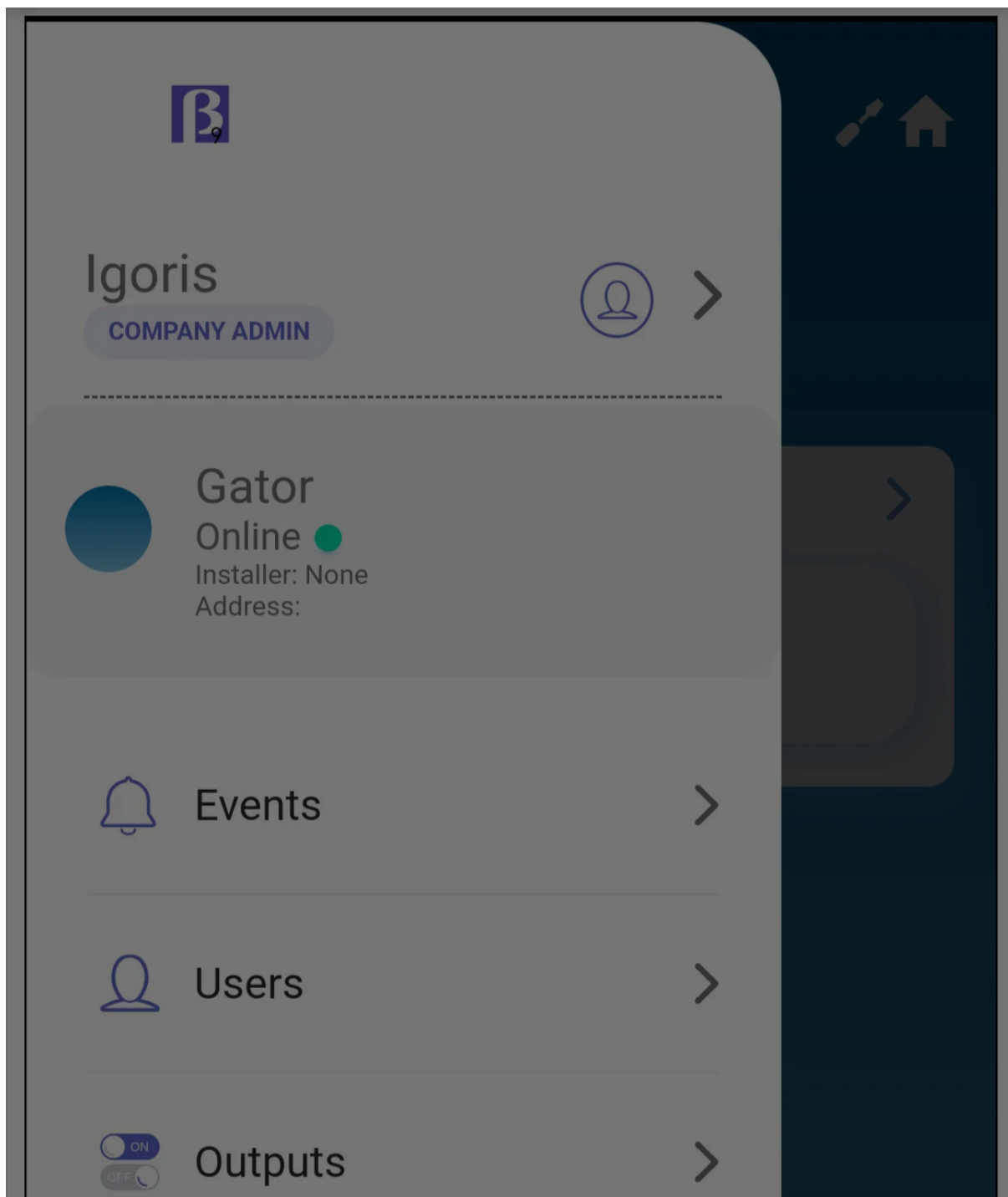

### Cookie consent

We use cookies to measure the effectiveness of our documentation and whether users find what they're searching for. With your consent, you're helping us to make our documentation better.

Google Analytics



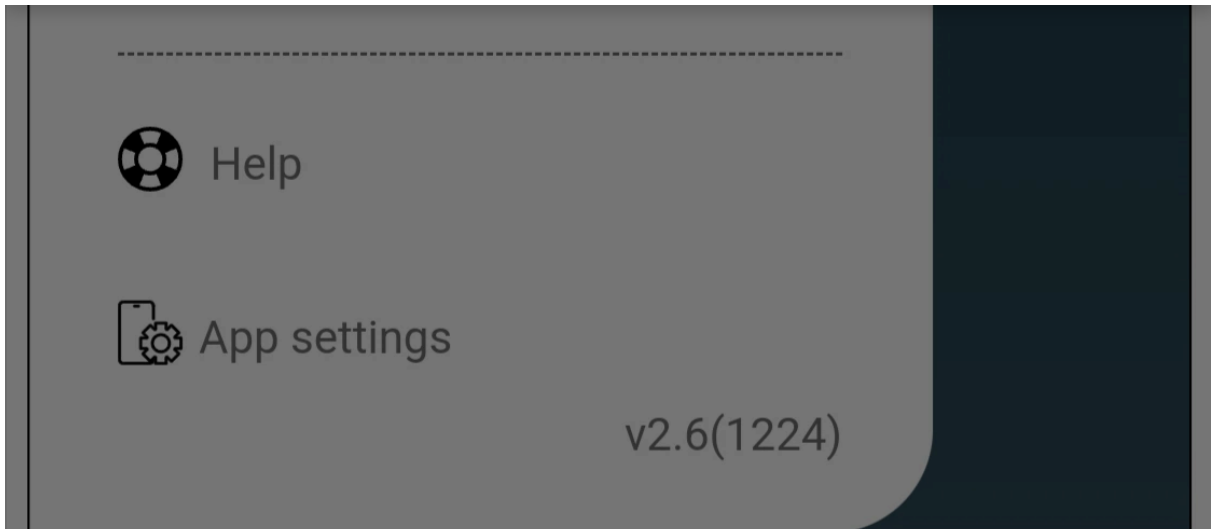

**Шаг 15.** Нажмите **Transfer system**.

### Cookie consent

We use cookies to measure the effectiveness of our documentation and whether users find what they're searching for. With your consent, you're helping us to make our documentation better.

Google Analytics



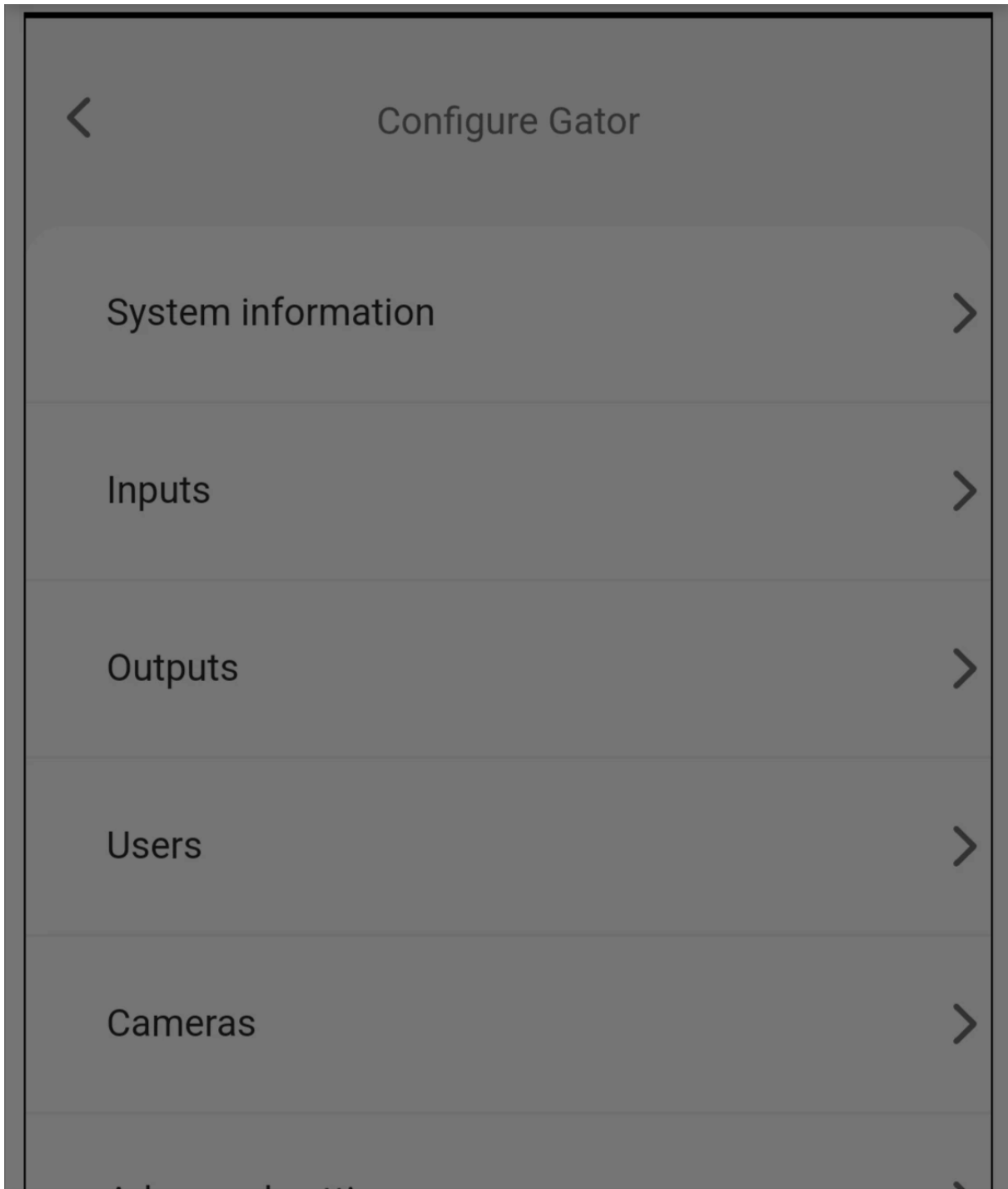

### Cookie consent

We use cookies to measure the effectiveness of our documentation and whether users find what they're searching for. With your consent, you're helping us to make our documentation better.

Google Analytics



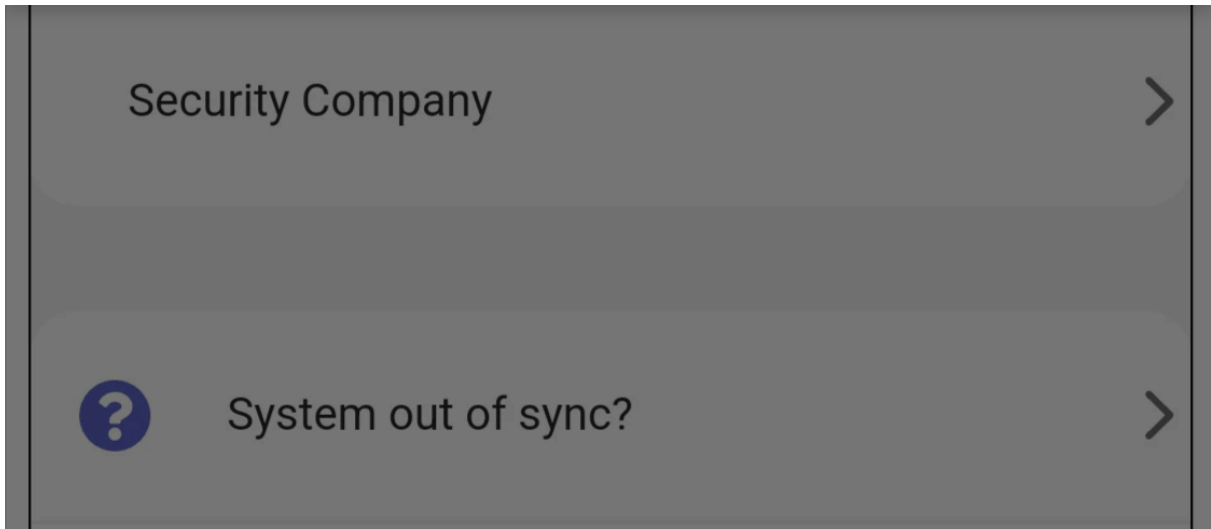

**Шаг 16.** Введите адрес электронной почты пользователя, затем нажмите **Transfer**.

### Cookie consent

We use cookies to measure the effectiveness of our documentation and whether users find what they're searching for. With your consent, you're helping us to make our documentation better.

Google Analytics



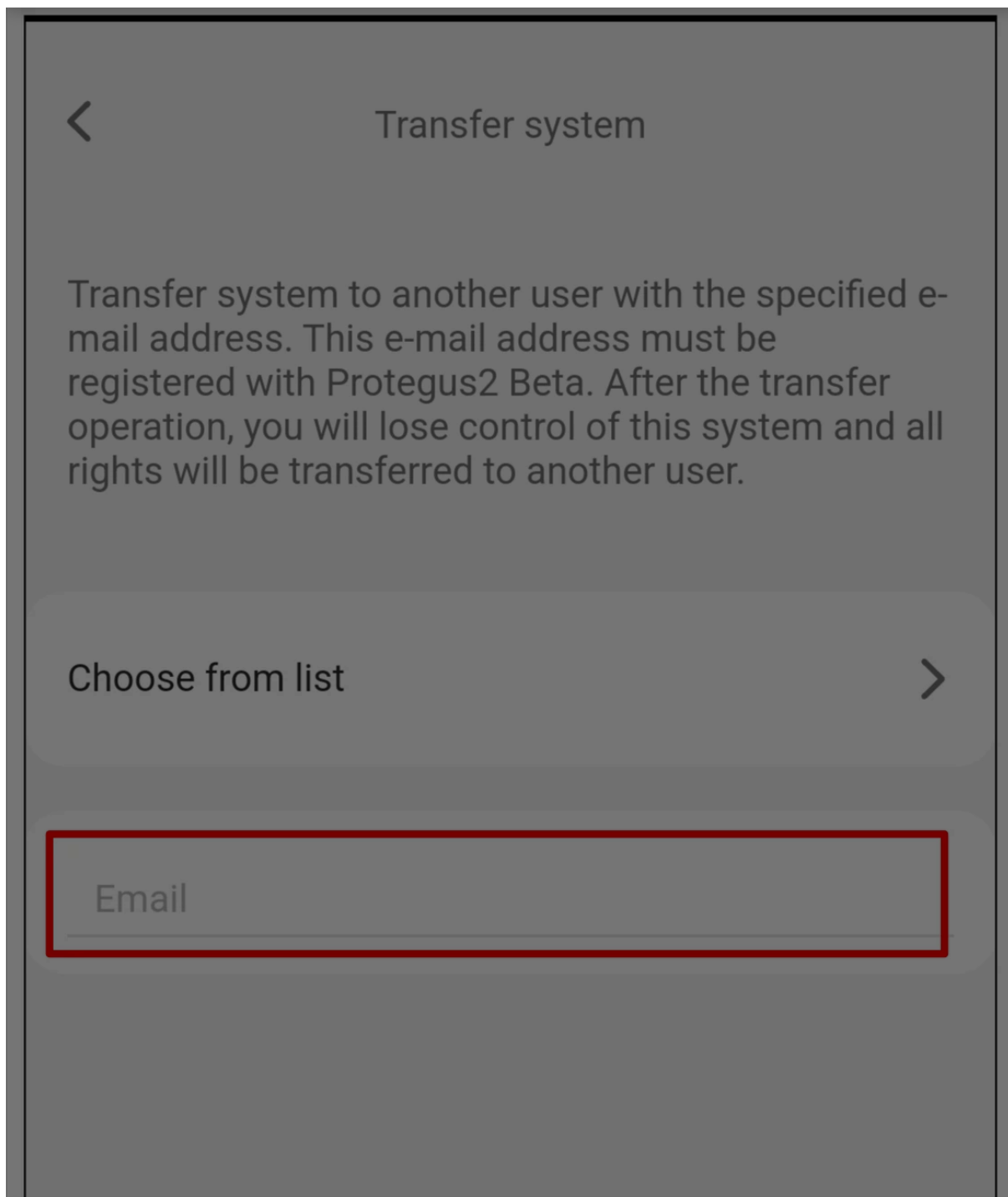

### Cookie consent

We use cookies to measure the effectiveness of our documentation and whether users find what they're searching for. With your consent, you're helping us to make our documentation better.

Google Analytics





## 5. Проверка мониторинга и управления воротами

После передачи пользователь должен войти в Protegus2 со своей учетной записью.

### ПРЕДУПРЕЖДЕНИЕ

Обход датчика безопасности ворот может отключить защитную функцию. Используйте обход только как временное и уполномоченное сервисное действие, а перед вводом установки в эксплуатацию восстановите нормальную работу датчика.

**Transfer**

**Шаг 17.** Нажмите **Gate control**, чтобы увидеть счетчик циклов ворот.

### Cookie consent

We use cookies to measure the effectiveness of our documentation and whether users find what they're searching for. With your consent, you're helping us to make our documentation better.

Google Analytics

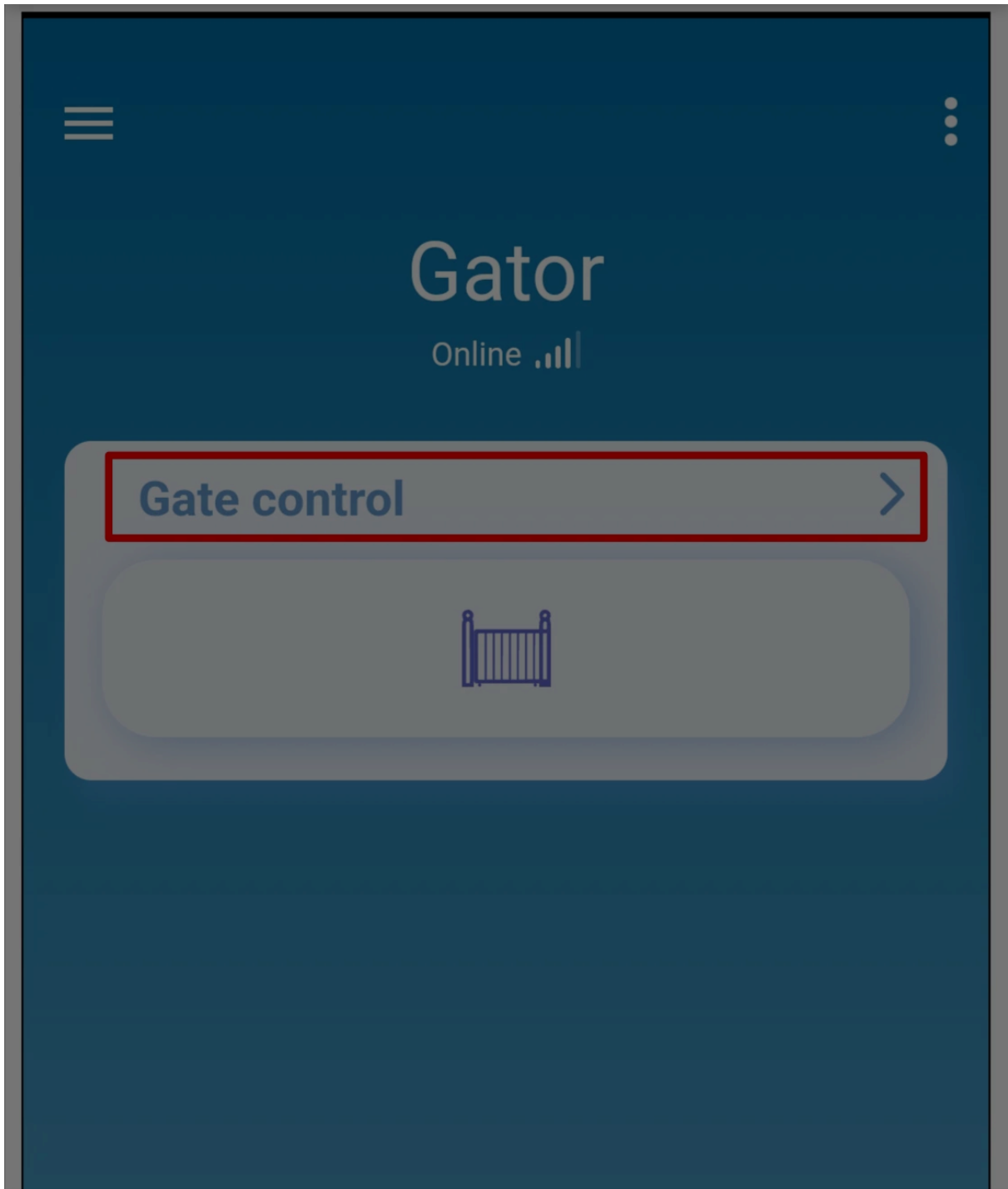

### Cookie consent

We use cookies to measure the effectiveness of our documentation and whether users find what they're searching for. With your consent, you're helping us to make our documentation better.

Google Analytics





**Шаг 18.** Проверьте **Total cycles** и **Cycles to maintenance**. Если уполномоченному установщику нужно проверить состояние датчиков безопасности, нажмите **Input status**.

### Cookie consent

We use cookies to measure the effectiveness of our documentation and whether users find what they're searching for. With your consent, you're helping us to make our documentation better.

Google Analytics



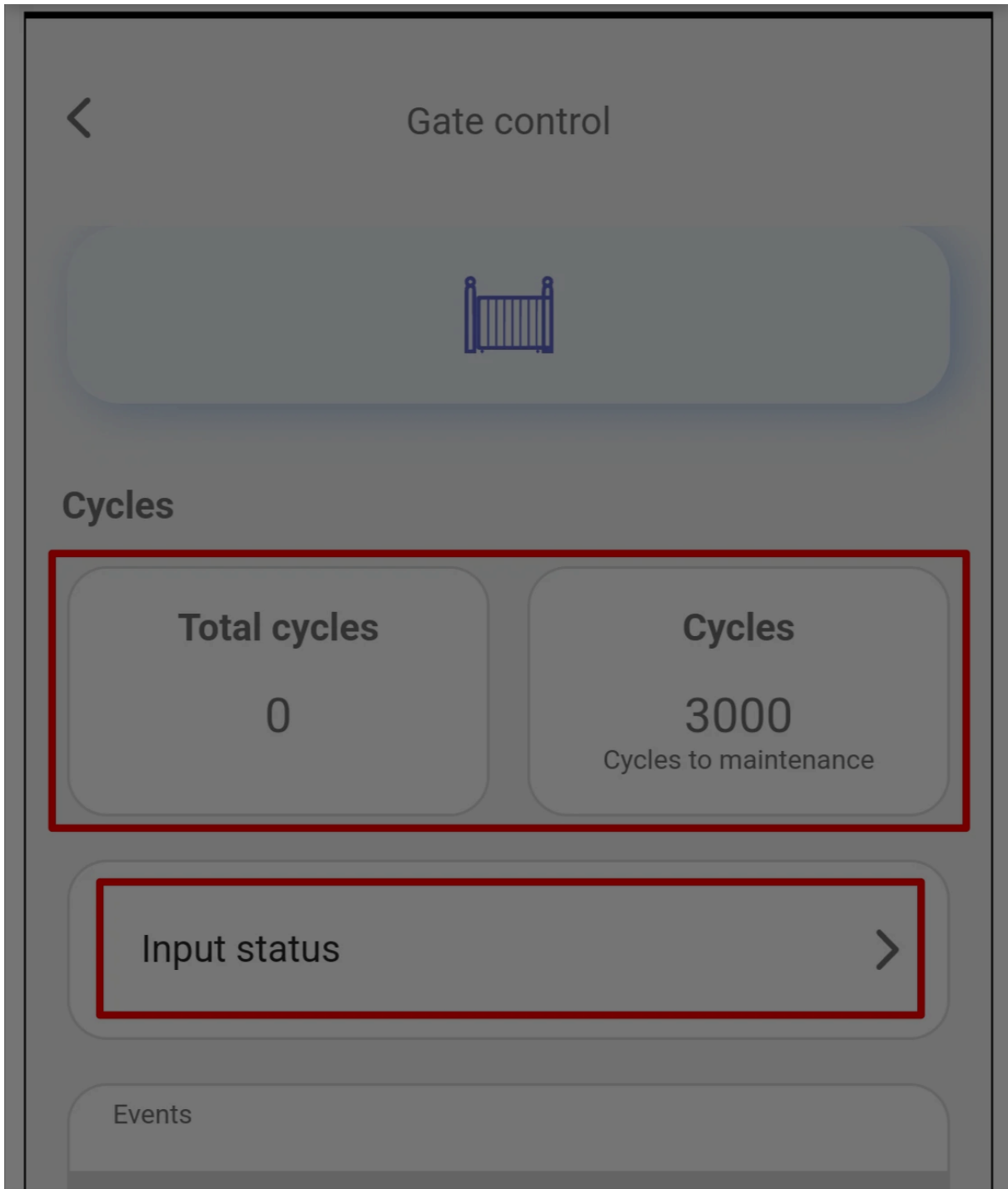

### Cookie consent

We use cookies to measure the effectiveness of our documentation and whether users find what they're searching for. With your consent, you're helping us to make our documentation better.

Google Analytics



**Шаг 19.** Используйте **Input status / bypass** только когда датчик безопасности проверен и временный обход действительно необходим.

### Cookie consent

We use cookies to measure the effectiveness of our documentation and whether users find what they're searching for. With your consent, you're helping us to make our documentation better.

Google Analytics



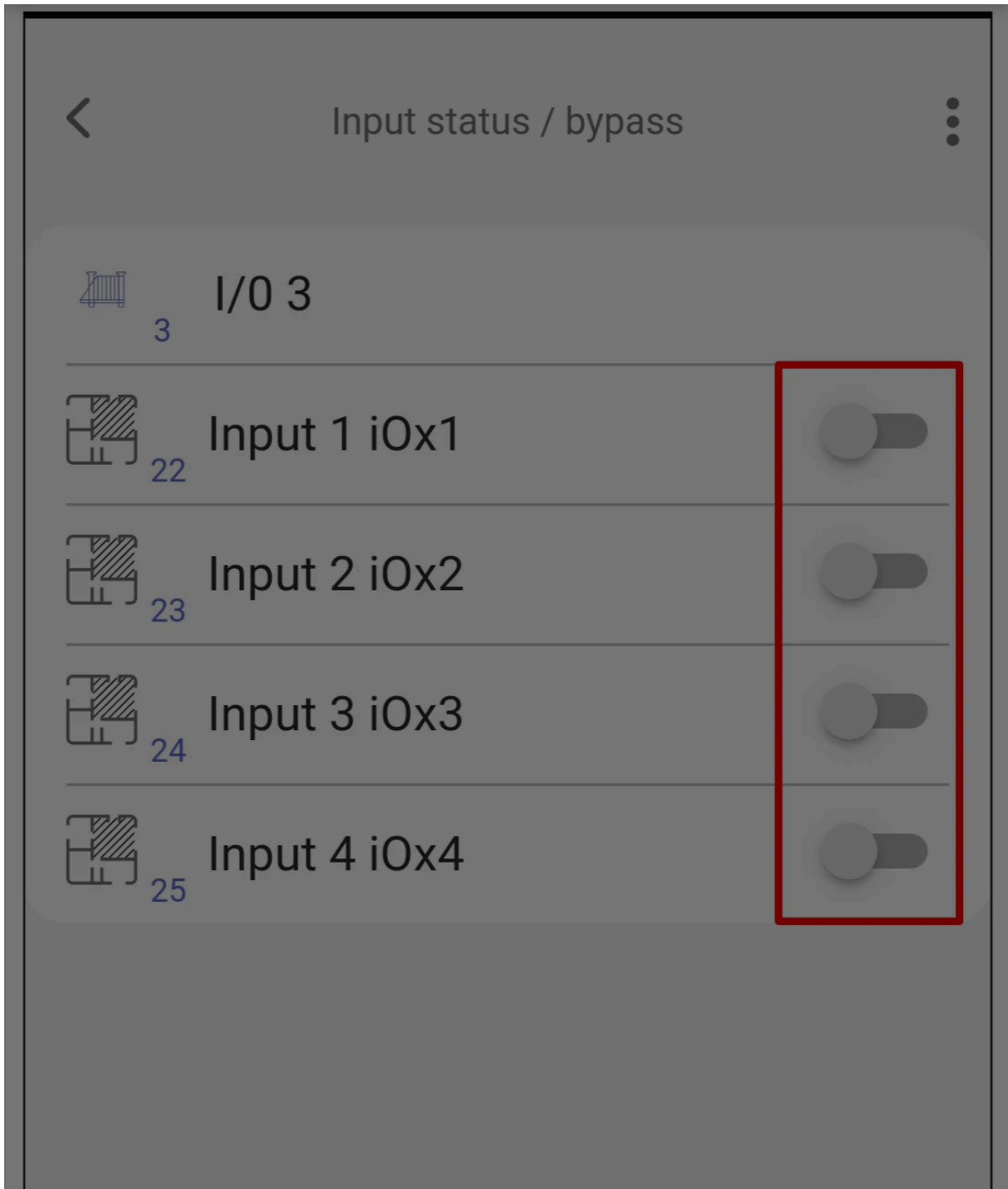

### Cookie consent

We use cookies to measure the effectiveness of our documentation and whether users find what they're searching for. With your consent, you're helping us to make our documentation better.

Google Analytics



**Шаг 20.** Нажмите иконку управления воротами, чтобы открыть ворота.

### Cookie consent

We use cookies to measure the effectiveness of our documentation and whether users find what they're searching for. With your consent, you're helping us to make our documentation better.

Google Analytics



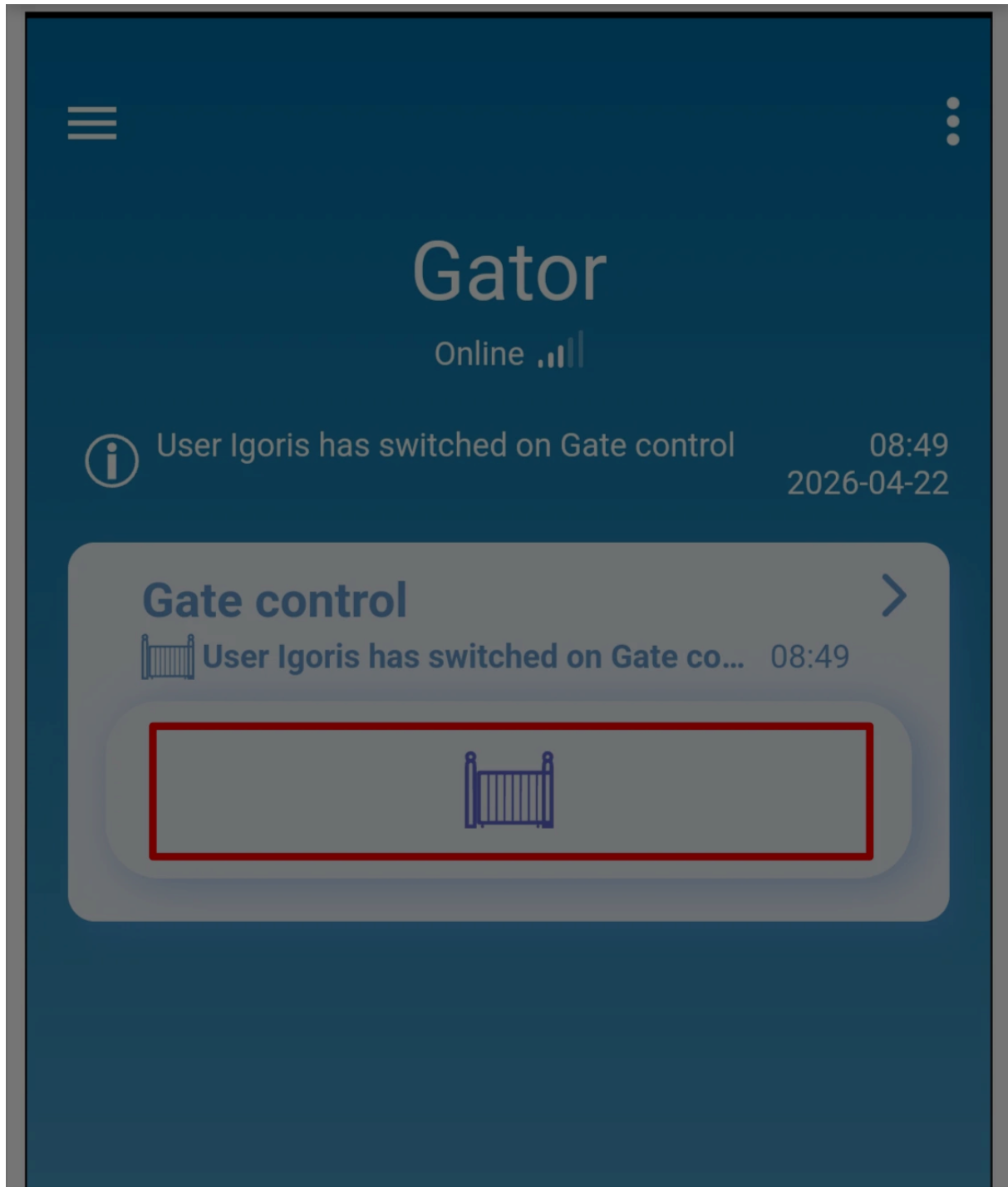

### Cookie consent

We use cookies to measure the effectiveness of our documentation and whether users find what they're searching for. With your consent, you're helping us to make our documentation better.

Google Analytics





## 6. Проверка системы

1. Полностью откройте и закройте ворота, затем убедитесь, что счетчик циклов изменился ожидаемым образом.
2. Активируйте каждый контролируемый вход iO4R и убедитесь, что состояние входа изменяется в Protegus2.
3. Проверьте иконку управления воротами и убедитесь, что автоматика ворот реагирует правильно.

### Cookie consent

We use cookies to measure the effectiveness of our documentation and whether users find what they're searching for. With your consent, you're helping us to make our documentation better.

Google Analytics

